

Before start ,please carefully read the explanations!

Stinson 108



Specification:

Length	:1689 mm(66.5")
Wing Span	:2311 mm(91")
Wing Area	:72sq.dm 7.7sq.ft
Wing Loading	:81.9g/sq.dm 26.9oz/sq.ft
Flying Weight	:5.9kg(13.1lbs)
Radio	:6ch & 8servos
Engine:	:26cc-30cc

INSTRUCTION MANUAL



SAFETY PRECAUTIONS

This R/C airplane is not a toy!

(The people under 18 years old is forbidden from flying this model)

First-time builders should seek advice from people having building experience.If misused or abused,it can cause serious bodily injury and damage to property.

Fly only in open areas and preferably at a dedicated R/C flying site. We suggest having a qualified instructor carefully inspect your airplane before its first flight.Please carefully read and follow all instructions included with this airplane,your radio control system and any other components purchased separately.

REQUIRED FOR OPERATION (Purchase separately!)

CAUTION: For details concerning the equipment listed below (size, maker, etc.), check with your hobby shop.

1 A minimum 6 channel radio for airplanes (with 8 servos), and dry batteries.

CAUTION: Only use a minimum 6 channel radio for airplanes! (No other radio may be used!)
6 channel radio for airplane is highly recommended for this model.

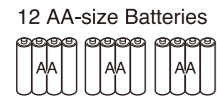

A minimum 6 channel transmitter for airplanes.



For handling the radio properly, refer to its instruction manual.

2 Engine and Muffler
Model Airplane Engine: 4-cycle .120

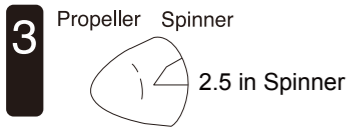
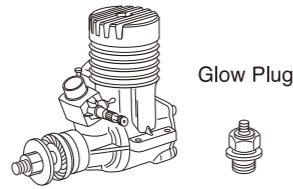

Purchase a propeller that will match your engine.

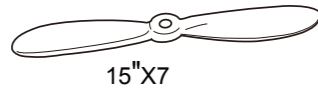

5 Required for engine starting: Glow engine fuel only.

WARNING: Normal gasoline cannot be used with glow engines.

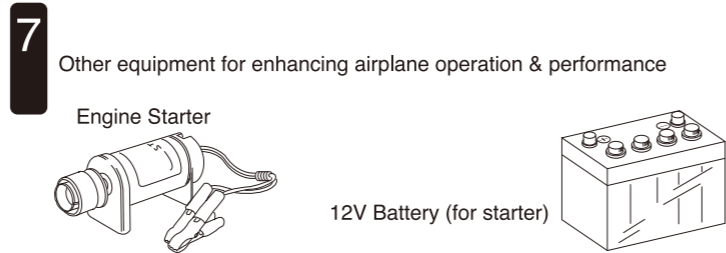
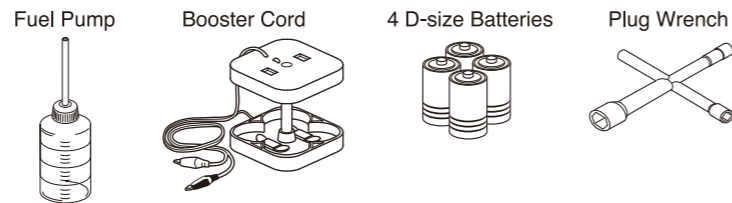
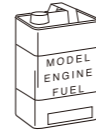

TOOLS REQUIRED (Purchase separately!)

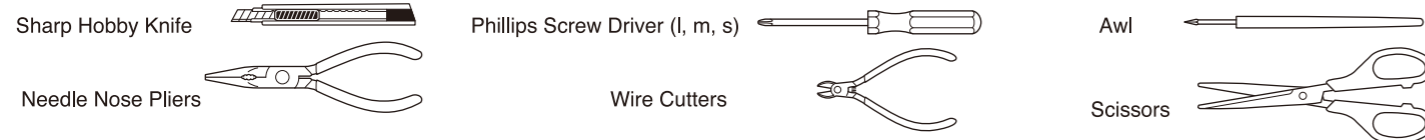

BEFORE YOU BEGIN

1 Read through the manual before you begin, so you will have an overall idea of what to do.

2 Check all parts. If you find any defective or missing parts, contact your local dealer.

3 Symbols used throughout this instruction manual, comprise:

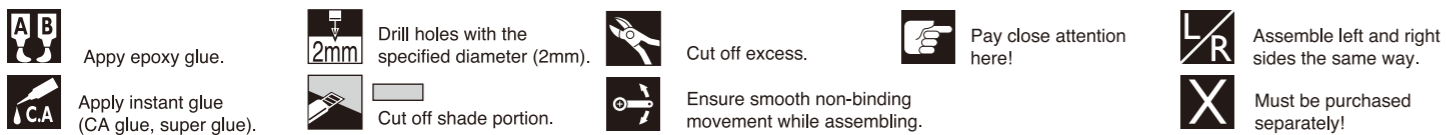

Do not overlook this Symbol!
Warning!

Warning
Remove the covering with proper pressure to cut through only the covering itself. Otherwise, cutting down into the balsa structure may weaken the model part and cause accident.

The pre-covered film on ARF kits may wrinkle due to variations of temperature. Smooth out as explained right.

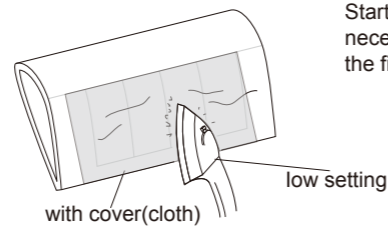

► Pre-cover the covering with clean cloth!
Start at low setting. Increase the setting if necessary. If it is too high, you may damage the film.

59 Assemble the door window with instant style glue.

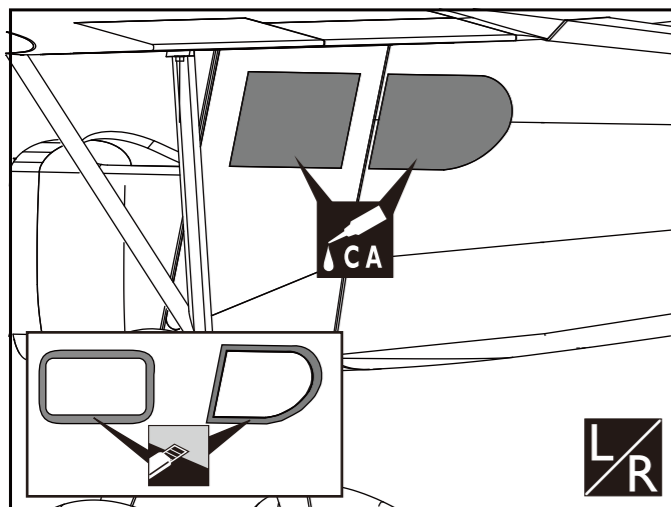

62 Adjustment of the rudder, be sure it can work perfectly.

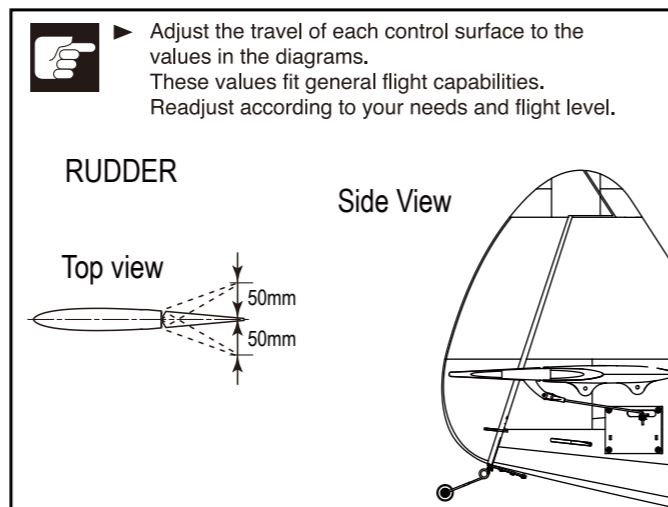

60 Trim the surplus parts of the windshield and assemble it to the fuselage with screws.

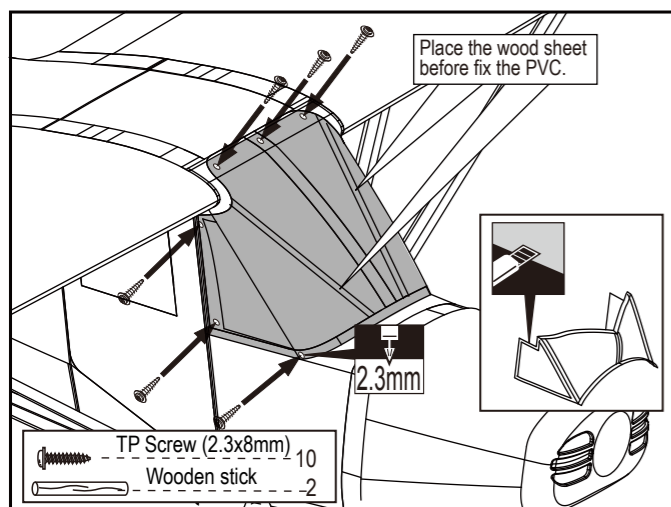

63 Adjustment of the elevator, be sure it can work perfectly.

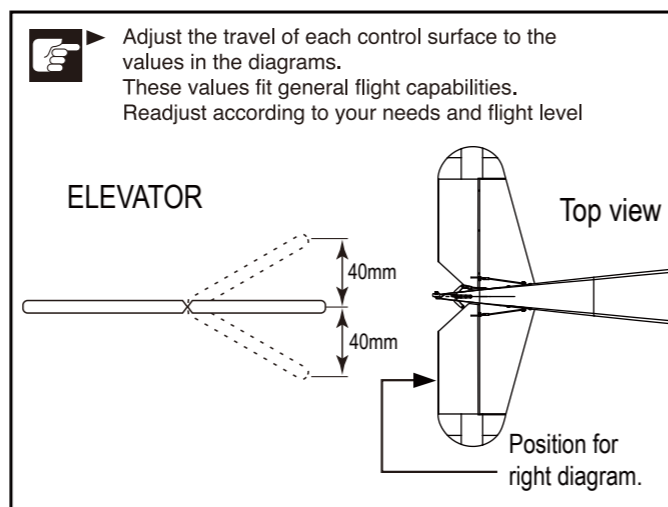

61 Adjustment of the aileron and flap, be sure they can work perfectly.

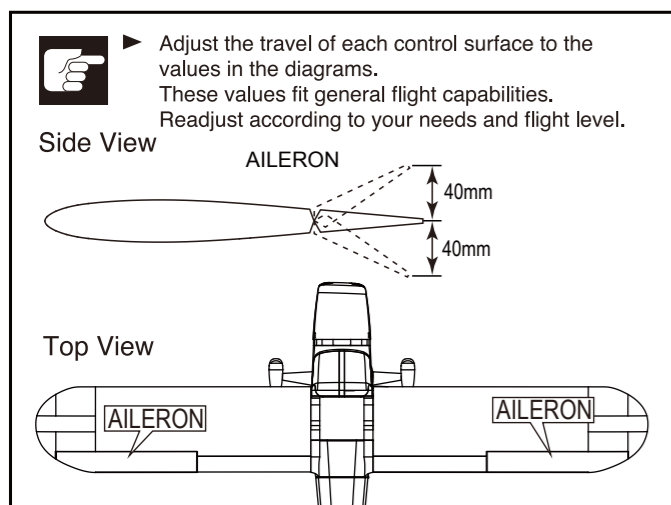

64 Centre of the Gravity.

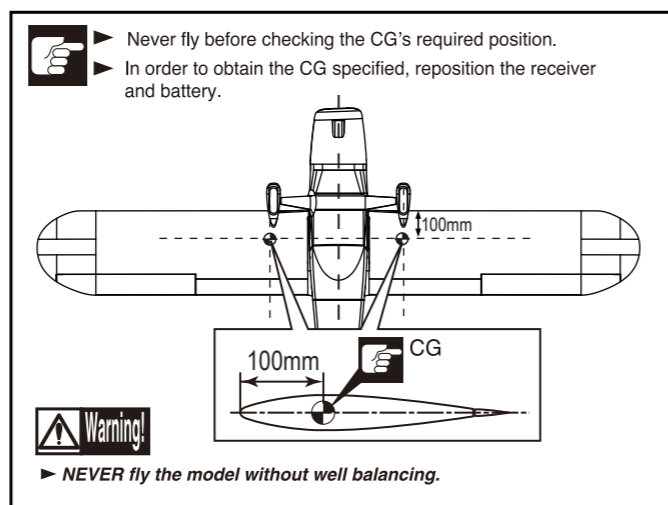

Warning! Accessory list for the coming installation steps.

	Rod (2.5x300mm)	2
	TP Screw (2.3x12mm)	8
	Servo tray(70x58x2mm)	2
	Pivot&round hinge(4.5X67mm)	6
	Collar (2.5mm)	2
	Screw (3x15mm)	2
	Nut (3mm)	2
	Clevis	2
	Aluminum Washer (3x8mm)	2
	Control horn	2

3 Apply instant type AB glue to appropriate position in the trailing edge and assemble the ailerons to them.

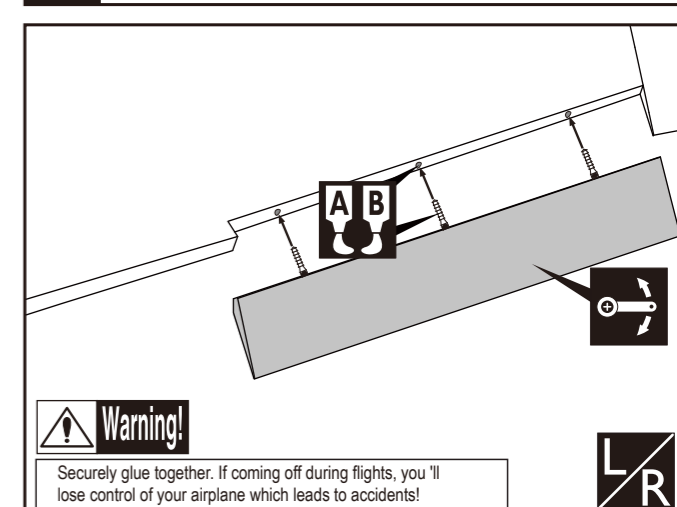

1 Apply instant type AB glue to appropriate position of the aileron and pivot & round hinges. Insert the pivot & round hinges to the ailerons.

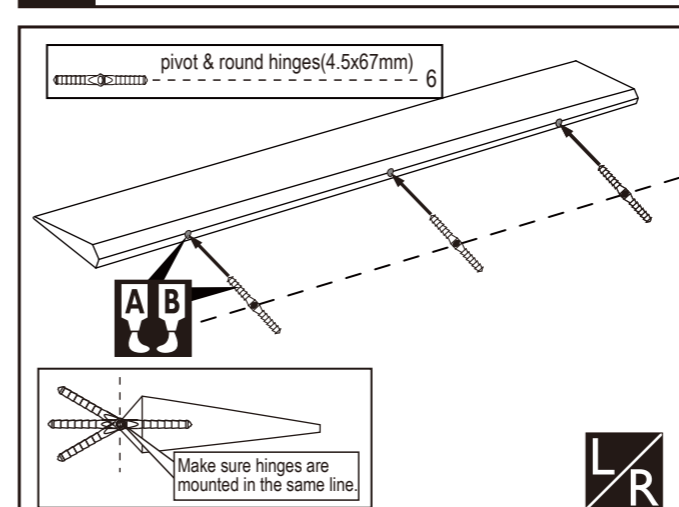

4 Install the aileron servo to the servo mount as illustration below.

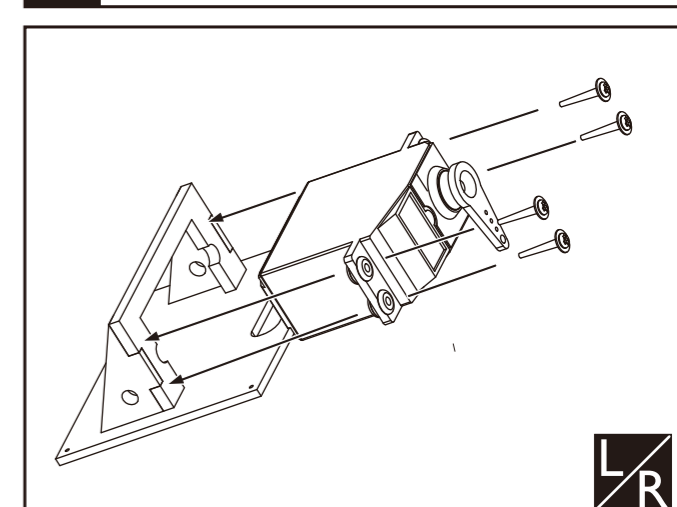

2 Keep about 1mm width space between the aileron and the trailing edge.

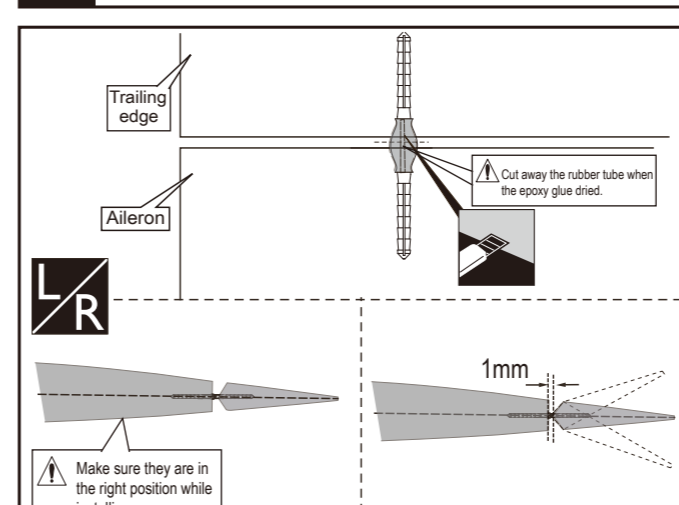

5 Install the control horn and connect the linkage.

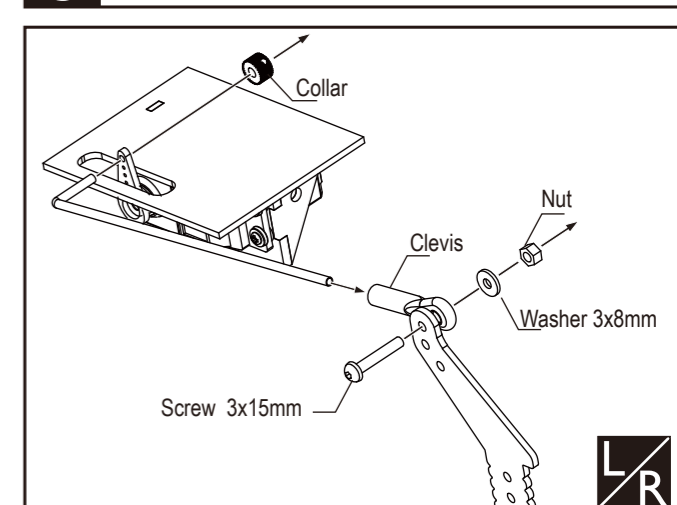

AB Apply epoxy glue. **L/R** Assemble left and right sides the same way. **Hand icon** Pay close attention here! **Warning!** Do not overlook this symbol!

CA Apply instant glue (CA glue, super glue). **Hand icon** Ensure smooth non-binding movement while assembling. **Scissors icon** Cut off shaded portion.

AB Apply epoxy glue. **L/R** Assemble left and right sides the same way. **Hand icon** Pay close attention here! **Warning!** Do not overlook this symbol!

CA Apply instant glue (CA glue, super glue). **Hand icon** Ensure smooth non-binding movement while assembling. **Scissors icon** Cut off shaded portion.

6 Apply instant type AB glue to the control horn and the slots in the aileron, insert the control horn to the slots as illustration.

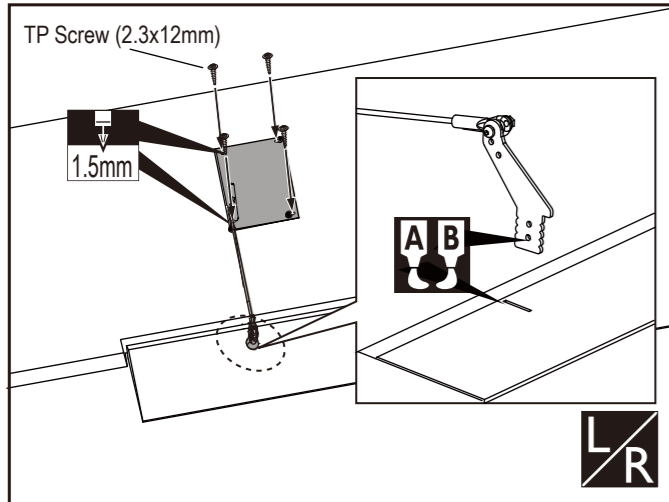

8 Keep about 1mm width space between trailing edge and flap.

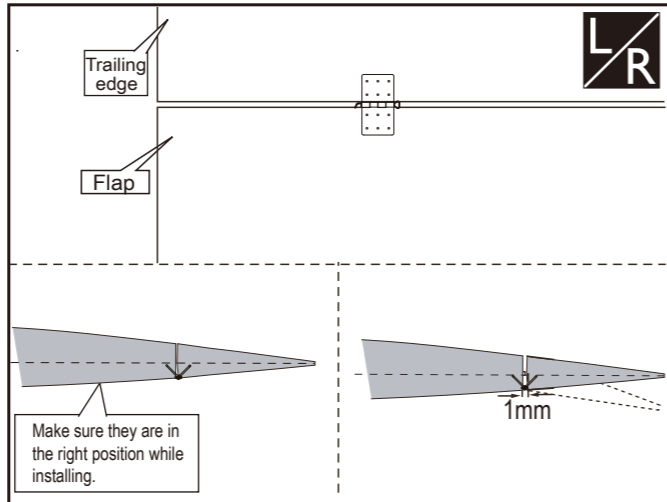

54 Assemble the landing gears cover to the fuselage with TP screws.

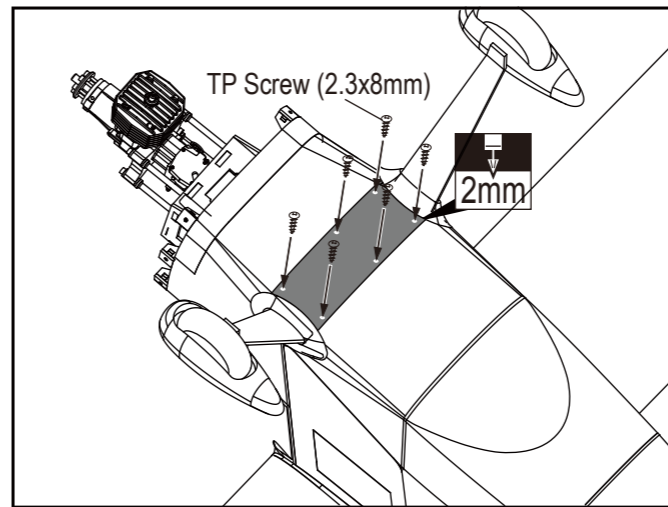

56 Assemble the cowling carefully to the head of fuselage with TP screws.

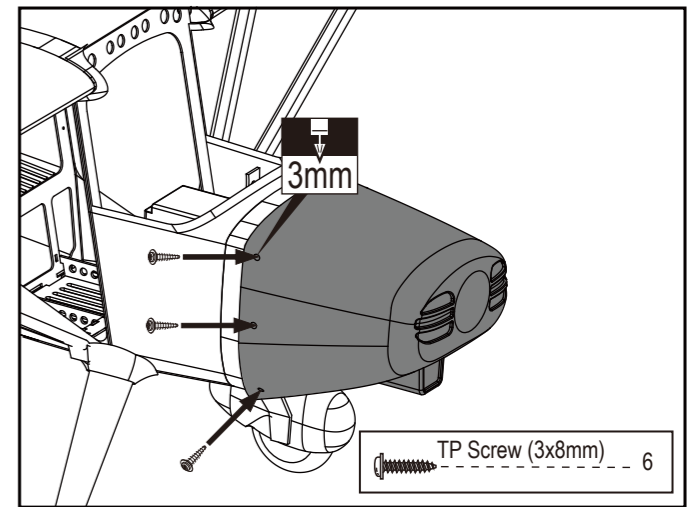

Warning! Accessory list for the coming installation steps.

- Rod (2.5x300mm) ----- 2
- TP Screw (2.3x12mm) ----- 8
- Servo tray(70x58x2mm) ----- 2
- Pin hinge(24x24mm) ----- 6
- Collar (2.5mm) ----- 2
- Screw (3x15mm) ----- 2
- Nut (3mm) ----- 2
- Clevis ----- 2
- Aluminum Washer (3x8mm) ----- 2
- Control horn ----- 2

9 Epoxy the flaps to the wings as illustration.

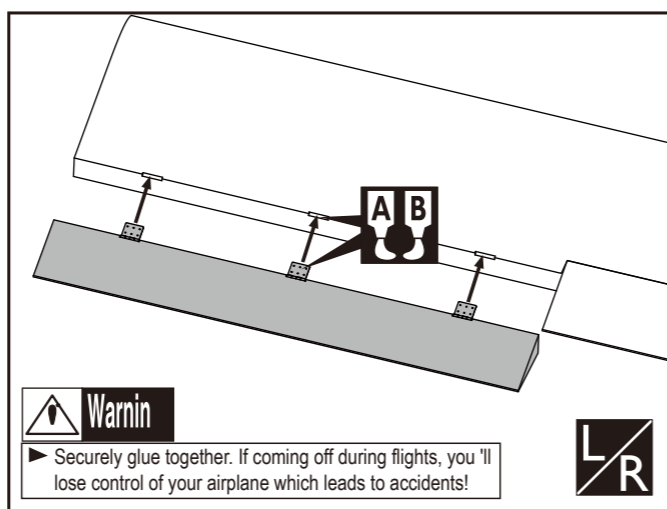

55 Fix the wing struts to the fuselage and wings via Alu localizers & screws.

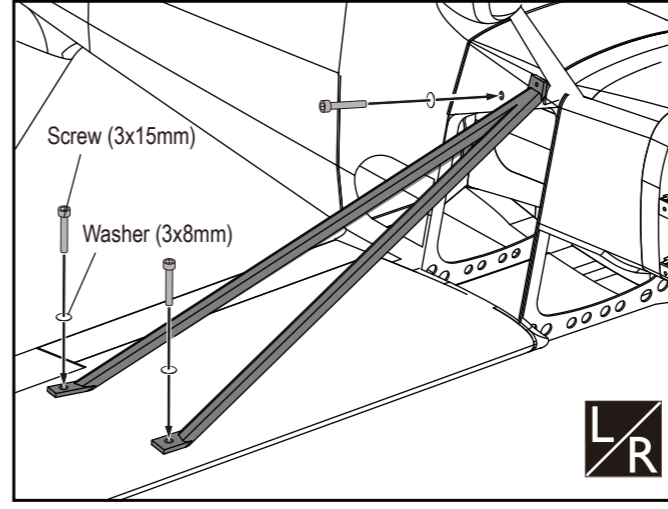

57 Epoxy the pinned hinges and thimble to appropriate position in the door.

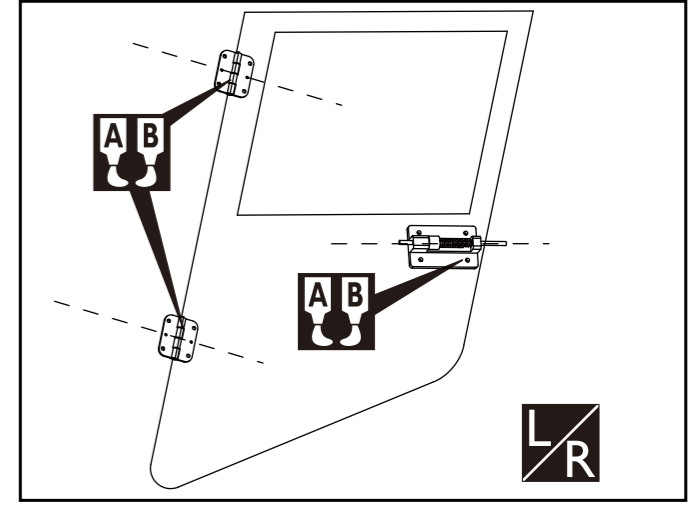

7 Epoxy the pin hinges to the flap.

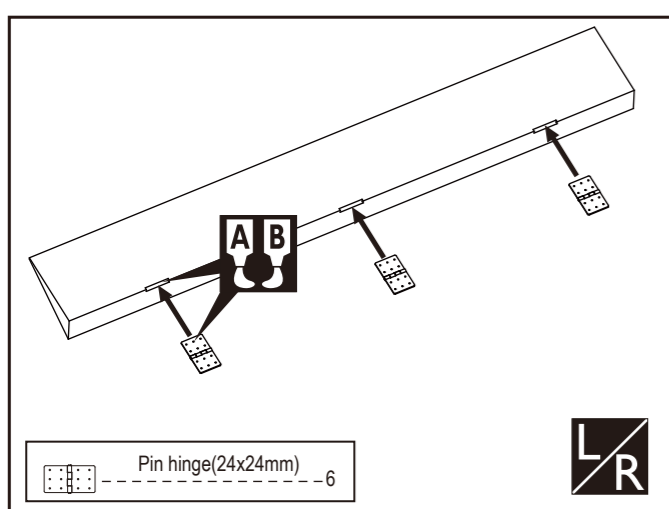

10 Install the flap servo to the servo mount as illustration below.

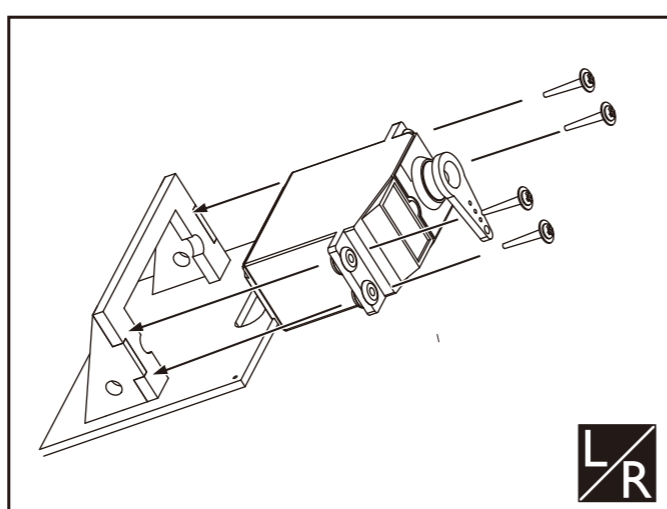

Warning! Accessory list for the coming installation steps.

- Pvc ----- 2
- Pvc ----- 2
- Pvc ----- 1
- Screw (3x8mm) ----- 6
- TP Screw (2.3x8mm) ----- 10
- Thimble ----- 2
- Pin hinge(36x20x1mm) ----- 4
- Wooden stick ----- 2

58 Epoxy the door to the fuselage.

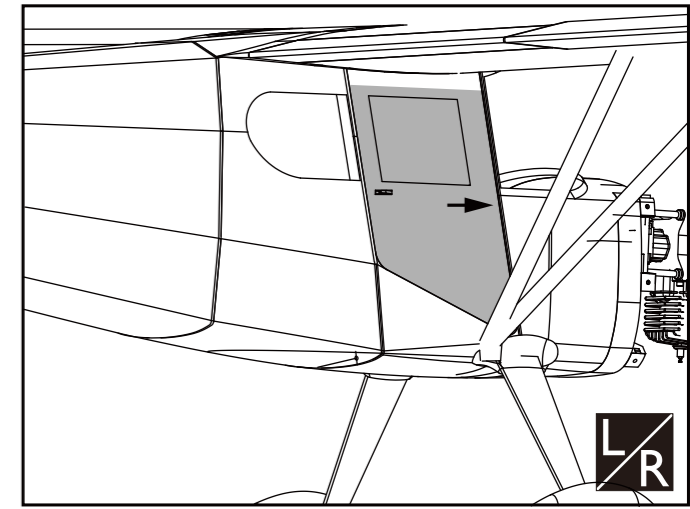

AB Apply epoxy glue. **LR** Assemble left and right sides the same way. **Hand icon** Pay close attention here! **Warning!** Do not overlook this symbol!

CA Apply instant glue (CA glue, super glue). **Arrow icon** Ensure smooth non-binding movement while assembling. **Scissors icon** Cut off shaded portion.

AB Apply epoxy glue. **LR** Assemble left and right sides the same way. **Hand icon** Pay close attention here! **Warning!** Do not overlook this symbol!

CA Apply instant glue (CA glue, super glue). **Arrow icon** Ensure smooth non-binding movement while assembling. **Scissors icon** Cut off shaded portion.

! Accessory list for the coming installation steps.

	Nut(5mm)	2		Washer (5x12mm)	4
	Main landing gear	2		TP Screw (2.3x8mm)	6
	Blind Nut (5mm)	2		Screw (5x35mm)	2
	LockNut (5mm)	2		PVC	2
	Screw (3x15mm)	6		Screw (4x15mm)	5
	Washer (3x8mm)	8		PVC	2
	Wheel (115 mm)	2		Screw (3x25mm)	2
	Double-sided adhesive	1		Washer (4x12mm)	5

51 Drill holes to appropriate position in the wheel pants, fixing the wheel pants to the landing gear with screws.

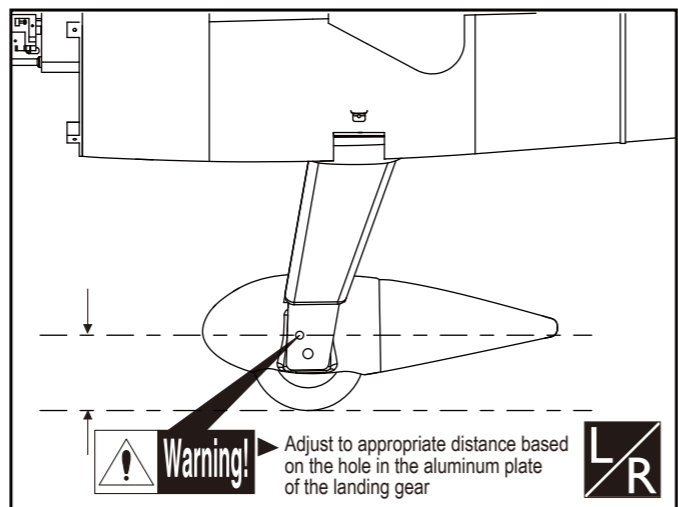

49 Install the wheels to the undercarriage.

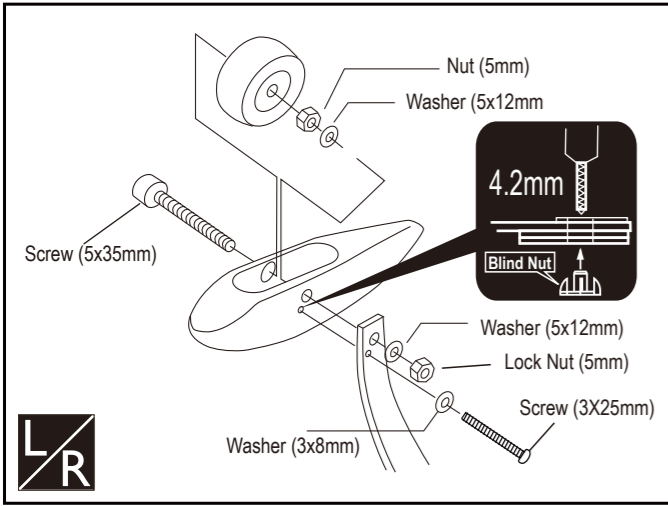

52 Trim the PVC parts along the shaded line.

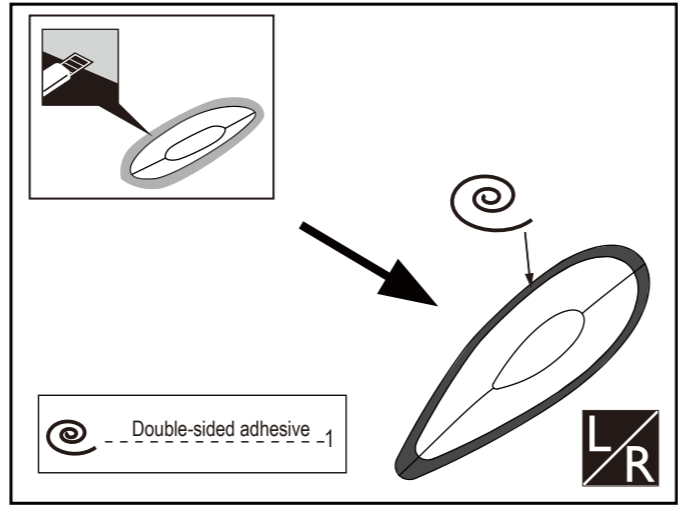

50 The sketch map when the wheels and wheel pants install completely.

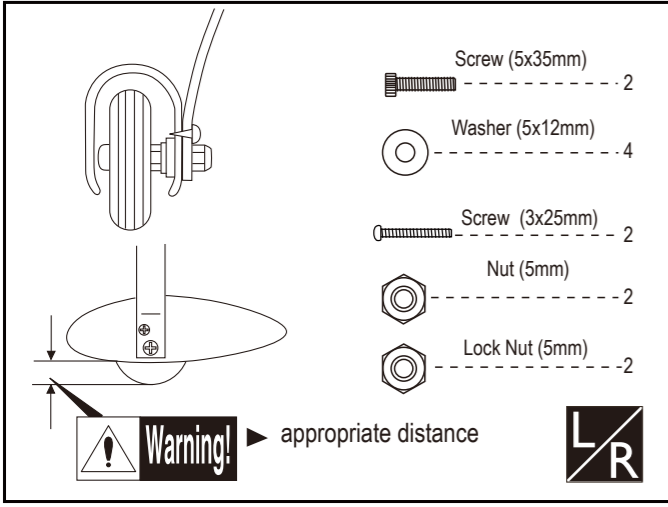

53 Assemble the landing gears to the fuselage with screws as illustration.

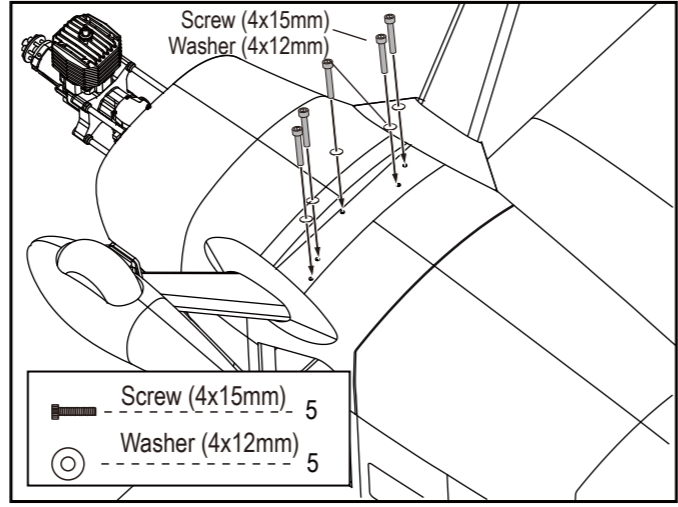

11 Install the control horn and connect the linkage.

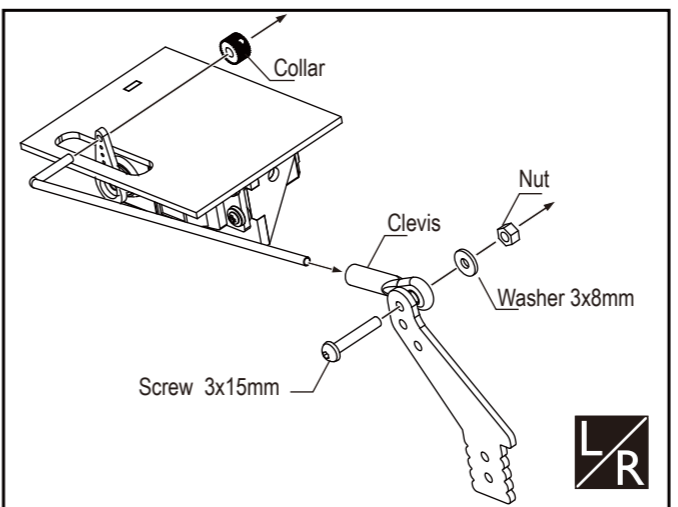

13 The standard sketch map when the kit install completion.

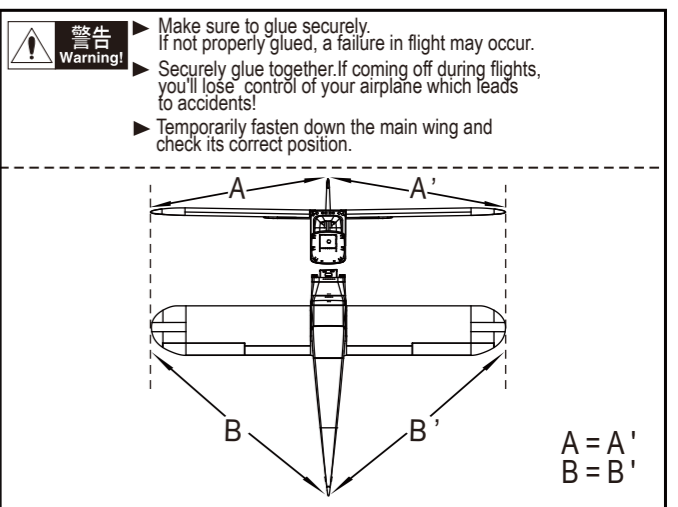

12 Secure the flap servo, install the control horn and connect the linkage.

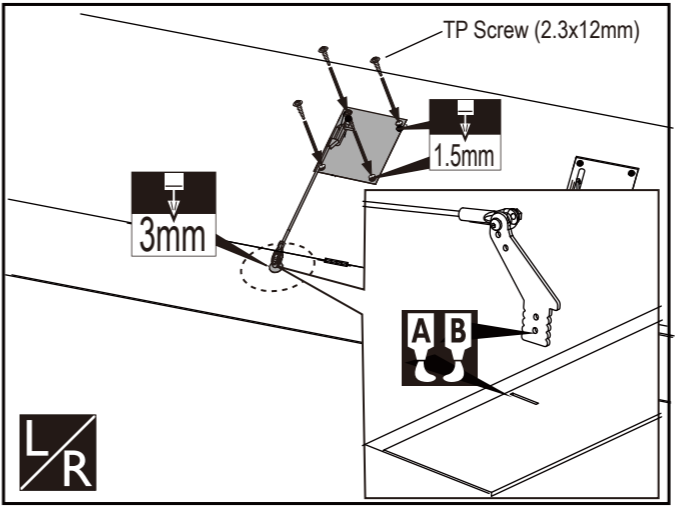

14 According to the rib template drill holes to the wing root and epoxy wood dowel in them.

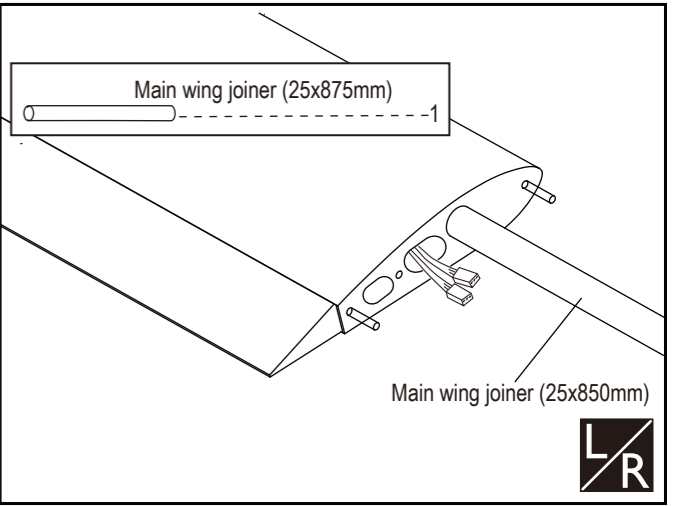

AB Apply epoxy glue. **LR** Assemble left and right sides the same way. **!** Pay close attention here!

CA Apply instant glue (CA glue, super glue). **→** Ensure smooth non-binding movement while assembling. **■** Cut off shaded portion.

! Accessory list for the coming installation steps.

	Main wing joiner (25x875mm)	1
	Screw (6x35mm)	2
	Washer (6x15mm)	2

15 Assemble the wings to the fuselage through the main wing joiner carefully.

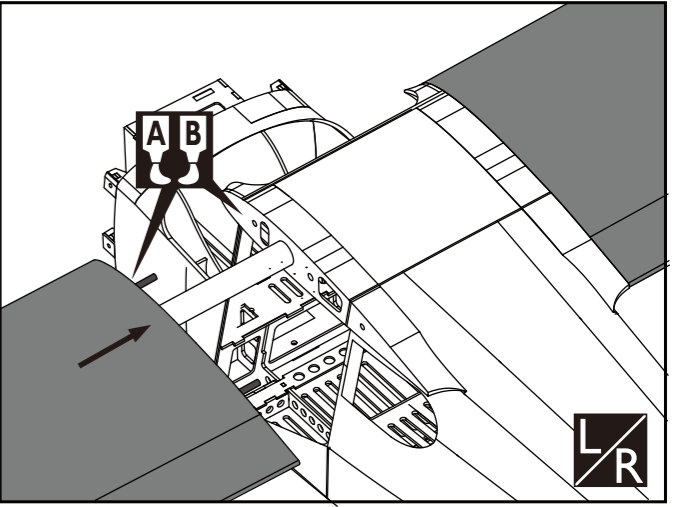

AB Apply epoxy glue. **LR** Assemble left and right sides the same way. **!** Pay close attention here!

CA Apply instant glue (CA glue, super glue). **→** Ensure smooth non-binding movement while assembling. **■** Cut off shaded portion.

16 Fix the wing to fuselage with screws through the holes applied in the wings and fuselage.

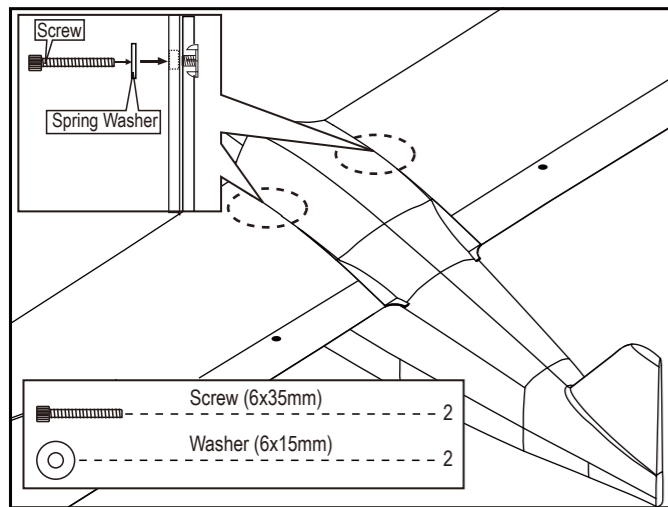

18 Keep about 1mm width space between elevator and trailing edge.

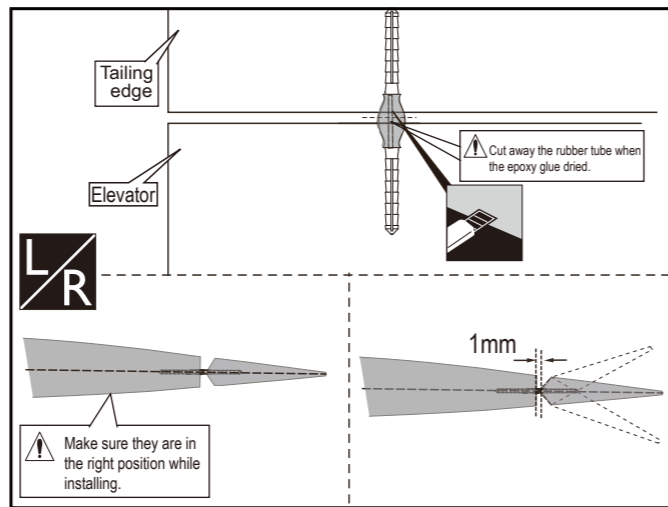

⚠️ Accessory list for the coming installation steps.

- Main wing joiner (12x346mm) ----- 1
- Pivot&round_hinge(4.5X67mm) ----- 6
- Servo tray(70x58x2mm) ----- 2
- Screw (3x25mm) ----- 4
- Rod (2x300mm) ----- 2
- TP Screw (2.3x12mm) ----- 8
- Collar (2mm) ----- 2
- Nut (2mm) ----- 2
- Screw (2x10mm) ----- 2
- Washer(2x5mm) ----- 2
- Washer(3x6mm) ----- 4
- Clevis ----- 2
- Control horn ----- 2

19 Epoxy the elevator to the stabilizer.

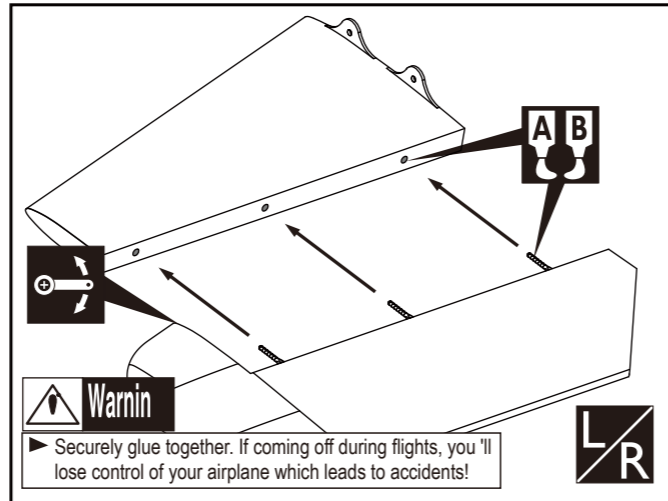

17 Apply instant type AB glue to appropriate position of the elevator and pivot & round hinges. Insert the pivot & round hinges to the elevator.

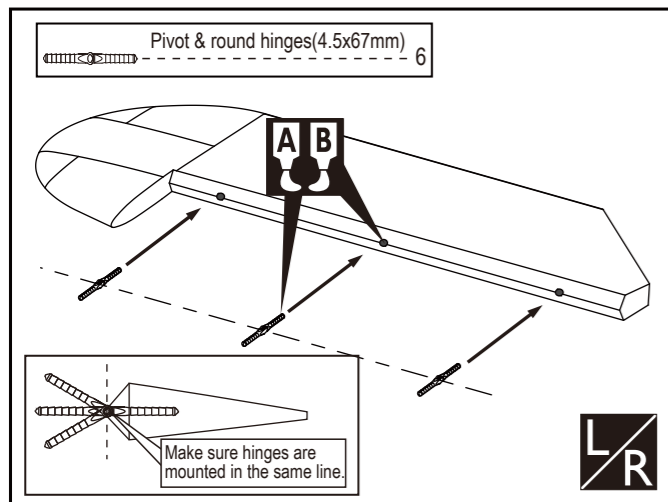

20 Assemble the stabilizer to the fuselage through the tail joint.

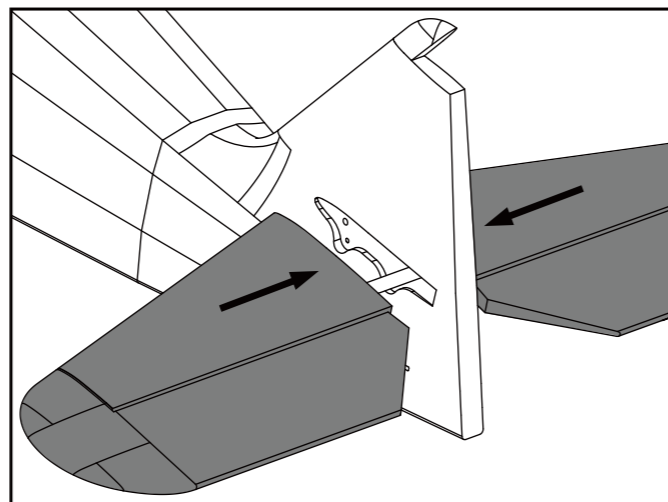

AB Apply epoxy glue. **LR** Assemble left and right sides the same way. **⚠️** Pay close attention here! **⚠️** Do not overlook this symbol!

CA Apply instant glue (CA glue, super glue). **➡** Ensure smooth non-binding movement while assembling. **✂️** Cut off shaded portion. **⚠️** Warning!

43 The sketch map when the engine install completion.

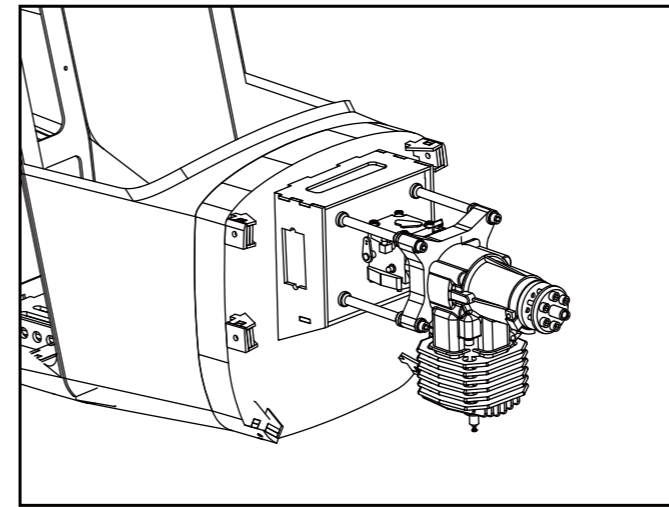

46 Assembly of the fuel tank.

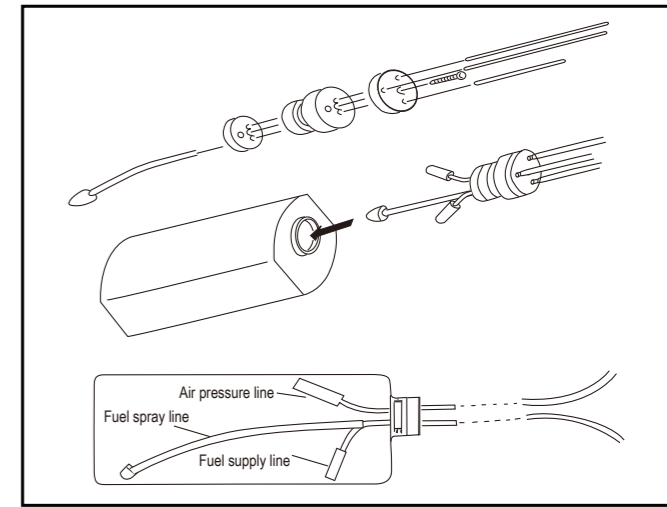

44 Install the servo of the throttle.

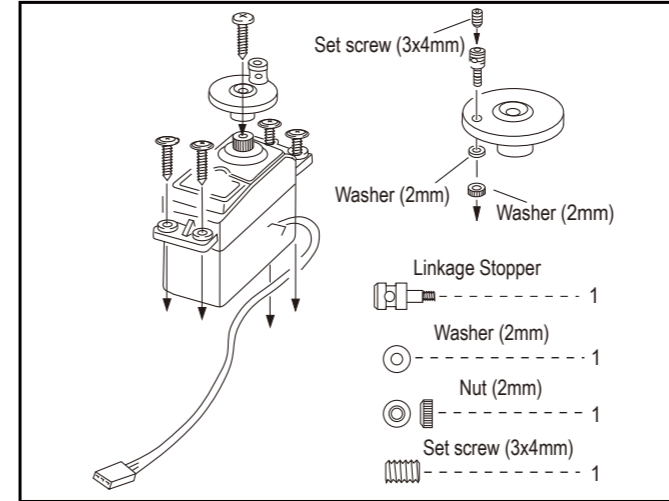

47 Fix the fuel tank to appropriate position in the fuselage with cable tie.

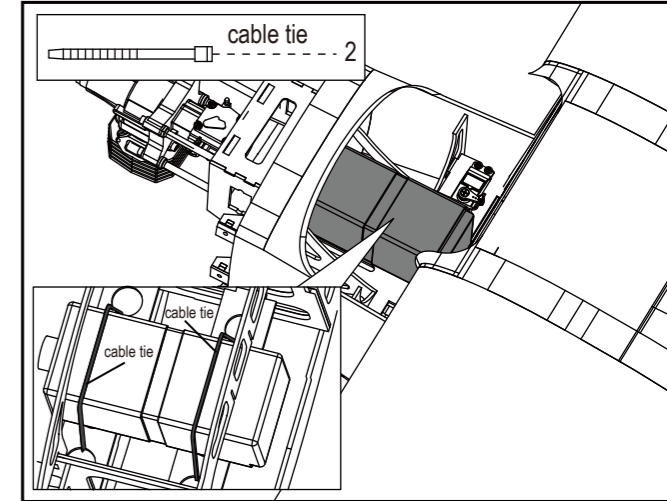

45 Trim a small slot in appropriate position for throttle using.

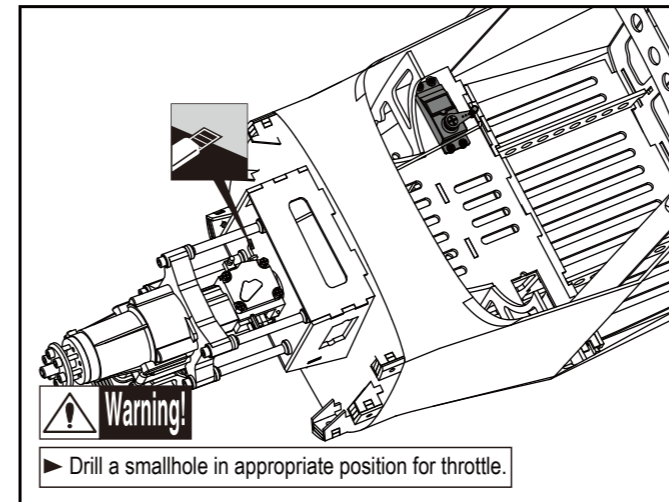

48 Mount the receiver and the battery to appropriate position in the fuselage.

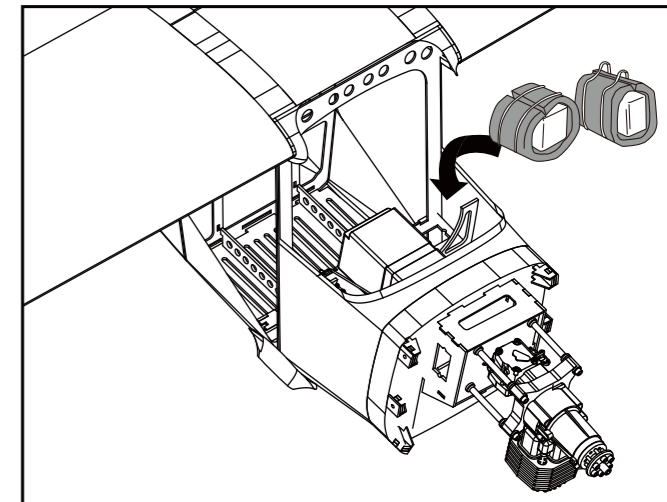

AB Apply epoxy glue. **LR** Assemble left and right sides the same way. **⚠️** Pay close attention here! **⚠️** Do not overlook this symbol!

CA Apply instant glue (CA glue, super glue). **➡** Ensure smooth non-binding movement while assembling. **✂️** Cut off shaded portion. **⚠️** Warning!

37 The front view once the engine install completion.

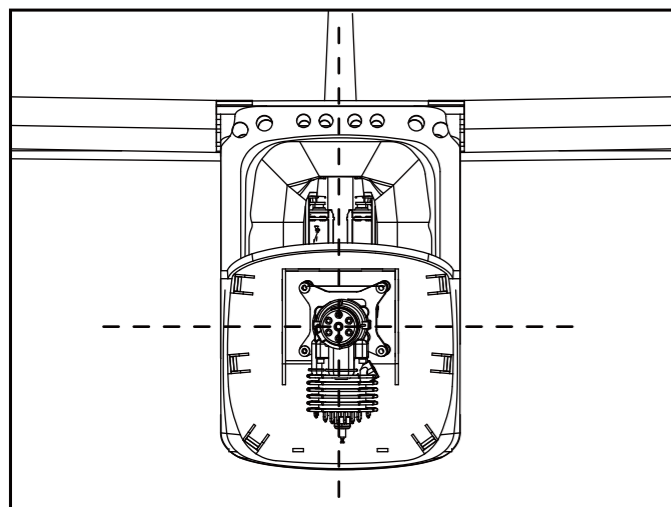

40 Install the engine mount tubes to the fuselage, lock them from inside of the fuselage.

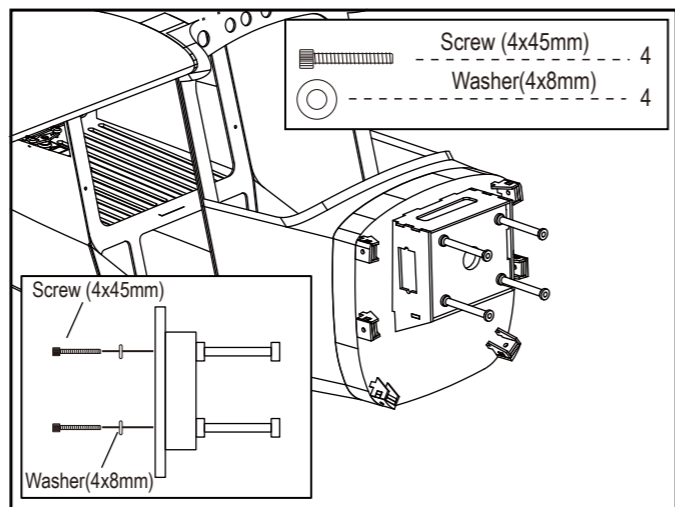

38 The side view once the engine install completion.

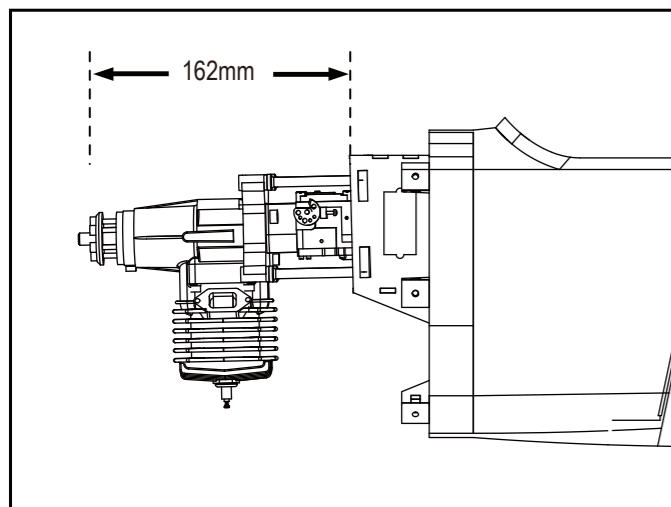

41 Assemble the engine to the fuselage via the engine mount tubes and screws.

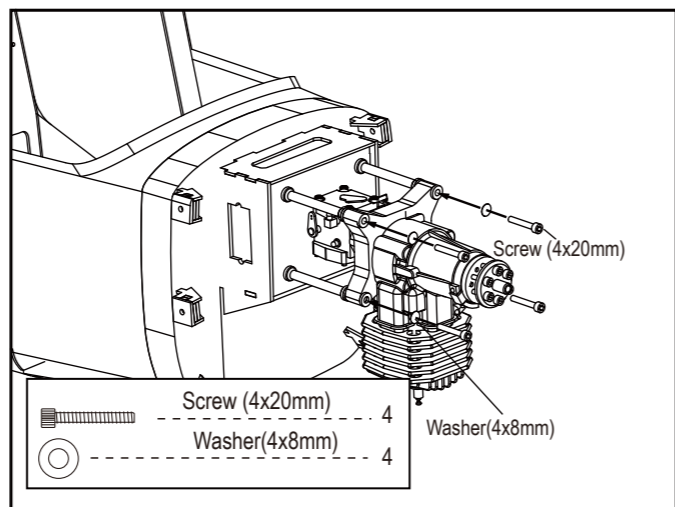

39 Drill four holes at the diameters as shown for engine mount.

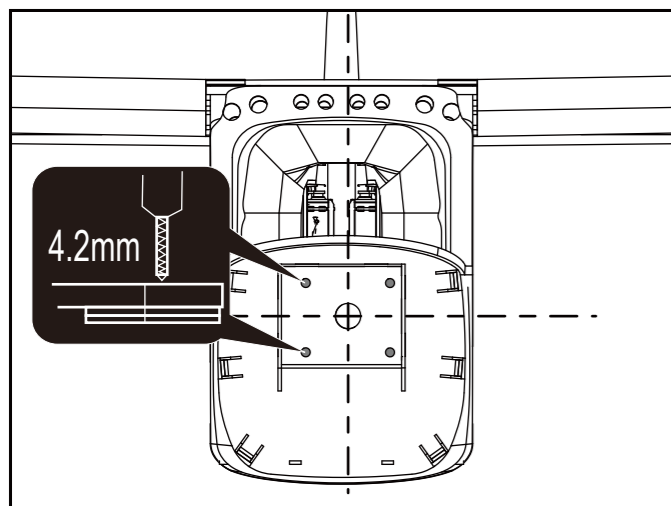

42 Assemble the throttle linkage.

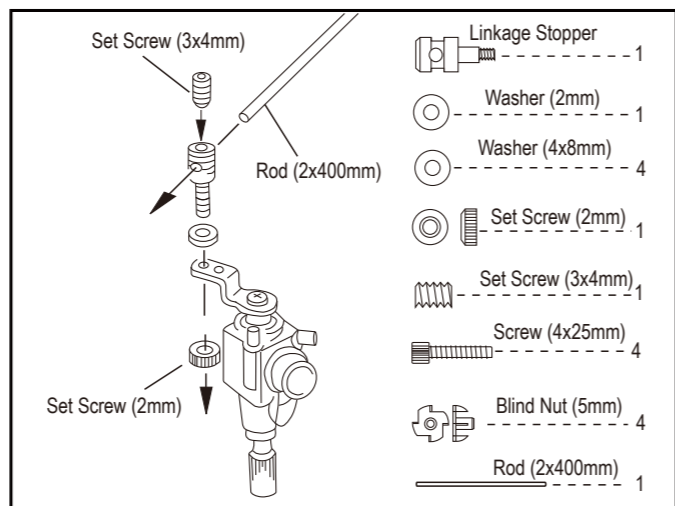

21 Assemble the servo of elevator to the servo mount.

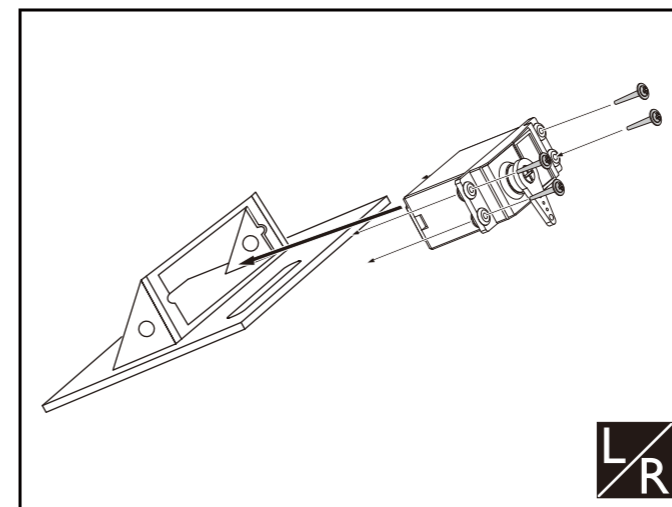

24 Fix the stabilizers to the tail fuselage via screws.

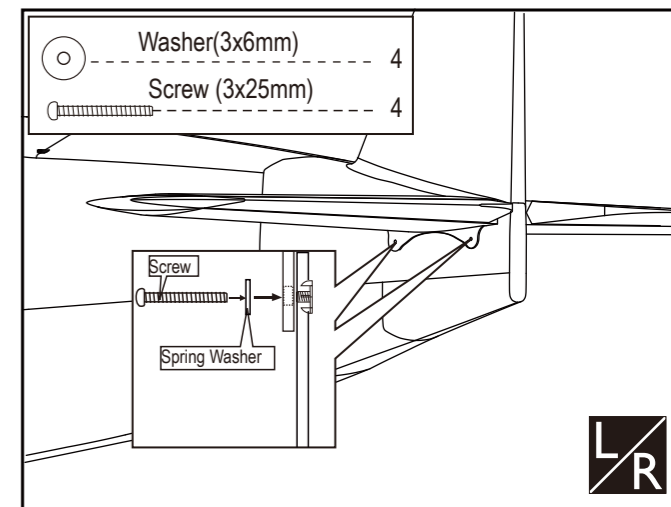

22 Install the control horn and connect the linkage.

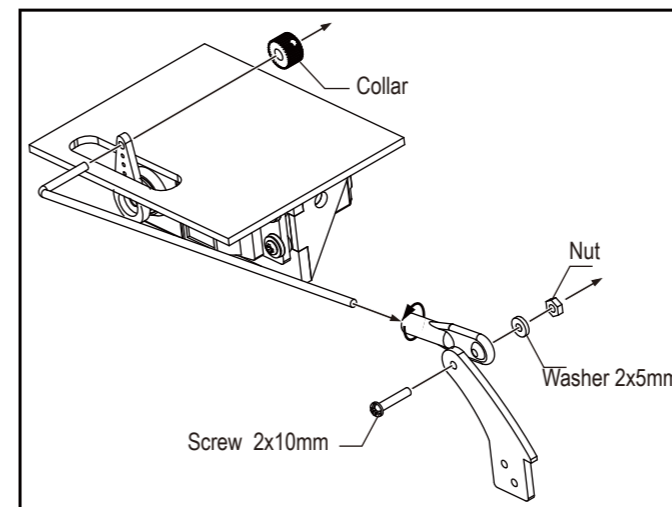

Accessory list for the coming installation steps.

Screw (2x10mm)	4	Collar (3mm)	3
Washer(2x5mm)	4	Nut (2mm)	4
Aluminium plate	1	Aluminium tube	4
Clevis	4	Control horn	2
Tail wheel (45mm)	1	TP Screw (2.3x12mm)	3
Steel wire (0.5x3000mm)	2	Tail landing gear 3mm	1
Pivot&round_hinge(4.5X67mm)	3	Copper joiner	4

23 Epoxy the control horn to the slots in the elevator, assemble the elevator servo to the fuselage as illustration.

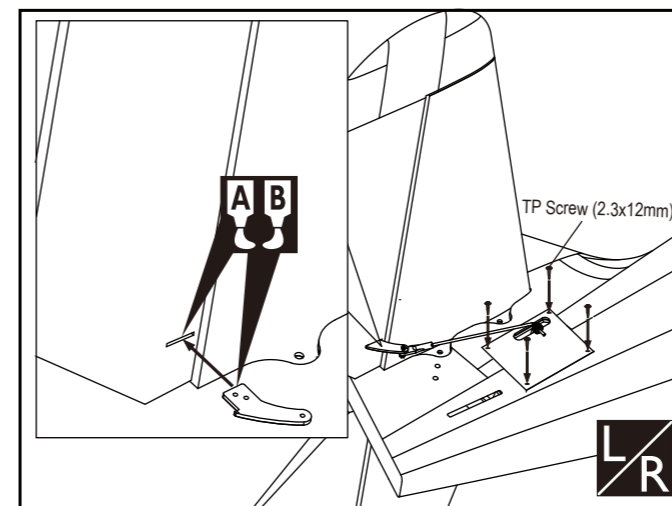

25 Install the tail landing gear.

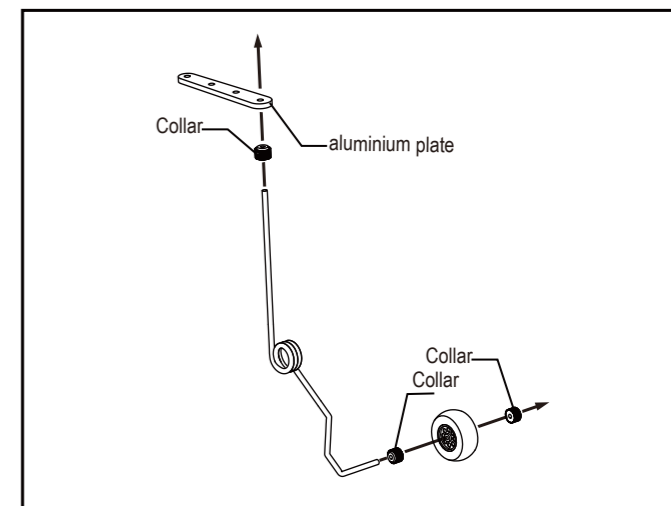

Apply epoxy glue.
 Assemble left and right sides the same way.
 Pay close attention here!
 Do not overlook this symbol!

Apply instant glue (CA glue, super glue).
 Ensure smooth non-binding movement while assembling.
 Cut off shaded portion.

Apply epoxy glue.
 Assemble left and right sides the same way.
 Pay close attention here!
 Do not overlook this symbol!

Apply instant glue (CA glue, super glue).
 Ensure smooth non-binding movement while assembling.
 Cut off shaded portion.

26 According to the illustration below bend the tail landing gear wire and cut off the surplus part.

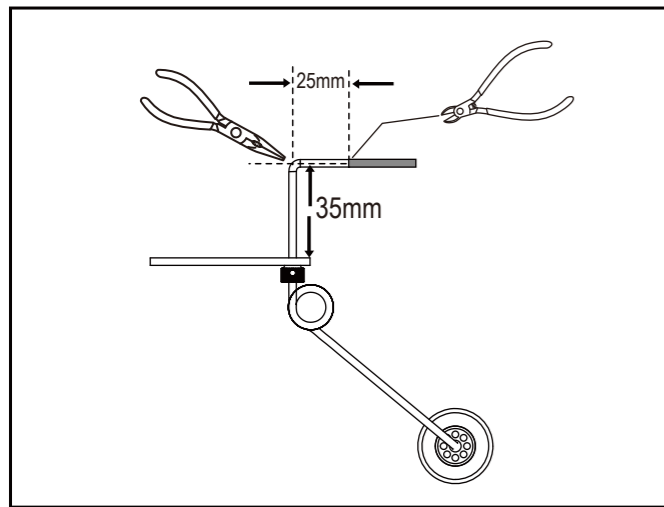

29 Epoxy the rudder to the vertical fin..

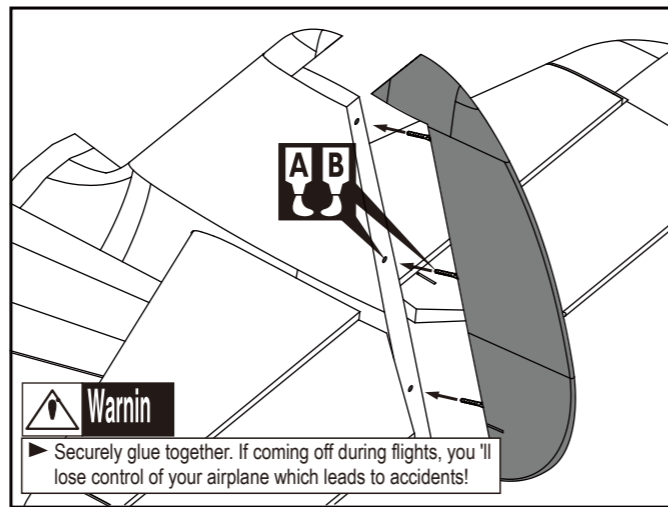

27 Epoxy the pivot & round hinges to the rudder, drill holes to appropriate position in the rudder and assemble the tail landing gear to it as shown.

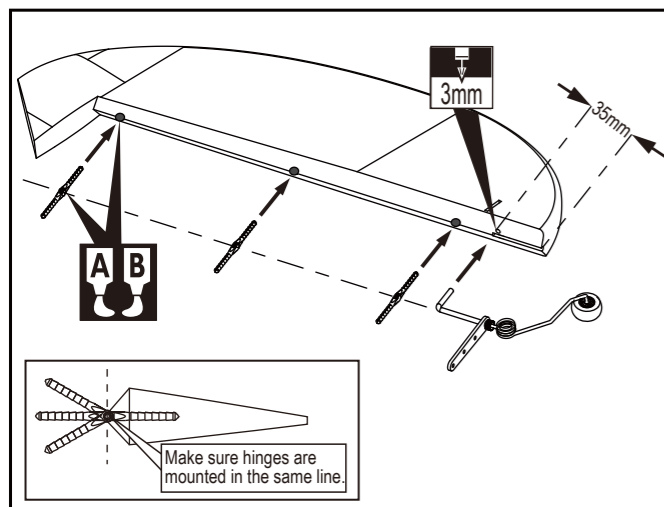

30 Assemble the tail landing gear to tail fuselage as below.

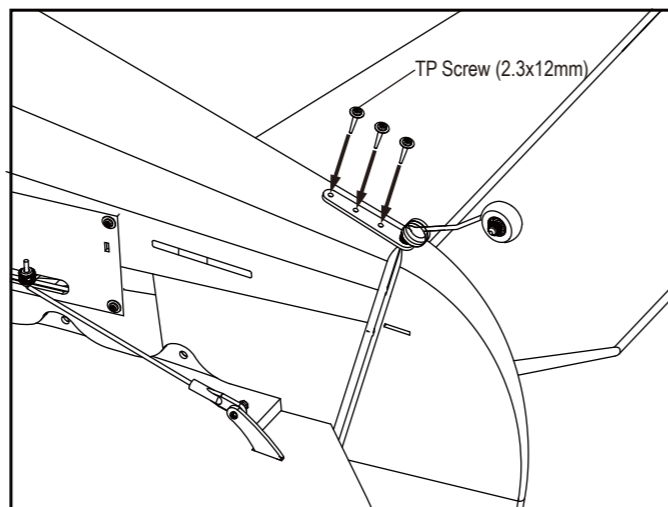

28 Keep some space about 1mm width between the rudder and tail edge.

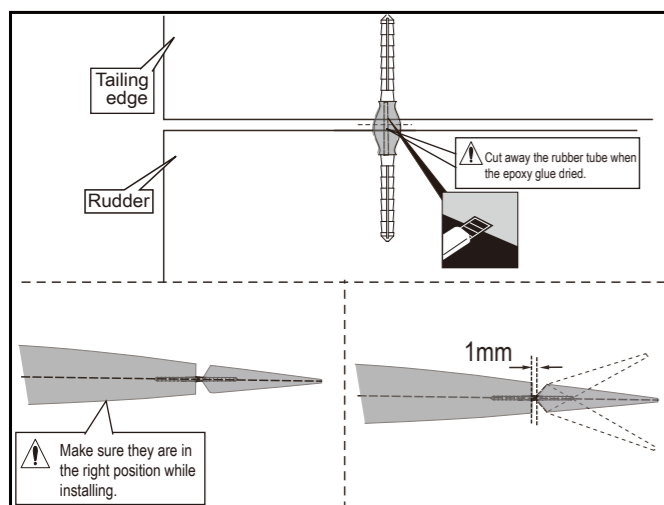

31 Epoxy the control horns to the slots in the rudder.

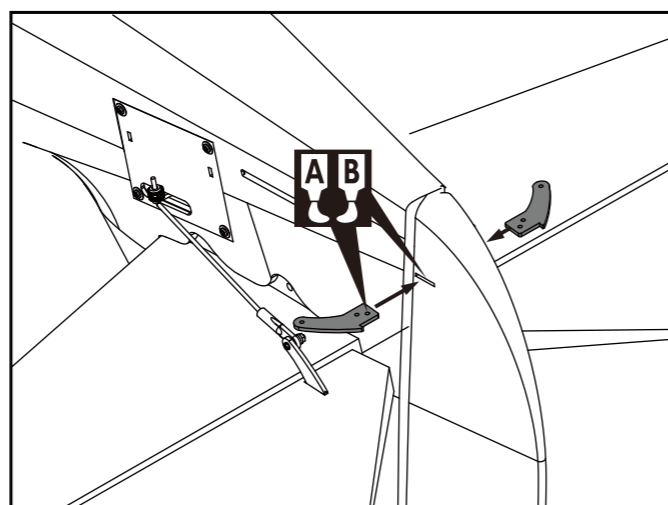

32 Lock the linkage to the control horn with screws and nuts as below.

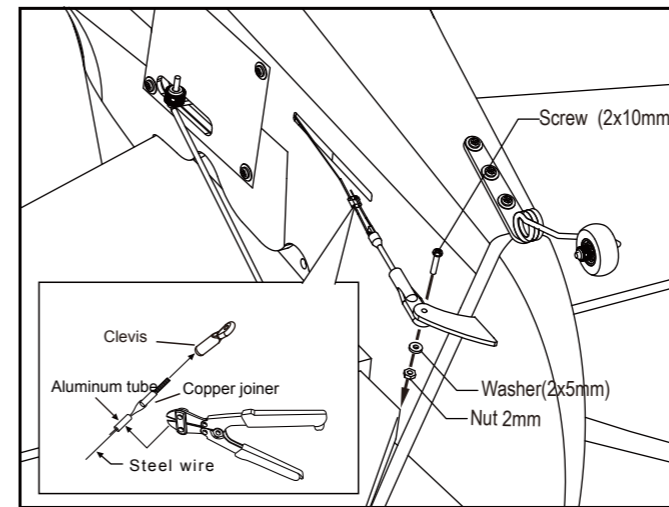

35 The sketch map of how the steel wires works for the rudder.

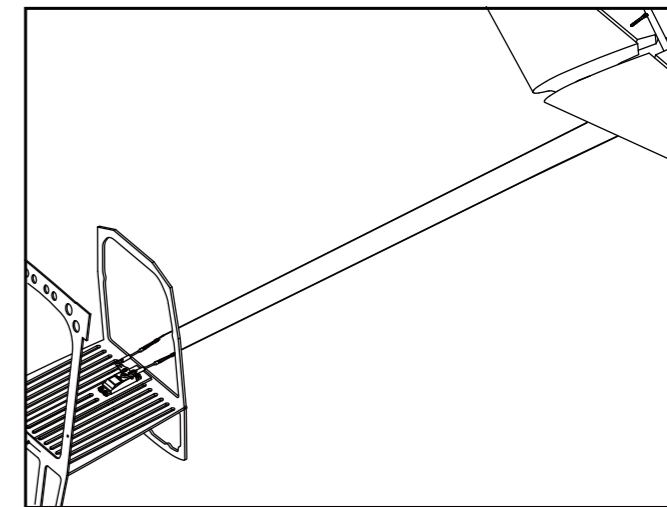

33 Install the servo of the rudder.

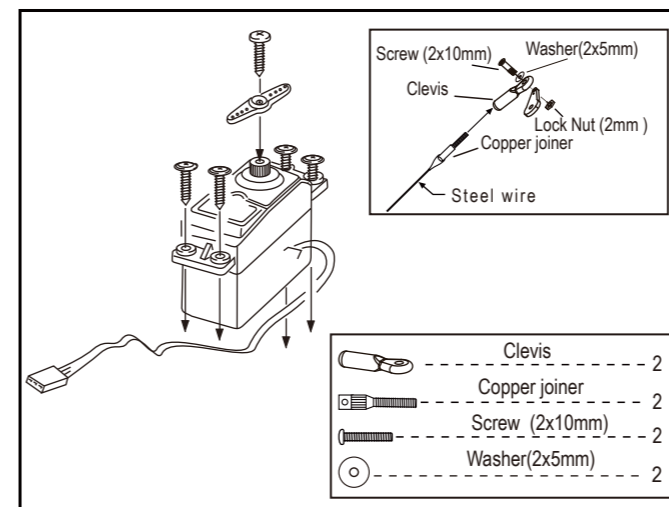

36 The sketch map should be when the rudder and stabilizer install completion.

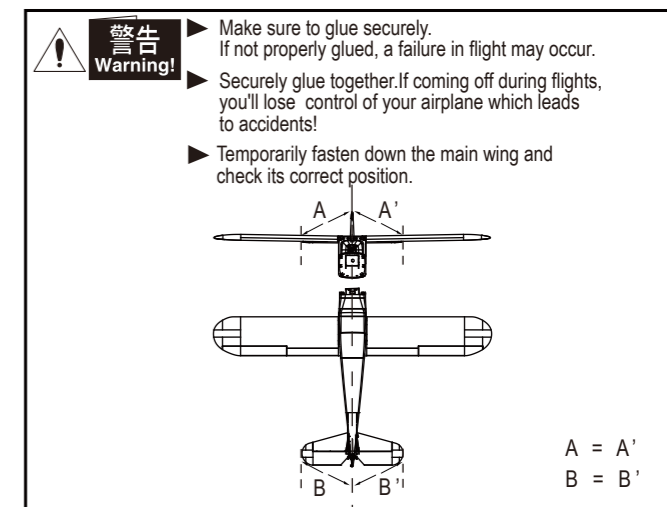

34 Assemble the servo of the rudder in the fuselage and connect the servo and the rudder via steel wires.

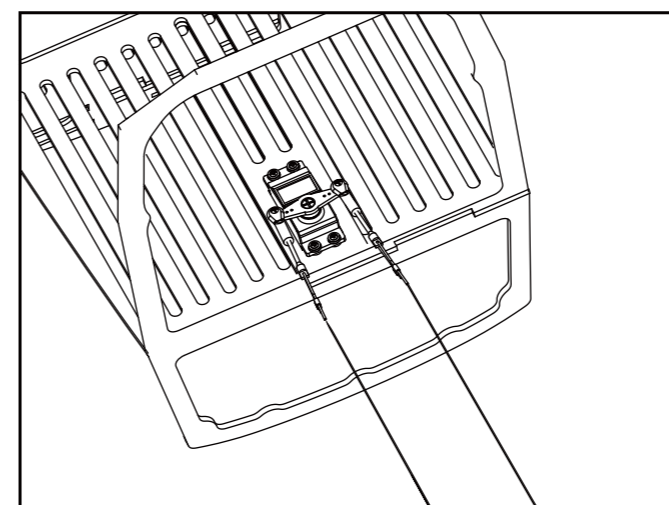

Warning! Accessory list for the coming installation steps.

	Screw (4x45mm)	4
	Screw (4x20mm)	4
	Washer (4x8mm)	12
	Linkage Stopper	2
	Plastic tube (2x400mm)	1
	Engine mount (60x5mm)	4
	Fuel tank (550cc)	1
	Cable tie	2
	Blind Nut (5mm)	4
	Rod (2x400mm)	1

Apply epoxy glue.
 Assemble left and right sides the same way.
 Pay close attention here!
 Do not overlook this symbol!

Apply instant glue (CA glue, super glue).
 Ensure smooth non-binding movement while assembling.
 Cut off shaded portion.

Apply epoxy glue.
 Assemble left and right sides the same way.
 Pay close attention here!
 Do not overlook this symbol!

Apply instant glue (CA glue, super glue).
 Ensure smooth non-binding movement while assembling.
 Cut off shaded portion.