

Thank you for choosing CYmodel
Global : www.cymodel.com
Australia : www.austars-model.com
Italia : www.biellaexpress.com

Reggiane RE 2005

Item Nr: CY8146



Instruction Manual

Before commencing assembly, please read these instructions thoroughly.



Warning!

SAFETY PRECAUTIONS

This radio control model is not a toy!

- First-time builders should seek advice from people having building experience in order to assemble the model correctly and to produce its performance to full extent.
- Assemble this kit only in places out of children's reach!
- Take enough safety precautions prior to operating this model.
You are responsible for this model's assembly and safe operation!
- Always keep this instruction manual ready at hand for quick reference, even after completing the assembly.
- Could cause serious injury or even death

SPECIFICATION

Wing Span.....2400 mm (94.5 in)
Wing Area.....97 dm²(1504 sq.in)
Take-off weight....13.5 kg
Length.....1970 mm (78in)
Engine.....50-80cc gas engine
Radio.....6 channels, 8 servos

REQUIRED FOR OPERATION (Purchase separately)

- 1** A minimum 6 channel radio for airplanes (with 8 servos). And dry batteries.



CAUTION: Only use a minimum 6 channel radio for airplanes! (No other radio may be used!)

A minimum 6 channel transmitter for airplanes.



12 AA-size Batteries



For handing the radio properly, refer to its instruction manual.

- 2** Engine and Muffler
Model Airplane engine
50-80 cc gas engine



Muffler

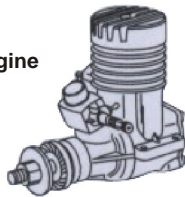

50-80 cc gas engine



Glow plug

- 3** Propeller splinner

Purchase a propeller that will match your engine



- 4** Silicone Tube  Fuel Filter 

- 5** required for engine starting Glow engine fuel only.



WARNING: Normal gasoline cannot be used with glow engines.



Fuel Pump

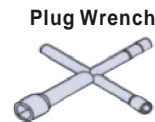

Plug Wrench

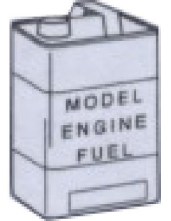

- 6** Glue  Instant glue  Epoxy Glue

- 7** Other equipment for enhancing airplane operation & performance

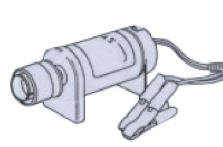

Engine Starter

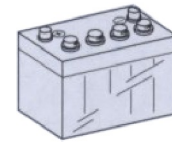

12V Battery (for starter)

TOOLS REQUIRED (Purchase separately)

Sharp Hobby Knife



Phillips Screw Driver



Awl



Needle Nose Pliers

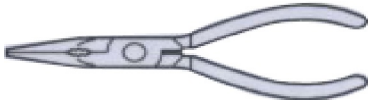

Wire Cutters



Scissors

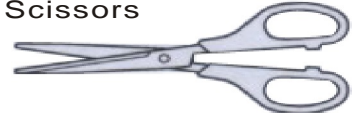

BEFORE YOU BEGIN

- 1 . Read through the manual before you begin ,so you will have an overall idea of what to do.
- 2 . Check all parts .if you find any defective or missing parts .contact your local dealer.
- 3 . Symbols used throughout this instruction manual,comprise.



Apply epoxy glue.



Drill holes with the specified Diameter(here:2mm)



Must be purchased separately!



Apply instant glue (CA glue,super glue).



Ensure smooth non-binding movement while assembling.



Pay close attention here!



Assemble left and right Sides the same way.



Cut off shaded portion.



Cut off excess.



Warning!

Do not overlook this symbol.



Accessory list for this page.

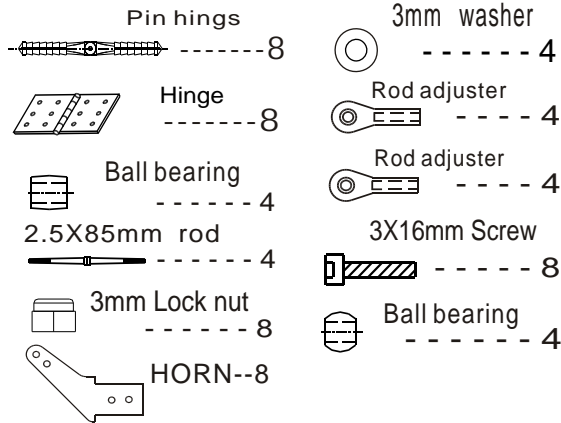

3

Epoxy flap hinges to trailing edge

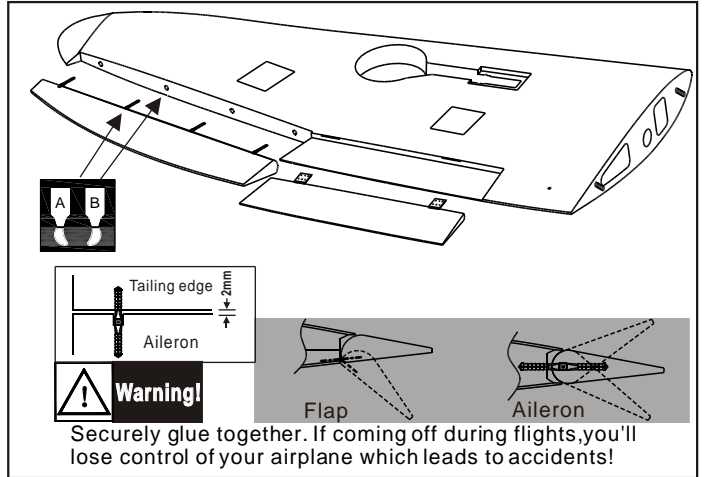

1 Epoxy pin hings to aileron steadily

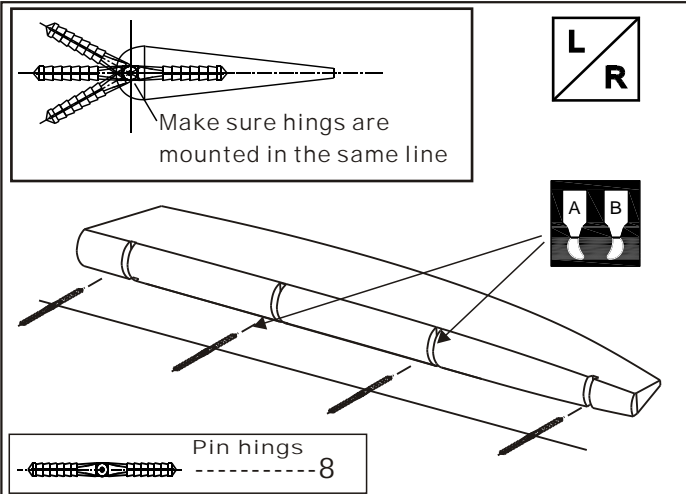

4

Install the servo

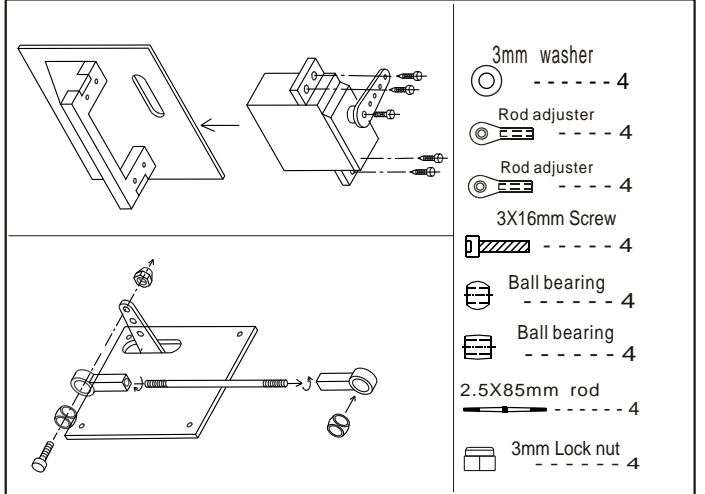

2 Install the aileron

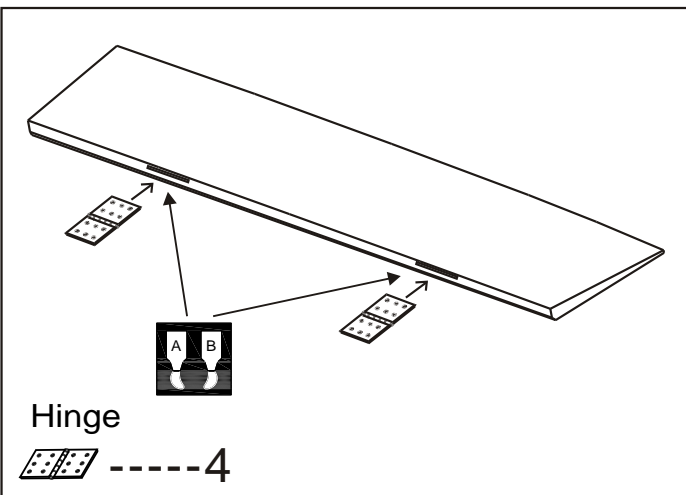

5

Install the control horn and connect the linkage

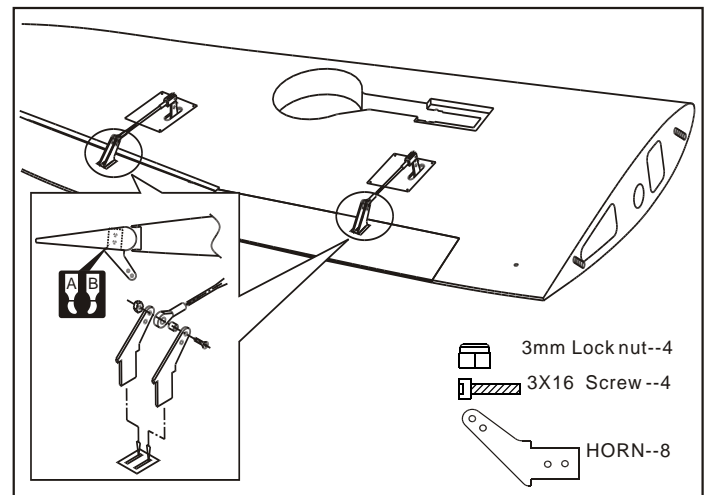



Accessory list for this page.

- | | |
|------------------------|-------------------------|
| 3mm Lock nut--4 | 4mm Lock nut
----- 2 |
| 3X16 Screw --4 | 3X3mm screw
----- 4 |
| HORN--8 | M3X5mm Screw
---- 4 |
| 3mm plywood
----- 2 | |

8

Mount the landing gear

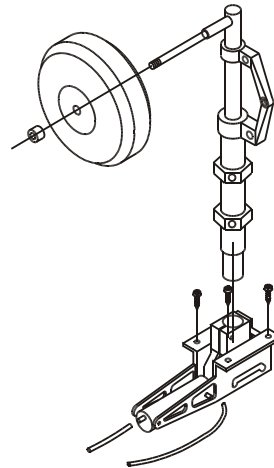

- | |
|-------------------------|
| ----- 4 |
| 4mm Lock nut
----- 2 |

6

Mount the landing gear cover

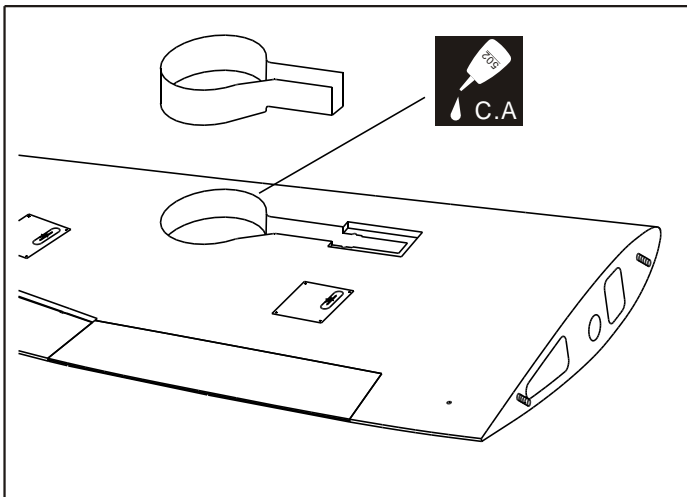

9

Instal the main landing gear

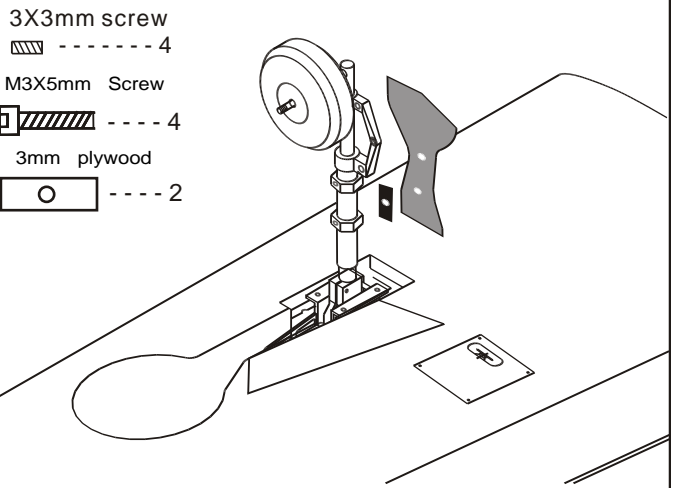

- | |
|------------------------|
| 3X3mm screw
----- 4 |
| M3X5mm Screw
---- 4 |
| 3mm plywood
----- 2 |

7

Two wheel retract system

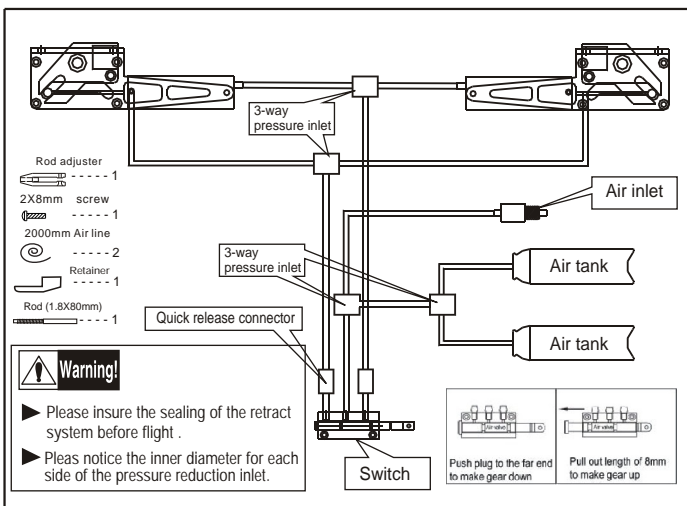



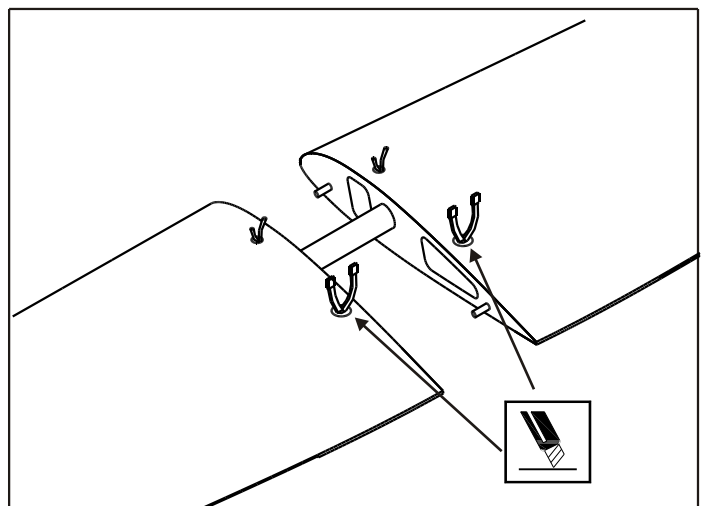

10

The hole for servos cable way



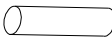

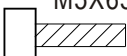
Accessory list for this page.

-  Carbon tube ----- 2
-  5mm Blind Nut ----- 4
-  M5X65mm screw ----- 4
-  5mm washer ----- 4

13

Drill holes in the wings and set the Carbon fibre dowels in them as below

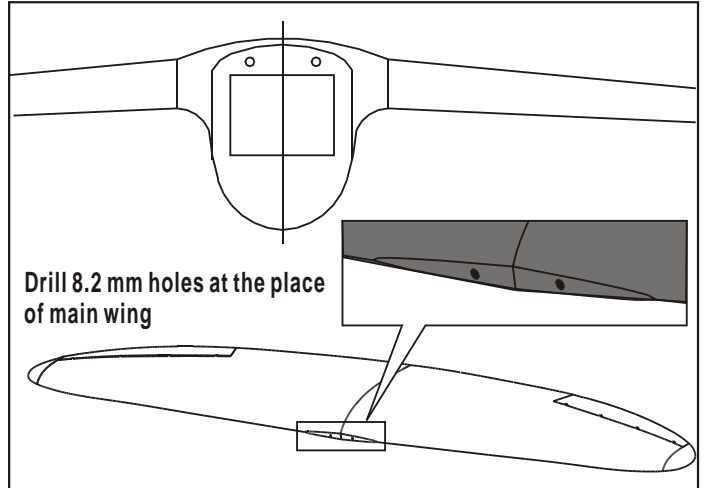

11

Drill holes to relevant position in the fuselage

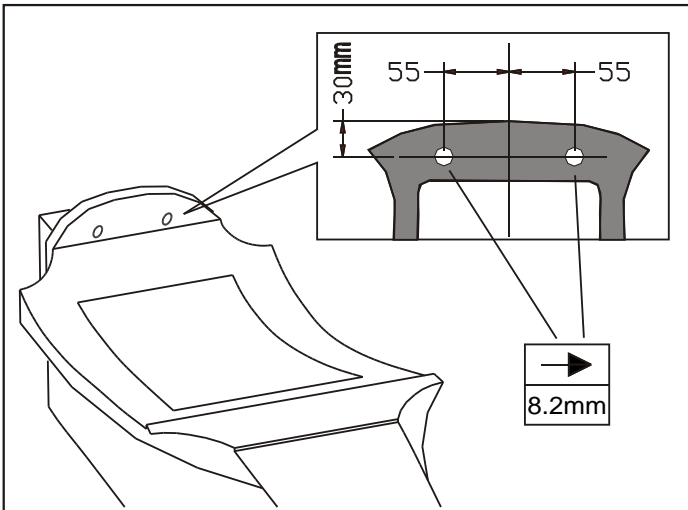

14

Drill holes in the wings and set the Carbon fibre dowels in them as below

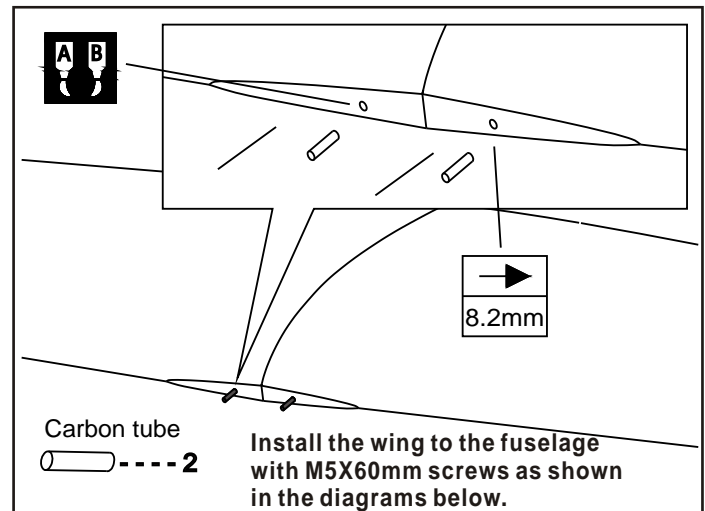

12

Assemble the wings

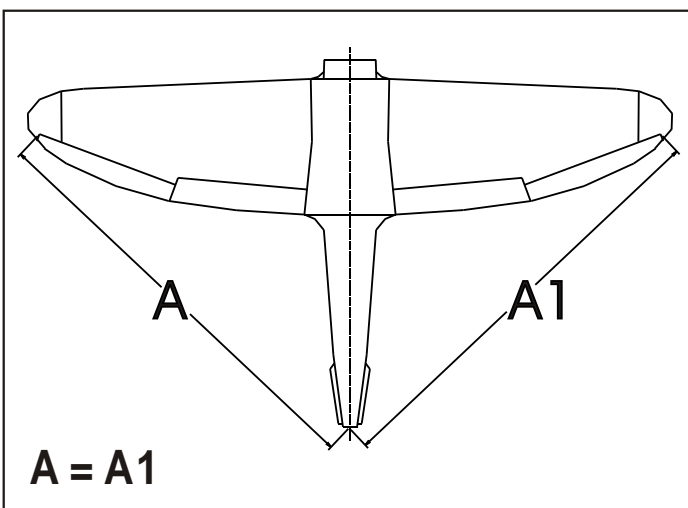

15

Assemble the wings to the fuselage with screw and blind nut as below

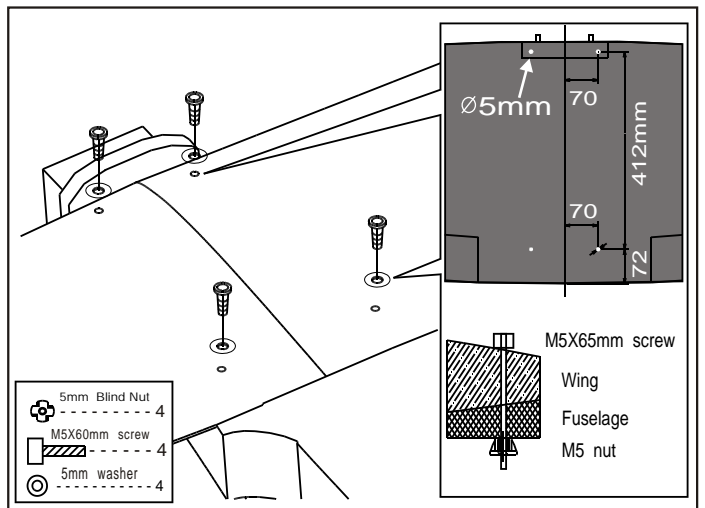



Accessory list for this page.

- Ply wooden ----- 4
- M4x12mm Screw ----- 4
- 3X3mm Screw ----- 4
- Pin hinges ----- 3
- Hardwood ----- 4

18 Epoxy pin hinges to elevator

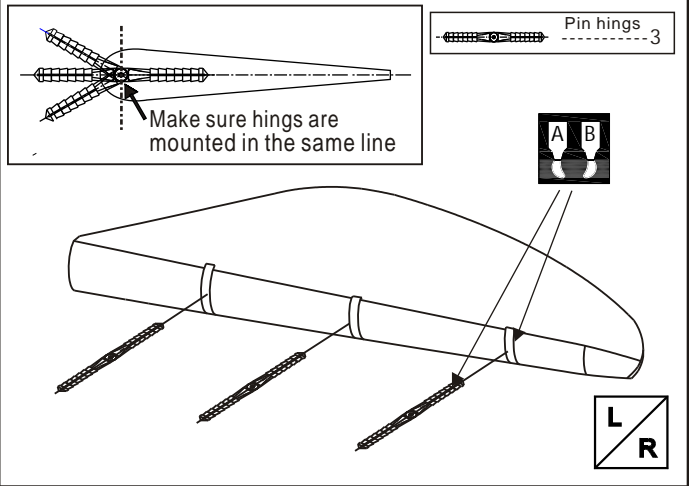

16 Drill holes in the belly pants appropriate position

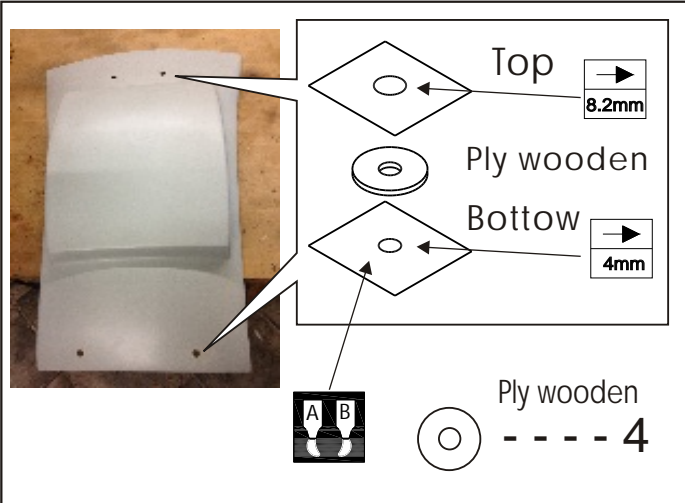

19 Assemble the elevator to stabilizer

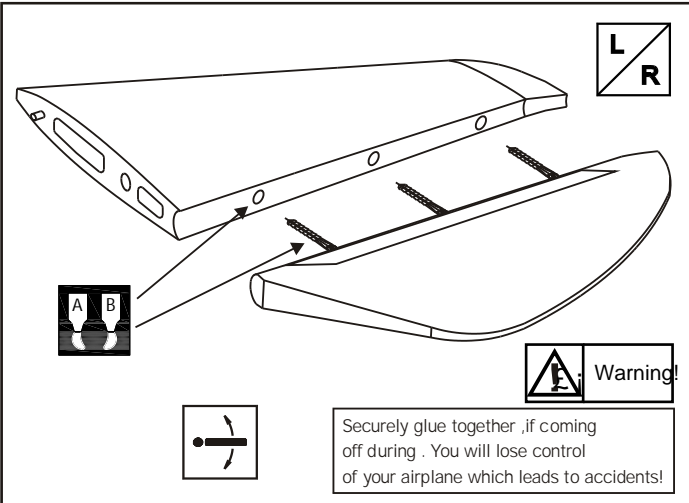

17 Assemble the belly pants to the wings with screw

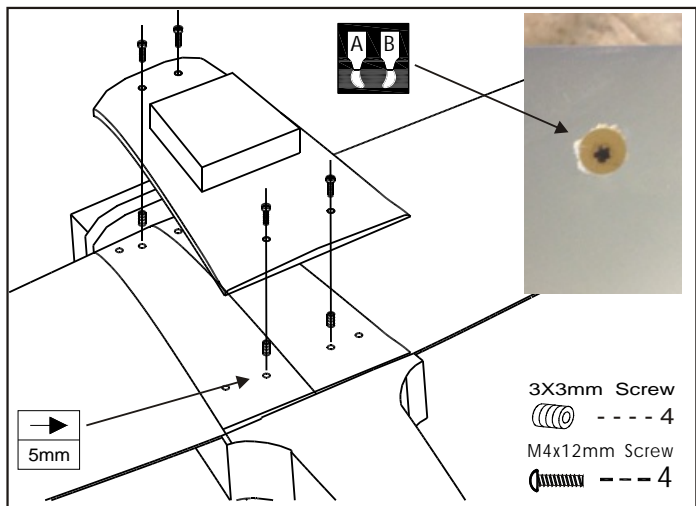

- 3X3mm Screw ----- 4
- M4x12mm Screw ----- 4

20 Install the servo

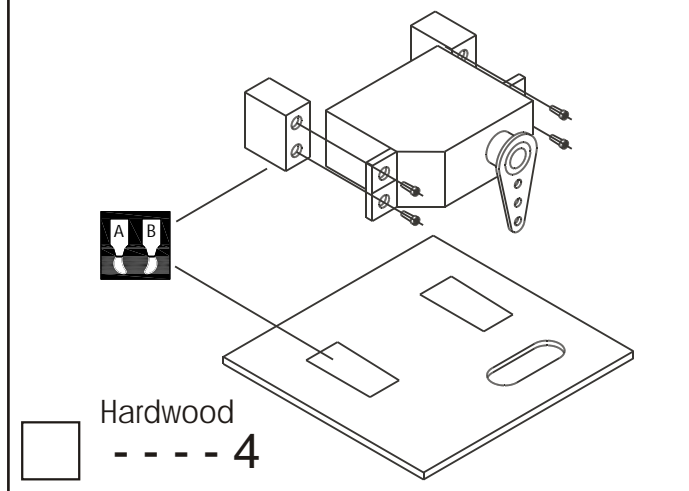

- Hardwood ----- 4

! Accessory list for this page.

- | | |
|----------------------|---------------------------|
| 3mm washer ----- 2 | 3X14mm Screw ----- 4 |
| Rod adjuster ----- 2 | Ball bearing ----- 2 |
| Rod adjuster ----- 2 | Ball bearing ----- 2 |
| 2.5X85mm rod ----- 2 | HORN--4 |
| 3mm Lock nut ----- 4 | 2.3x10mm Tp Screw ----- 8 |

23 Secure the servo. Install the nylon control horn and connect the linkage

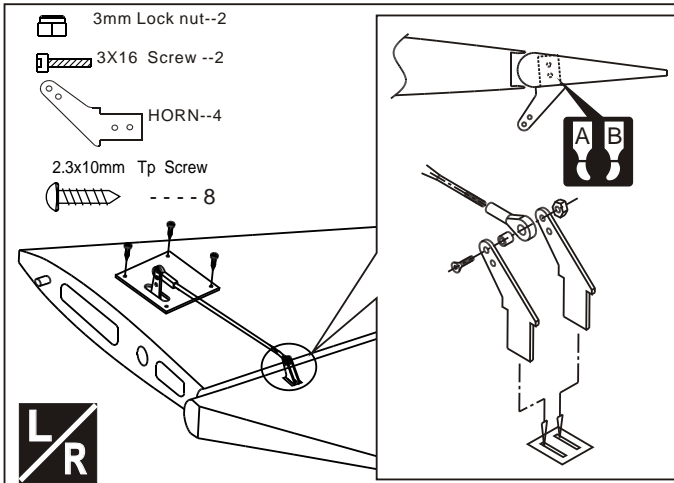

21 The position of the control horn in the elevator

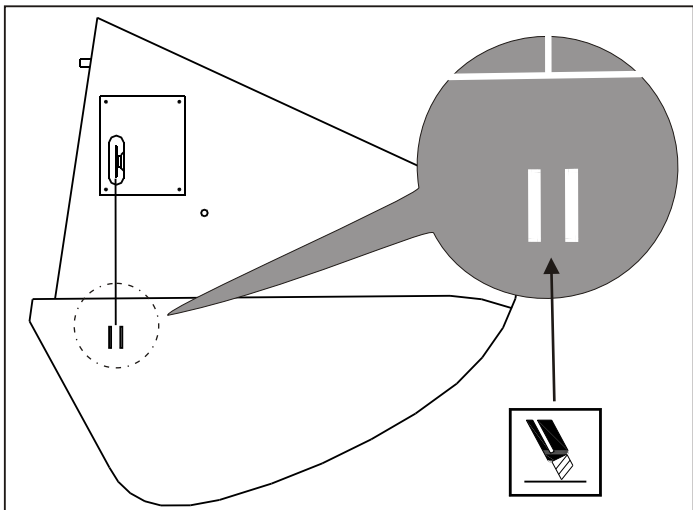

24 Assemble the stabilizer to fuselage as illustration

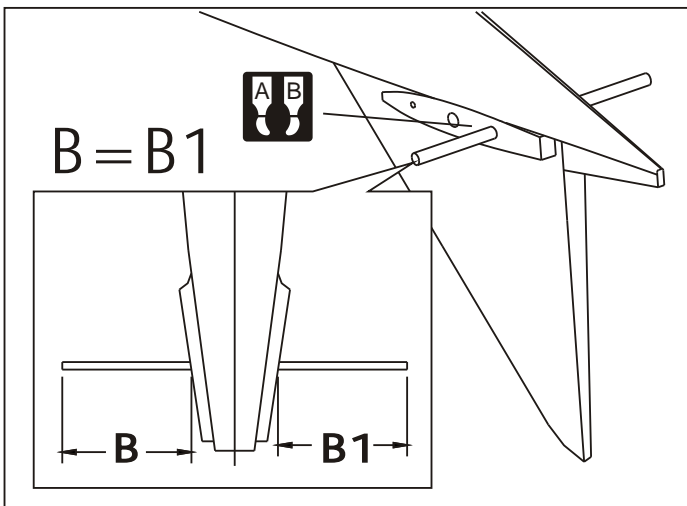

22 Install the nylon control horn and the linkage

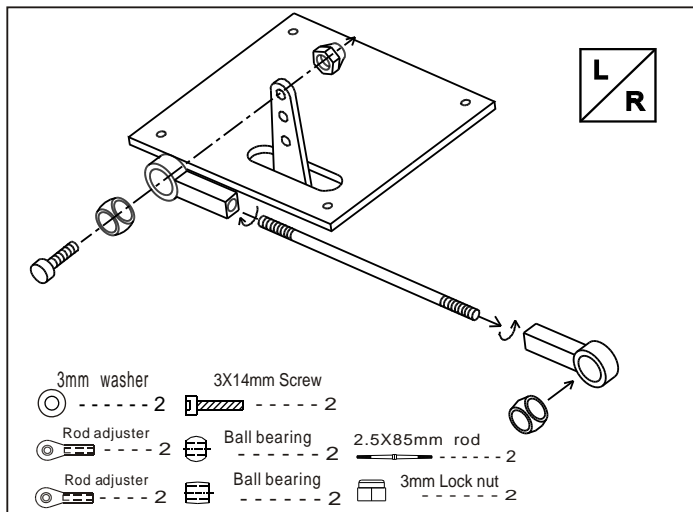

25 Assemble the stabilizer to fuselage as illustration

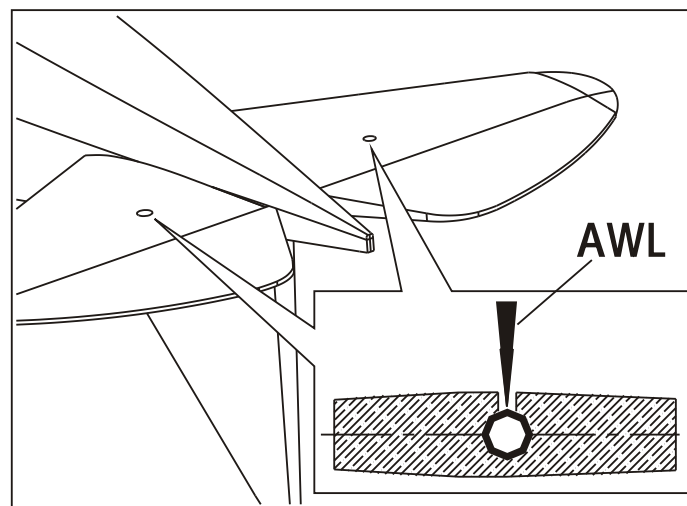

Accessory list for this page.

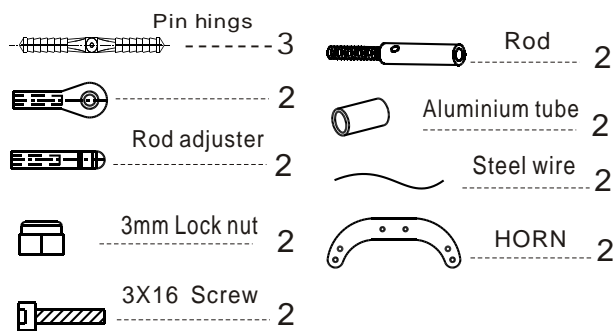

28 Instal the rudder in to the vertical fin

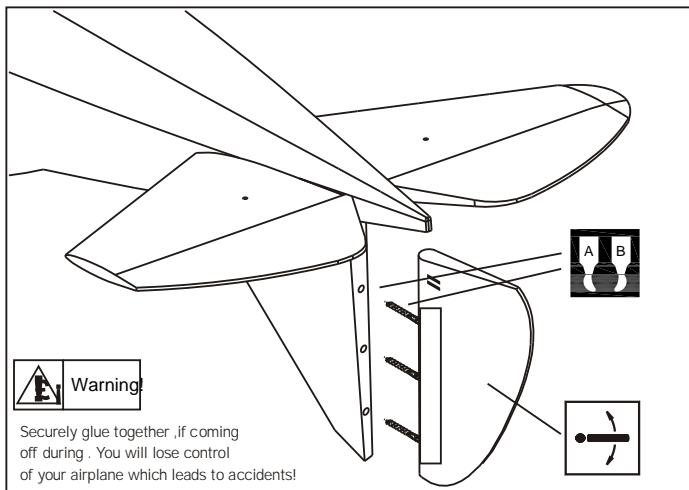

26 Assemble the stabilizer to fuselage as illustration

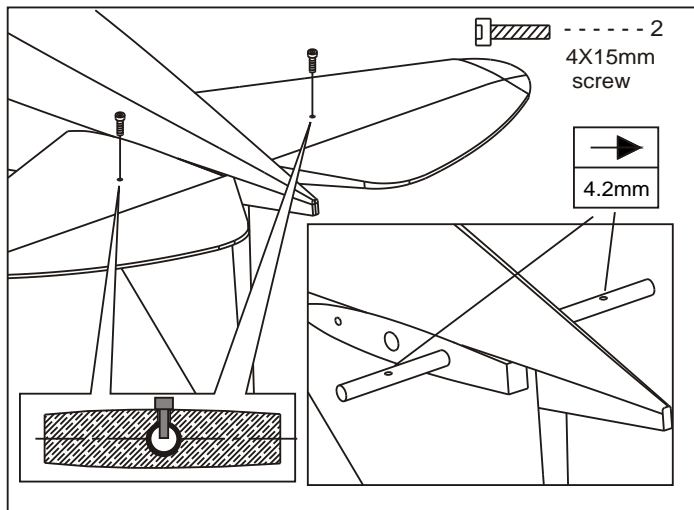

29 Rudder . Connect the linkage rod to the horn

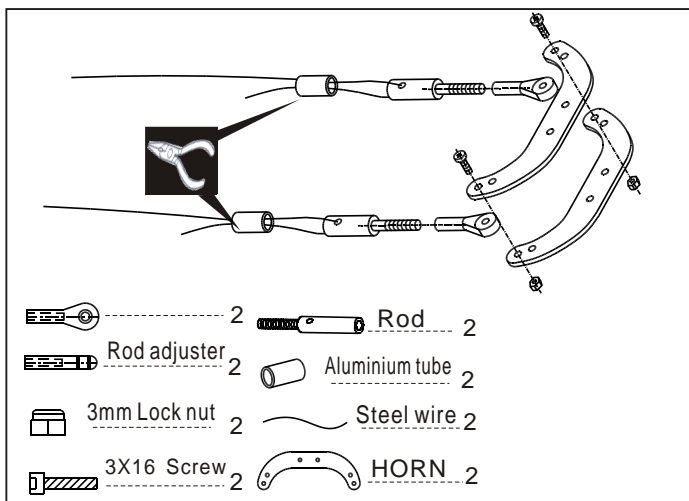

27 Epoxy pin hinges to elevator

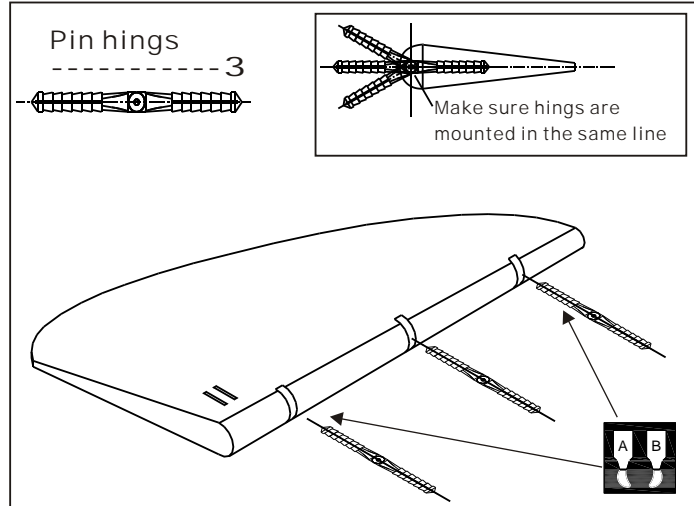

30 Rudder . Connect the linkage rod to the horn

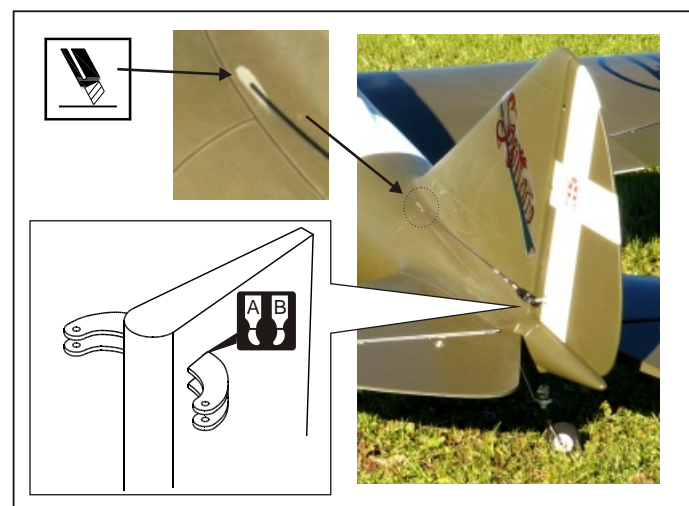



Accessory list for this page.

- | | | |
|-------------------------------|------------------------------|------------------------------|
| 6mm nut
----- 1 | M4X20mm Cap screw
----- 2 | 3X3mm Screw
----- 1 |
| 3.2mm Collar
----- 3 | 4mm Blind Nut
----- 2 | 3.2mm Rocker
----- 1 |
| 6X9 screw
----- 1 | Rod adjuster
----- 2 | 2.3x10mm Tp Screw
----- 4 |
| 3X3mm Screw
----- 3 | Rod
----- 2 | |
| 3.2mm Nylon Collar
----- 1 | Steel wire
----- 2 | |
| | Aluminium tube
----- 2 | |

33

Fitting of the tail wheel assembly

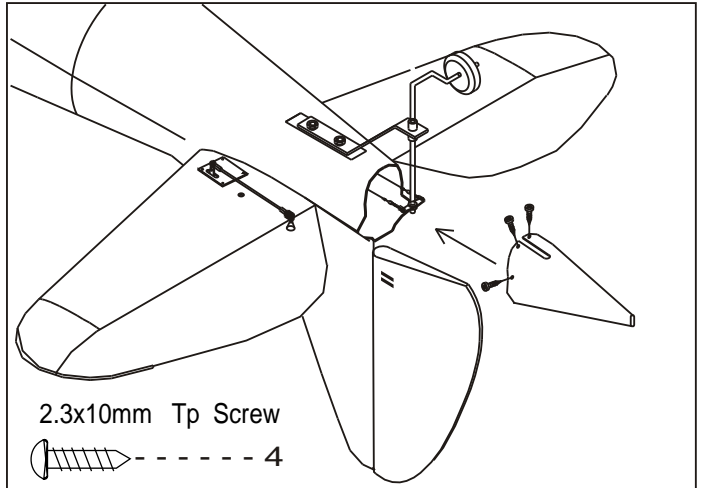

31 Install the tail wheel

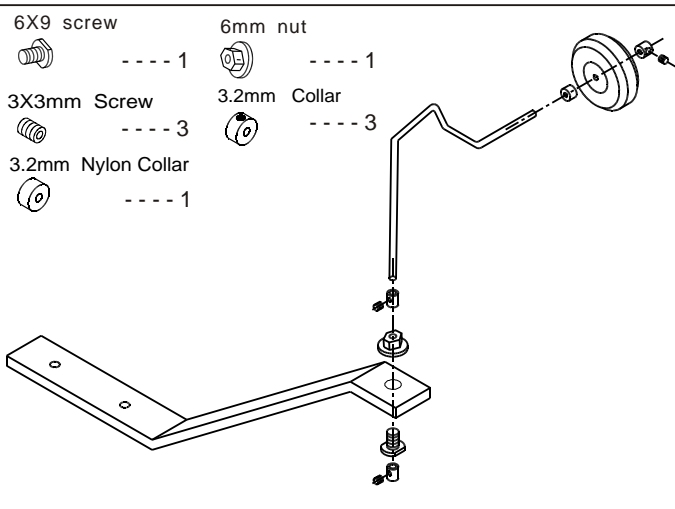

34

Assembly of the engine

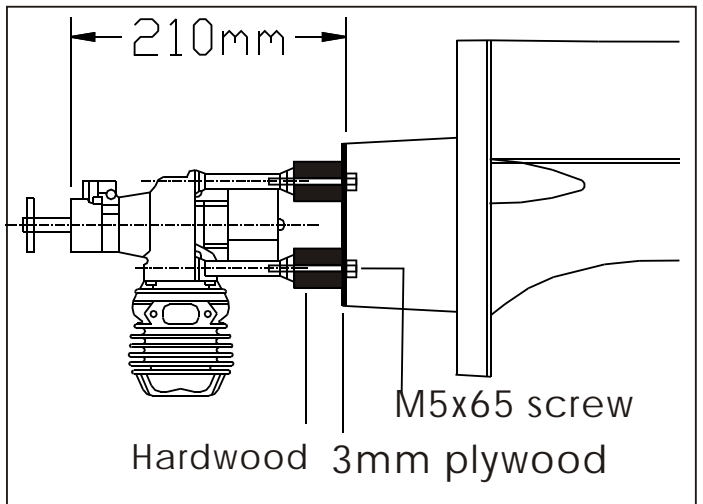

32 Assemble the tail landing gear to the fuselage

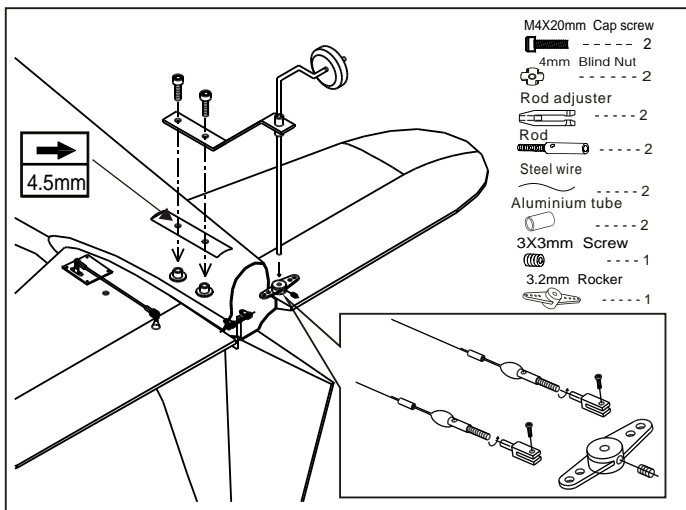

35

Assembly of the full tank

After confirming the position (see front of fuel tank). Insert and tighten the screw.

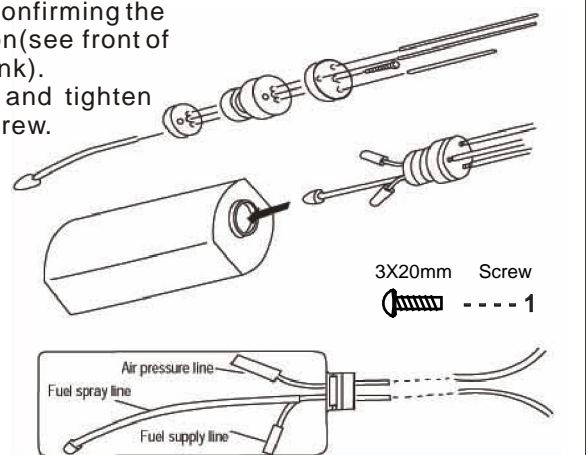



Accessory list for this page.

Rod adjuster



Rod

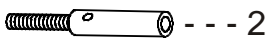

Aluminium tube

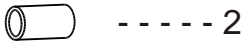

2.3X10 Tp screw



M3X15mm screw

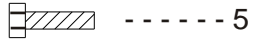

3mm plywood

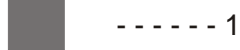

3mm Washer

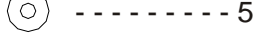

3mm Blind Nut

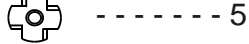

38

Assemble the cowling to fuselage with screw

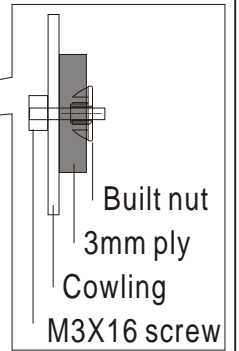

M3X15mm screw



3mm Washer



3mm plywood



3mm Blind Nut



36

Epoxy the fuel tank and rudder servo in the fuselag

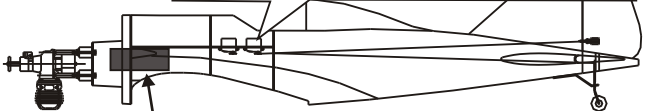
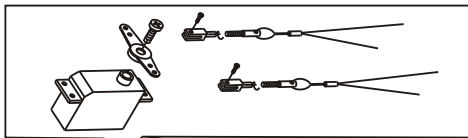

Fuel tank

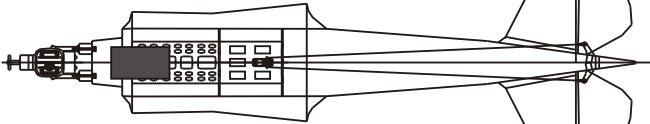

Rod adjuster

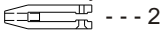

Rod

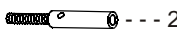

Aluminium tube



39

Assemble the canopy to the fuselage with TP screws

2.3X10 Tp screw

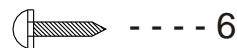

37

Assemble the antenna to fuselage with A/B glue

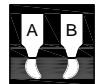
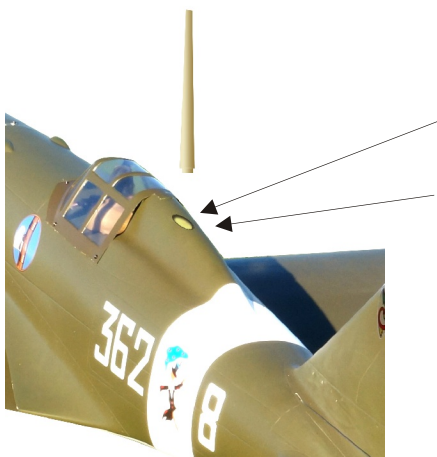

40

Assemble the oil filler pipe to fuselage with A/B glue

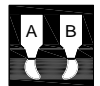

41 Adjustment.

Adjust the travel of each control surface to the values in the diagrams.
These values fit general flight capabilities.
Readjust according to your needs and flight level.

AILERON

Top view

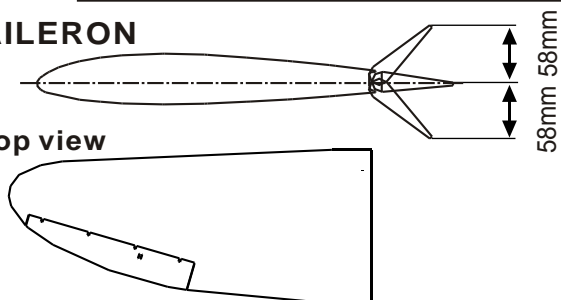

43 Adjustment.

Adjust the travel of each control surface to the values in the diagrams.
These values fit general flight capabilities.
Readjust according to your needs and flight level.

Top view

Side view

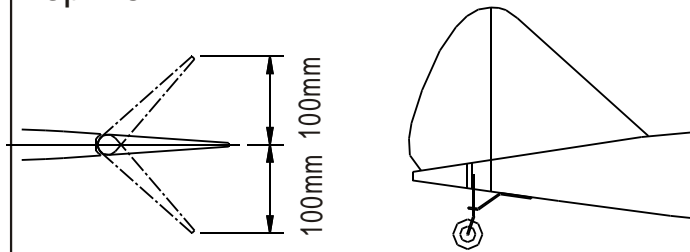

42 Adjustment.

Adjust the travel of each control surface to the values in the diagrams.
These values fit general flight capabilities.
Readjust according to your needs and flight level.

Side view

Top view

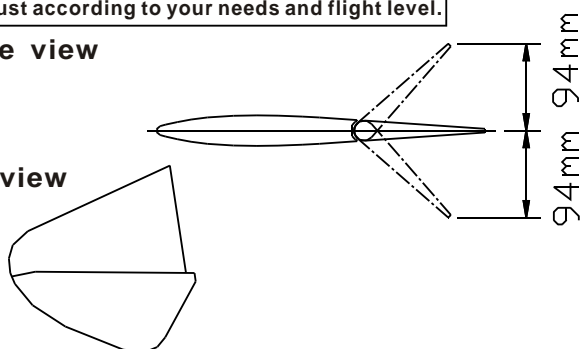

44 Centre of Gravity.

Never fly before checking the Cg's required position.
In order to obtain the CG specified, reposition the receiver and battery.

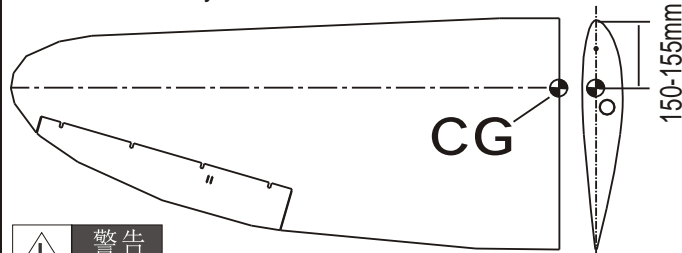

NEVER fly the model without well balancing.



Take-off



Landing