

Before commencing assembly, please read these instructions thoroughly.

ALMOST - READY - TO - FLY



Spitfire MK IX



Warning!

SAFETY PRECAUTIONS

This radio control model is not a toy!

- First-time builders should seek advice from people having building experience in order to assemble the model correctly and to produce its performance to full extent.
- Assemble this kit only in places out of children's reach!
- Take enough safety precautions prior to operating this model.
You are responsible for this model's assembly and safe operation!
- Always keep this instruction manual ready at hand for quick reference, even after completing the assembly.
- Could cause serious injury or even death

SPECIFICATION

Wing Span: 2800mm (110 in)

Wing Area: 142.5dm² (2210sq.in)

Total Length: 2370 mm (93 in)

Engine :85-100cc gas engine

Radio : 6 channels ,9 servos

REQUIRED FOR OPERATION (Purchase separately)

- 1 A minimum 6channel radio for airplanes (with 9servos). And dry batteries.



CAUTION: Only use a minimum 6channel radio for airplanes! (No other radio may be used!)

A minimum 6 channel transmitter for airplanes.



12 AA-size Batteries

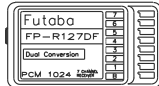

receiver



remote control

For handing the radio properly, refer to its instruction manual.

- 2 Battery (need 2)



Switch (need 2)



- 3 Servo(need 9 servos)



- 4 Engine and Muffler
Model Airplane engine:85-100cc gas engine



Muffler



Ignition



Muffler



Ignition



- 5 Glue



Epoxy Glue



Instant glue

- 6 required for engine starting



WARNING: Normal gasoline cannot be used with glow engines.

Glow engine fuel only.

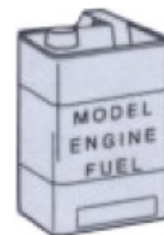

Fuel Pump



Plug Wrench

- 7 Silicone Tube



Fuel Filter



- 8 Other equipment for enhancing airplane operation & performance

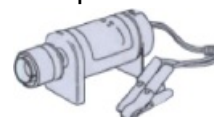

Engine Starter

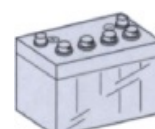

12V Battery (for starter)

- 9 Purchase a propeller that will match your engine



TOOLS REQUIRED (Purchase separately)

Sharp Hobby Knife



Phillips Screw Driver



Awl



Needle Nose Pliers

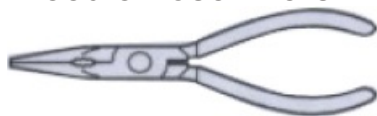

Wire Cutters



Scissors

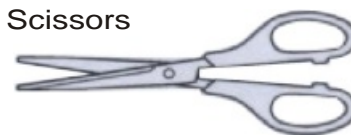

BEFORE YOU BEGIN

- 1 Read through the manual before you begin ,so you will have an overall idea of what to do.
- 2 Check all parts .if you find any defective or missing parts .contact your local dealer.
- 3 Symbols used throughout this instruction manual,comprise.



Apply epoxy glue.



Drill holes with the specified Diameter(here:2mm)



Must be purchased separately!



Apply instant glue (CA glue,super glue).



Ensure smooth non-binding movement while assembling.



Pay close attention here!



Assemble left and right Sides the same way.



Cut off shaded portion.



Cut off excess.



Warning!

Do not overlook this symbol.



Accessory list for this page.

2.3X10mm Tp screw

----- 16

3X35mm screw

----- 6

2X8mm screw

----- 8

2.5X85mm rod

----- 4

Hinge

----- 8

3X12mm TP screw

----- 6

HORN ----- 4

----- 2

4X40 Screw

----- 4

Rod adjuster

----- 8

Connecting rod head

----- 8

Hinge

----- 8

----- 8

3 Install the servo

L/R

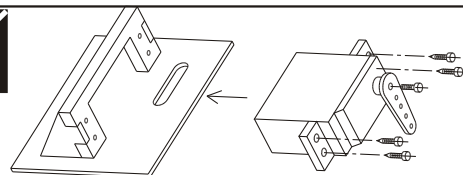

Aileron

Flap.

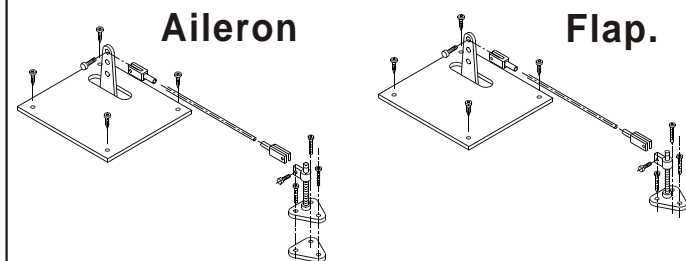

1 Install the aileron and flap

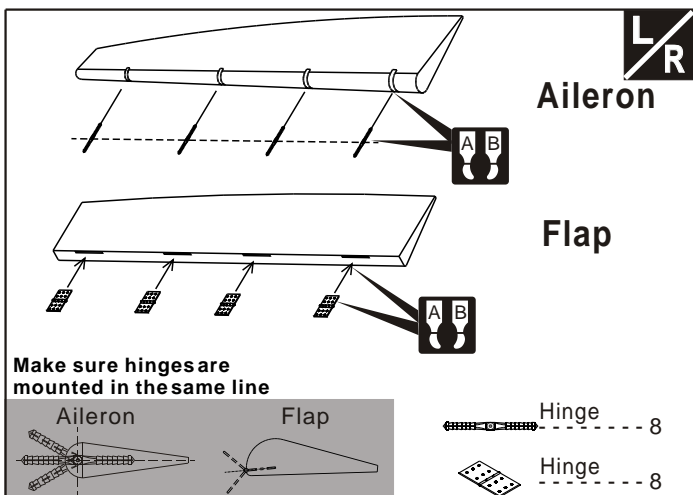

4 Install the servo of aileron

L/R

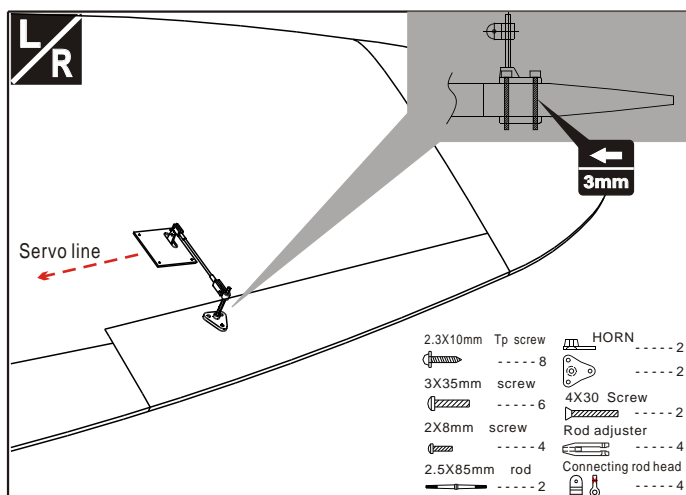

2 Install the aileron and flap

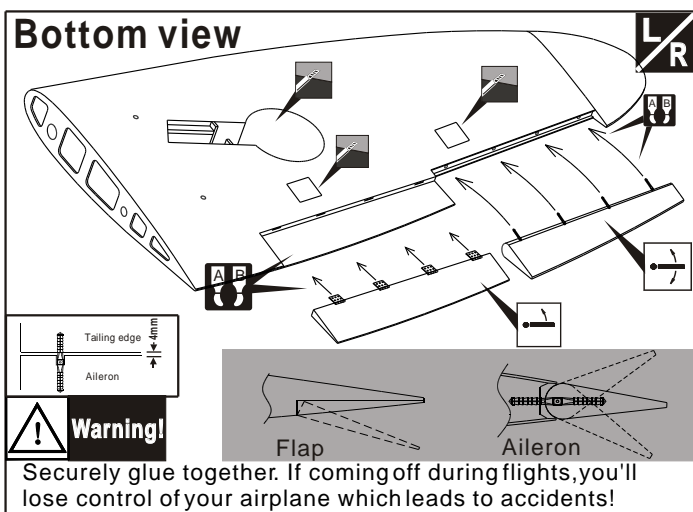

5 Install the servo of flap

L/R

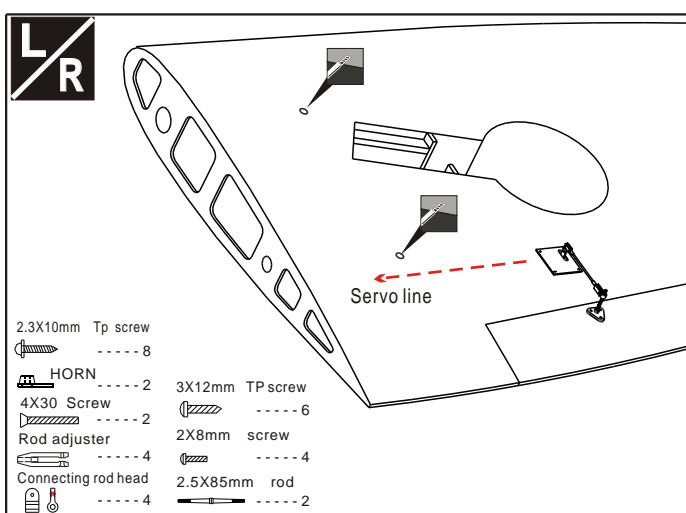



Accessory list for this page.

| | |
|----------------|-----------------|
| Rod adjuster | 5X45mm Axletree |
| ----- 1 | ----- 2 |
| 2X8mm screw | 3X20mm Tp screw |
| ----- 1 | ----- 8 |
| Retainer | 5.2mm Collar |
| ----- 1 | ----- 2 |
| Rod (1.8X80mm) | 3X3mm screw |
| ----- 1 | ----- 2 |
| 900 Air line | 4X4mm screw |
| ----- 2 | ----- 2 |
| 4X55mm screw | Play wood |
| ----- 4 | ----- 2 |
| 4mm Washer | Play wood |
| ----- 4 | ----- 4 |

8

Install the main landing gear

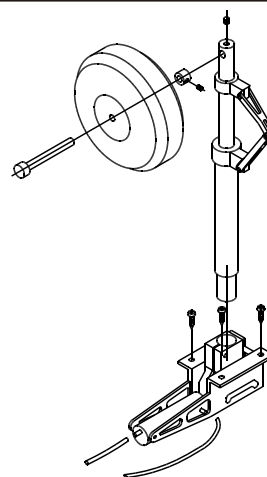

L
R

| |
|-----------------|
| 5X45mm Axletree |
| ----- 2 |
| 3X20mm Tp screw |
| ----- 8 |
| 5.2mm Collar |
| ----- 2 |
| 3X3mm screw |
| ----- 2 |
| 4X4mm screw |
| ----- 2 |

6

Main wing installing(Bottom)

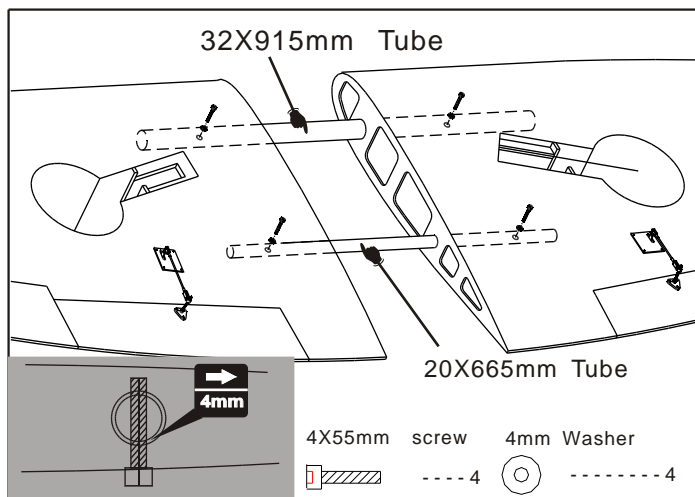

| | |
|--------------|------------|
| 4X55mm screw | 4mm Washer |
| ----- 4 | ----- 4 |

9

Install the main landing gear

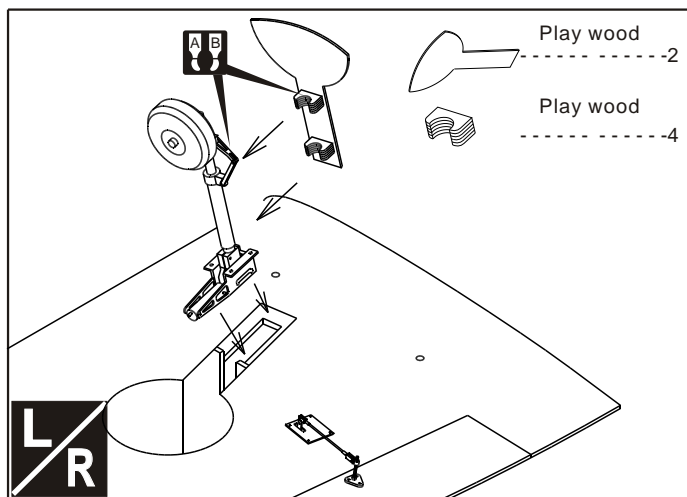

L
R

| |
|-----------|
| Play wood |
| ----- 2 |
| Play wood |
| ----- 4 |

7

Main wing installing(Top)

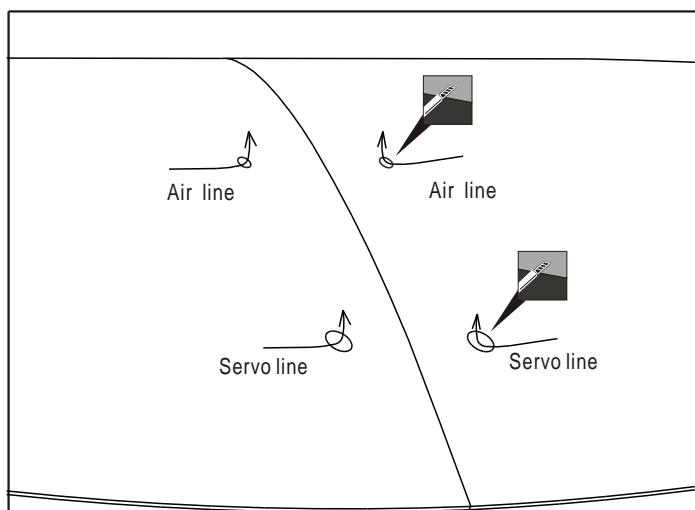

10

Install the main landing gear

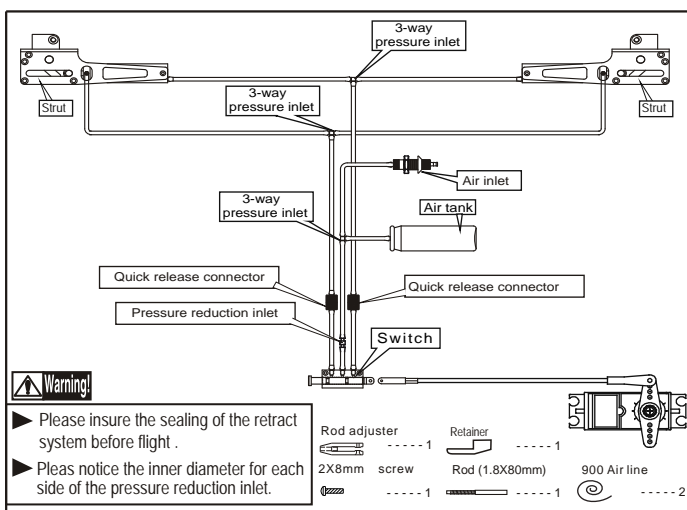

Warning!

- ▶ Please insure the sealing of the retract system before flight .
- ▶ Please notice the inner diameter for each side of the pressure reduction inlet.

| | |
|--------------|----------------|
| Rod adjuster | Retainer |
| ----- 1 | ----- 1 |
| 2X8mm screw | Rod (1.8X80mm) |
| ----- 1 | ----- 1 |
| | 900 Air line |
| | ----- 2 |



Accessory list for this page.

| | | | | |
|--|---------------------|---------|--------------|--------|
| | HORN | -----2 | 3X30mm screw | |
| | 4X40 Screw | -----2 | 2X8mm screw | -----6 |
| | Rod adjuster | -----2 | | -----4 |
| | Connecting rod head | -----4 | 2.5X85mm rod | |
| | Hinge | -----2 | | |
| | | -----10 | | |

13 Install the elevator servos

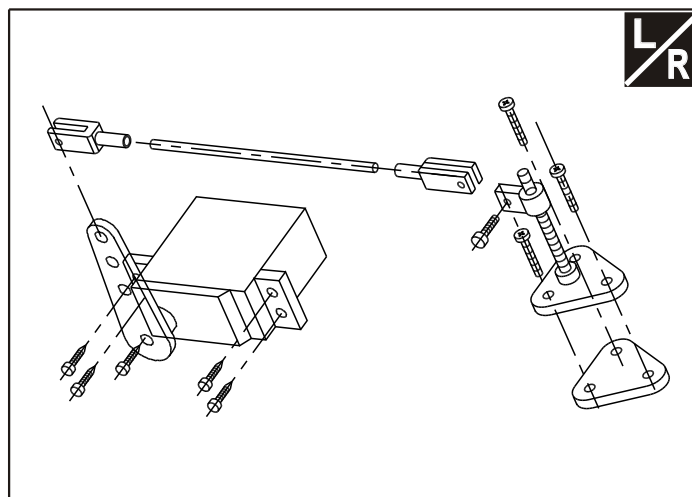

11 Install the elevator

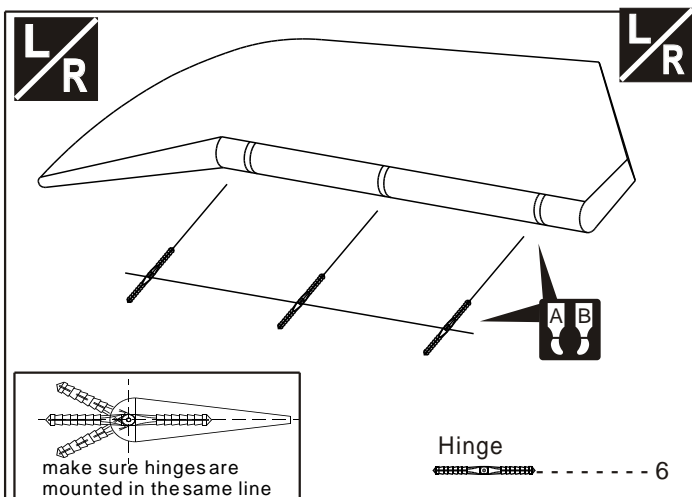

14 Install the elevator servos

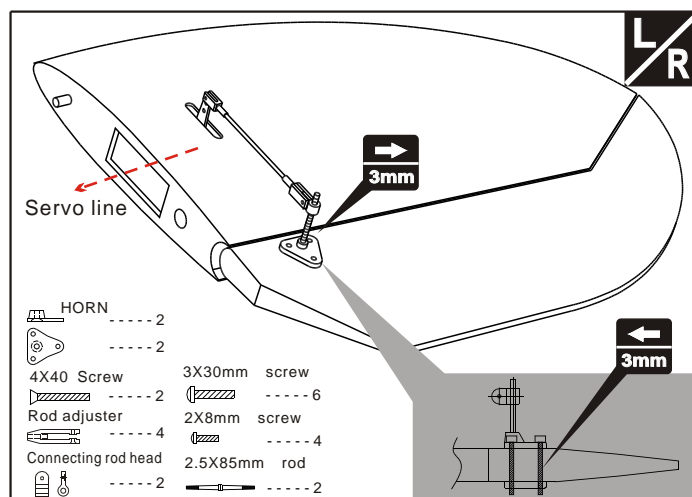

12 Install the elevator

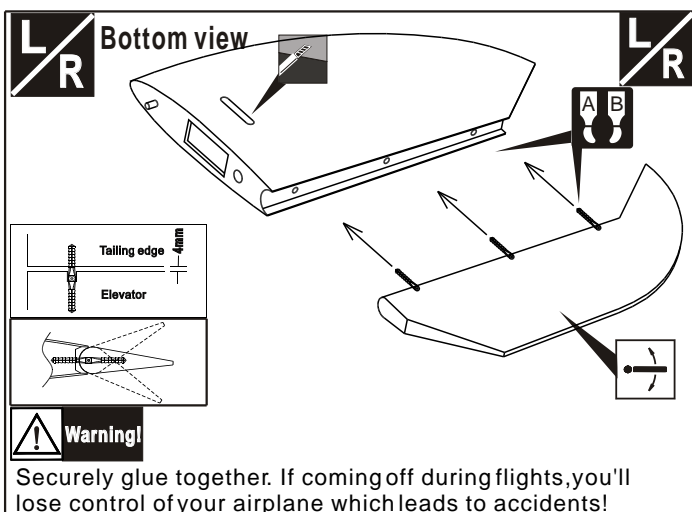

15 Install the rudder

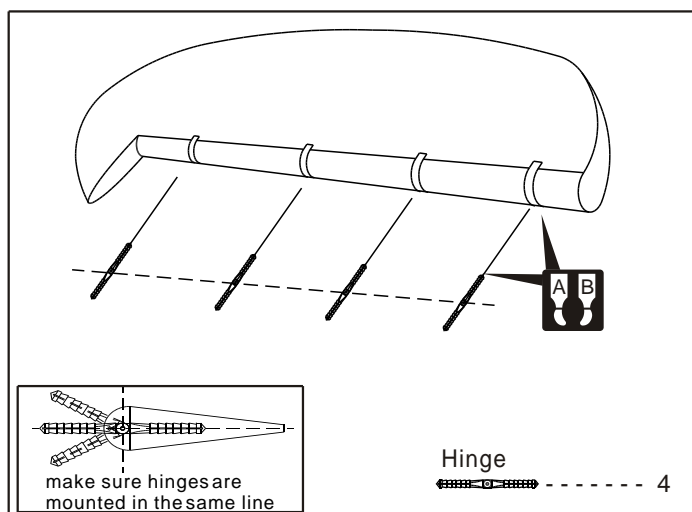



Accessory list for this page.

| | |
|-----------------------------|----------------------------|
| HORN ----- 2 | 6mm nut ----- 1 |
| 4X30 Screw ----- 2 | 6X9 screw ----- 1 |
| Rod adjuster ----- 4 | 3X3mm Screw ----- 2 |
| Connecting rod head ----- 4 | 3.2mm Nylon Collar ----- 2 |
| Rod ----- 4 | 3.2mm Collar ----- 2 |
| Aluminium tube ----- 4 | 3.2mm Rocker ----- 1 |
| 2X8mm screw ----- 2 | M3X20 Tp screw ----- 3 |
| 3mm nut ----- 6 | 3X35mm screw ----- 1 |
| 3X45mm screw ----- 3 | 3X30mm screw ----- 1 |
| 800mm Steel wire ----- 2 | |
| 80mm spring ----- 2 | |

18 Install the servo of rudder&tail wheel

| |
|----------------------------|
| 6mm nut ----- 1 |
| 6X9 screw ----- 1 |
| 3X3mm Screw ----- 2 |
| 3.2mm Nylon Collar ----- 2 |
| 3.2mm Collar ----- 1 |
| 3.2mm Rocker ----- 1 |
| M3X20 Tp screw ----- 3 |
| 3X35mm screw ----- 1 |
| 3X30mm screw ----- 1 |

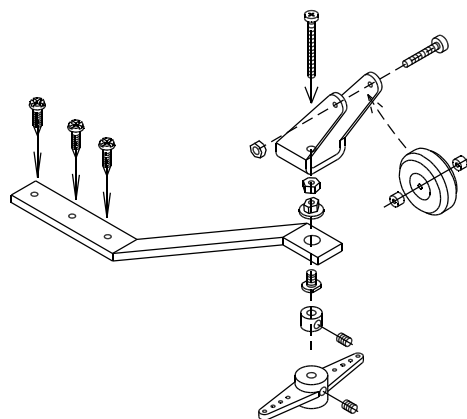

16 Install the rudder

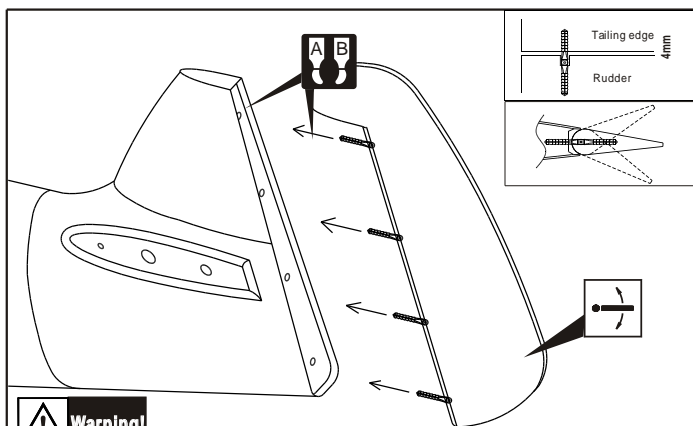

Warning!
Securely glue together. If coming off during flights, you'll lose control of your airplane which leads to accidents!

19 Install the servo of rudder&tail wheel

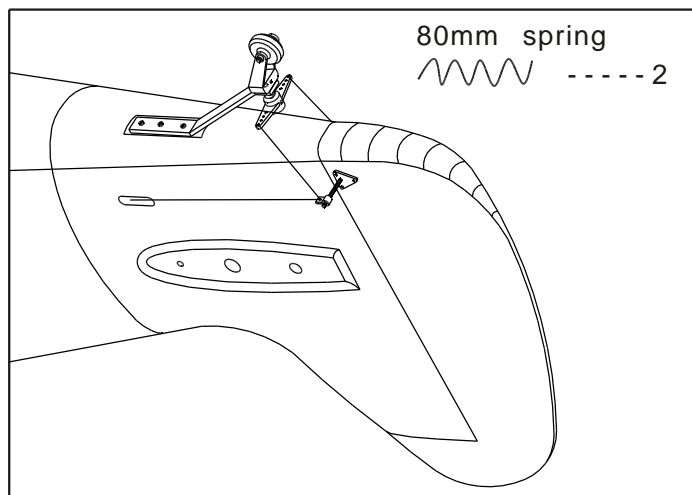

17 Install the servo of rudder&tail wheel

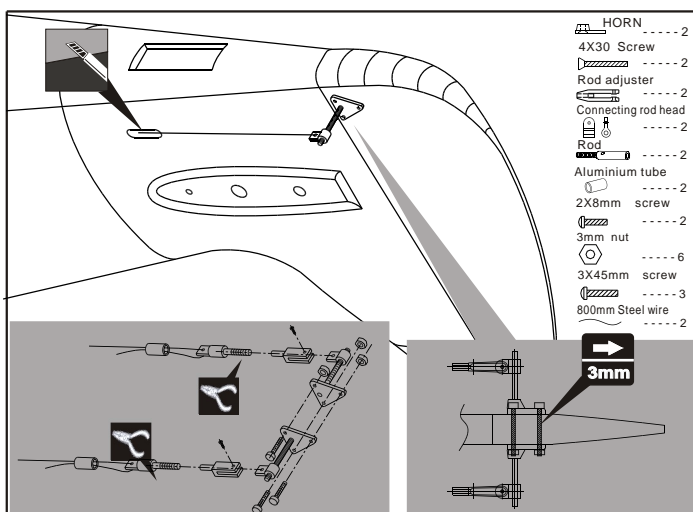

20 Install the servo of rudder&tail wheel

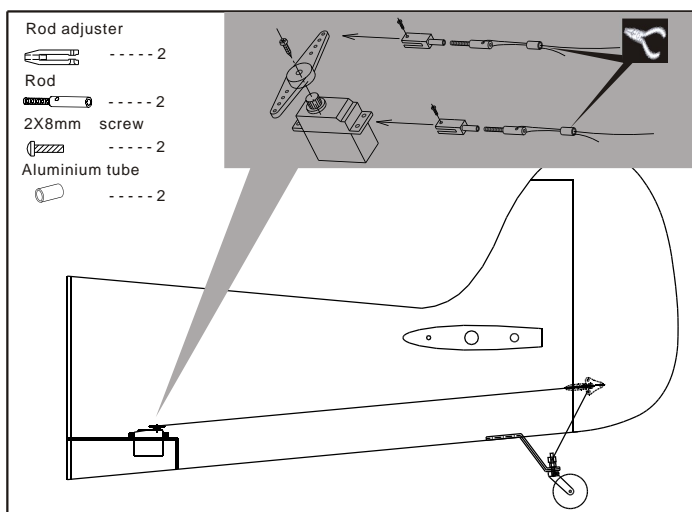



Accessory list for this page.

5X45mm screw

----- 2

8X50mm Carbon tube

----- 2

5mm Bind nut

----- 2

5mm Washer

----- 6

4X20mm screw

----- 2

4mm Washer

----- 2

5X30mm screw

----- 4

23 Main wing installing

5X45mm screw

----- 2

8X50mm Carbon tube

----- 2

5mm Bind nut

----- 2

5mm Washer

----- 2

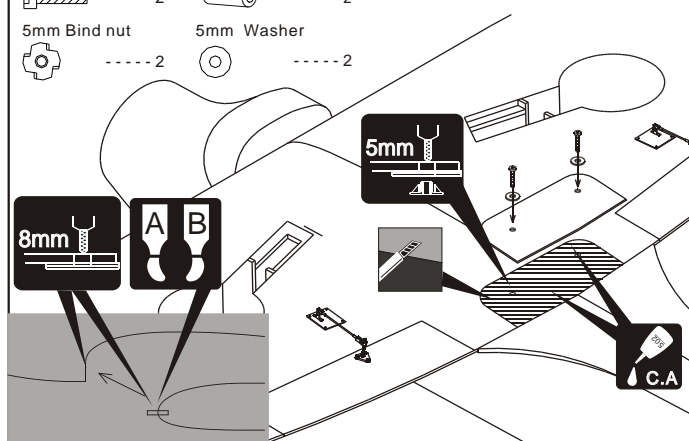

21 Horizontal (Put the servo into the fuselage)

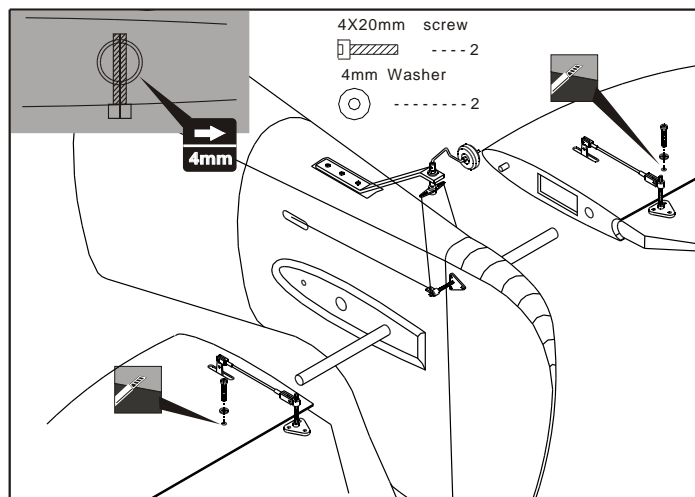

24 Main wing&Horizontal/Vertical tail

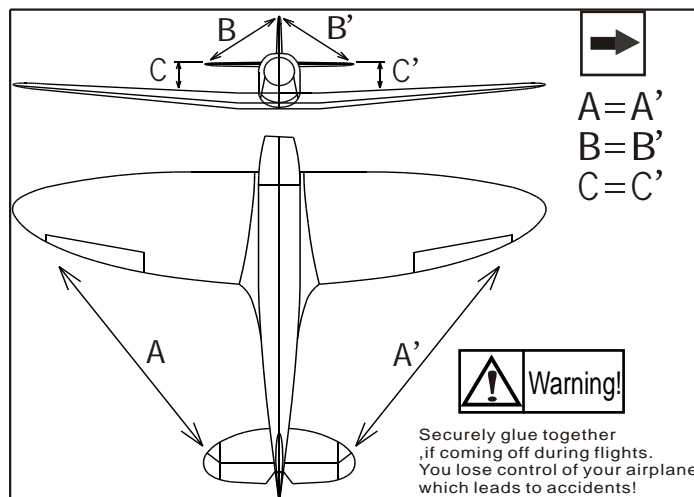

22 Fuselage installing

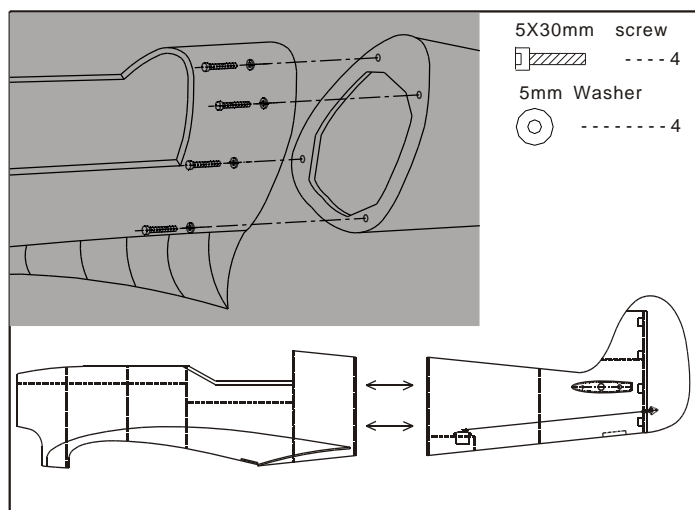



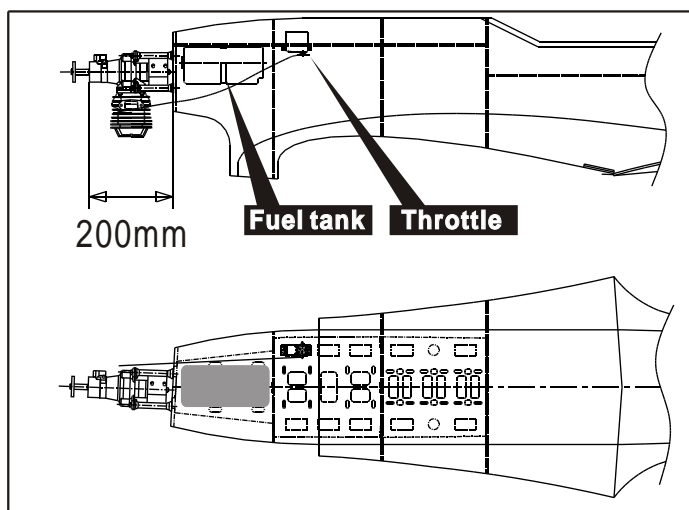





25 Installing the engine (85-100cc)





Accessory list for this page.

| | |
|---|---|
| 3X16mm screw | 1.8X450mm Rod |
|  ----- 6 |  ----- 1 |
| 3mm Bind nut | Linkage Stopper |
|  ----- 6 |  ----- 1 |
| 3mm Washer | 2mm Nut |
|  ----- 6 |  ----- 1 |
| 3mm rubber band | 3X3mm Screw |
|  ----- 6 |  ----- 1 |
| 6mm Playwood | |
|  ----- 6 | |

28 Radio Equipment

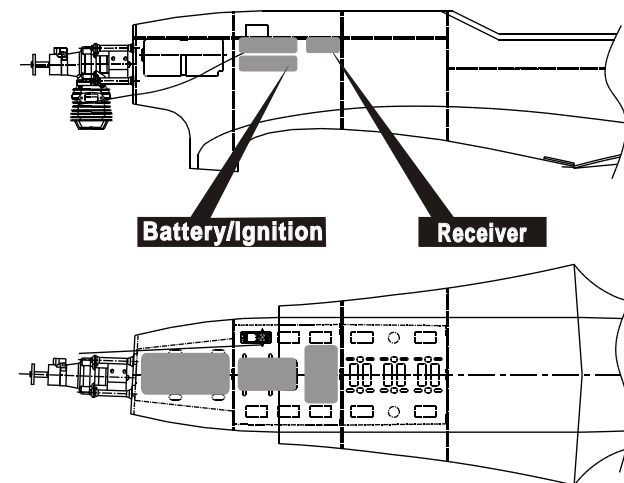

26 Install the throttle servo

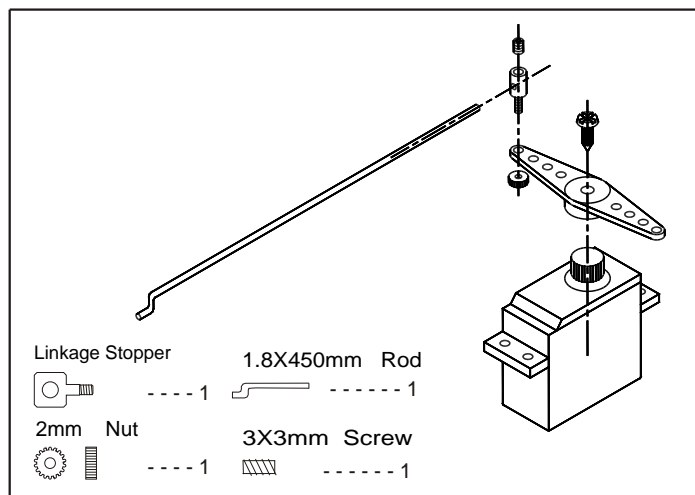

29 Install the thr cowling

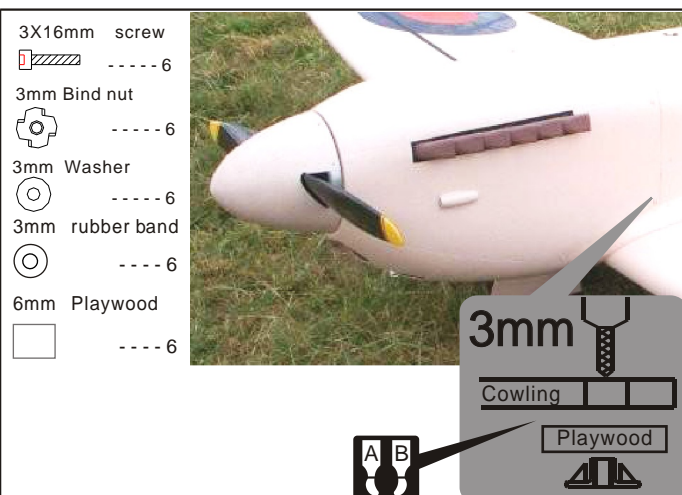

27 Assembly of the full tank

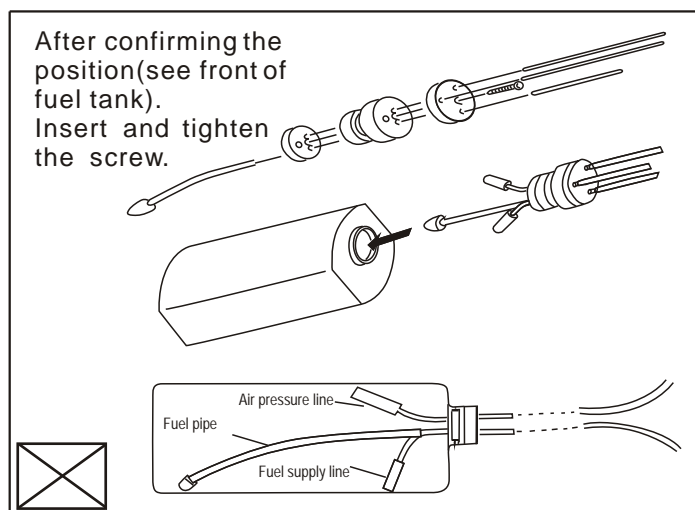

30 Install the thr cowling

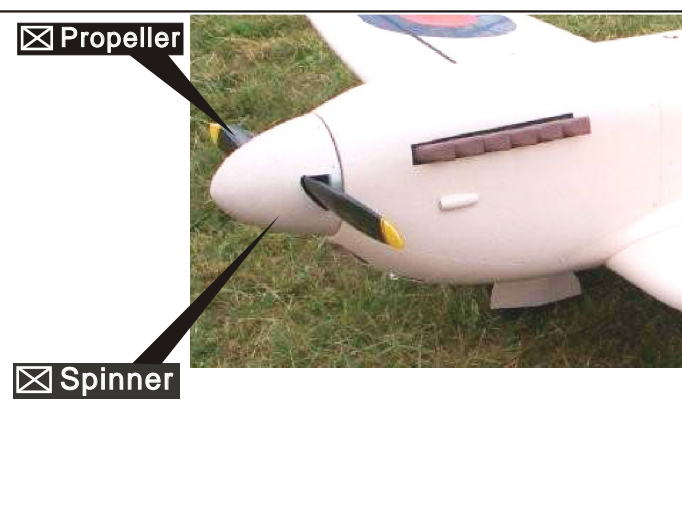



Accessory list for this page.

2.3X10Tp screw



----- 6

33 Install the canopy

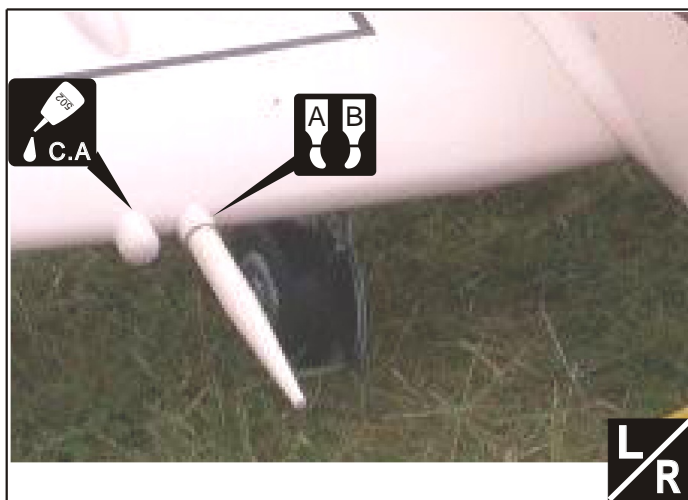

31 Install the canopy

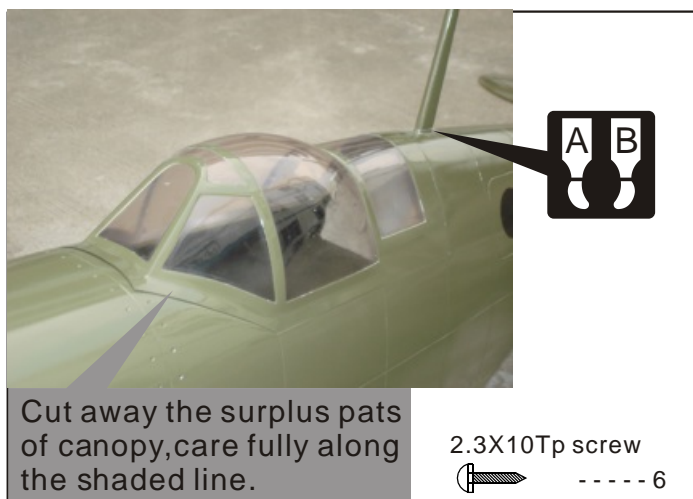

34 Install the canopy

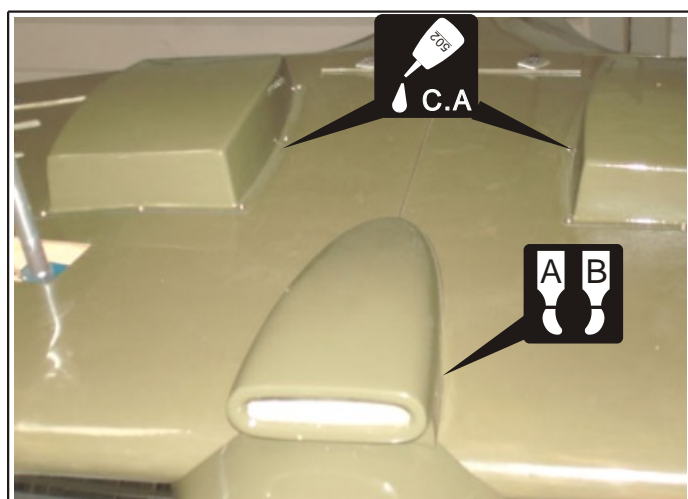

32 Install the canopy



35 Install the canopy

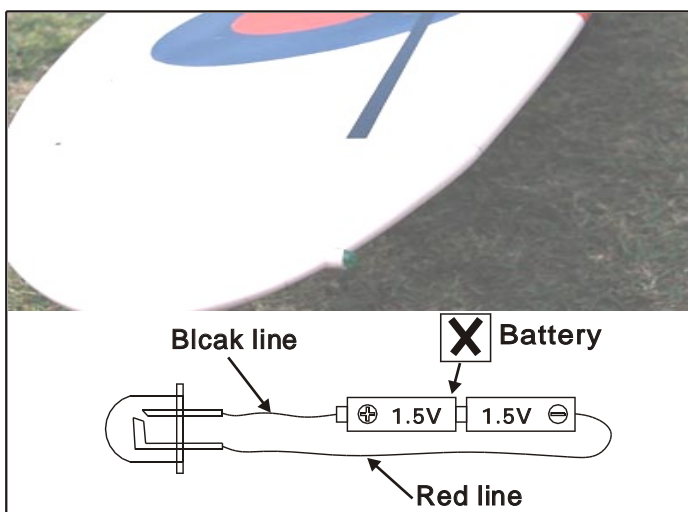

36 Adjustment.

Adjust the travel of each control surface to the values in the diagrams.
These values fit general flight capabilities.
Readjust according to your needs and flight level.

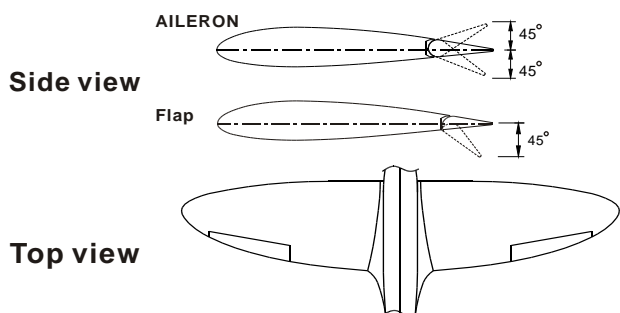

38 Adjustment

Adjust the travel of each control surface to the values in the diagrams.
These values fit general flight capabilities.
Readjust according to your needs and flight level.

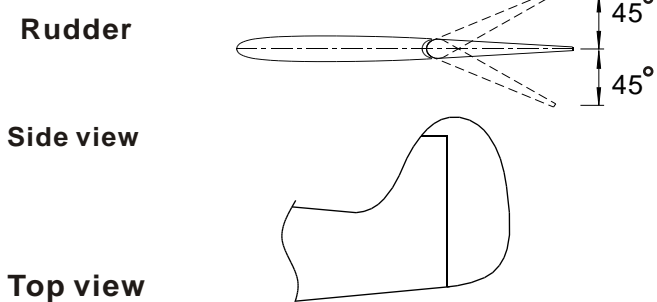

37 Adjustment.

Adjust the travel of each control surface to the values in the diagrams.
These values fit general flight capabilities.
Readjust according to your needs and flight level.

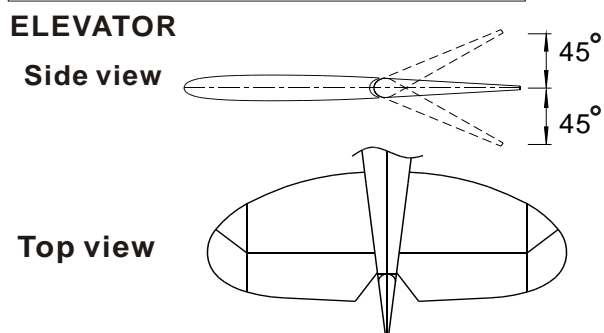

39 Adjustment.

Never fly before checking the Cg' s required position.
In order to obtain the CG specified ,reposition the receiver and battery.

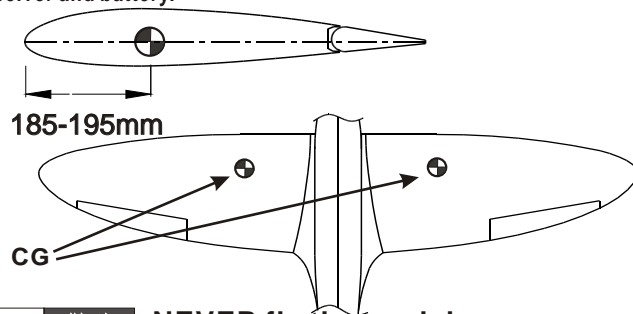

警告
Warning!

**NEVER fly the model
without well balancing.**