

Thank you for choosing CYmodel  
Global : [www.cymodel.com](http://www.cymodel.com)  
Australia : [www.austars-model.com](http://www.austars-model.com)  
Italia : [www.biellaexpress.com](http://www.biellaexpress.com)

# Fokker DR-1

Item Nr: CY8119C



## Instruction Manual

Before commencing assembly, please read these instructions thoroughly.

**ALMOST - READY - TO - FLY**



Warning!

### SAFETY PRECAUTIONS

**This radio control model is not a toy!**

- First-time builders should seek advice from people having building experience in order to assemble the model correctly and to produce its performance to full extent.
- Assemble this kit only in places out of children's reach!
- Take enough safety precautions prior to operating this model.  
You are responsible for this model's assembly and safe operation!
- Always keep this instruction manual ready at hand for quick reference, even after completing the assembly.
- Could cause serious injury or even death

### SPECIFICATION

Wing Span: 2400mm (94.5in)  
Wing Area: 118.5dm<sup>2</sup> (1837sq.in)  
Total Length: 2070 mm (81.5 in)  
Engine :80-100cc gas engine  
Radio : 4 channels ,6 servos

## REQUIRED FOR OPERATION (Purchase separately)

- 1** A minimum 4channel radio for airplanes (with 6 servos).  
And dry batteries.



**CAUTION:** Only use a minimum 4channel radio for airplanes! (No other radio may be used!)

A minimum 6 channel transmitter for airplanes.



12 AA-size Batteries

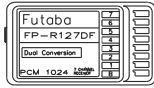

receiver



remote control

For handling the radio properly, refer to its instruction manual.

- 2** Battery (need 2)  Switch (need 2) 

- 3** Servo (need 6 servos) 

- 4** Engine and Muffler  
Model Airplane engine: 100-150cc gas engine





Muffler

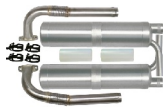

Muffler



- 5** Glue     
Epoxy Glue Instant glue

- 6** required for engine starting  **WARNING:** Normal gasoline cannot be used with glow engines. 



Fuel Pump



Plug Wrench

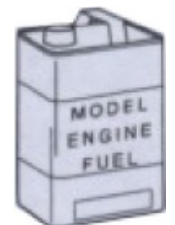

- 7** Silicone Tube  Fuel Filter 

- 8** Other equipment for enhancing airplane operation & performance

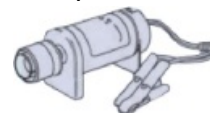

Engine Starter

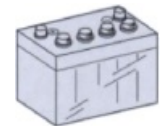

12V Battery (for starter)

- 9** Purchase a propeller that will match your engine 

## TOOLS REQUIRED (Purchase separately)

Sharp Hobby Knife



Phillips Screw Driver



Awl



Needle Nose Pliers

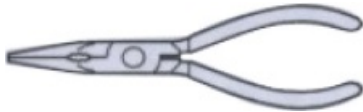

Wire Cutters



Scissors

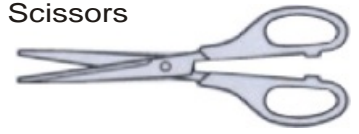

## BEFORE YOU BEGIN

1. Read through the manual before you begin, so you will have an overall idea of what to do.
2. Check all parts. If you find any defective or missing parts, contact your local dealer.
3. Symbols used throughout this instruction manual, comprise.



Apply epoxy glue.



Drill holes with the specified Diameter (here: 2mm)



Must be purchased separately!



Apply instant glue (CA glue, super glue).



Ensure smooth non-binding movement while assembling.



Pay close attention here!



Assemble left and right Sides the same way.



Cut off shaded portion.



Cut off excess.

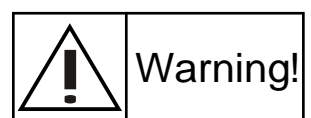

Do not overlook this symbol.



## Accessory list for this page.

Connecting rod head

----- 2

2.5X85mm rod

----- 2

2X8mm screw

----- 4

4X30mm screw

----- 2

4mm Washer

----- 2

Hinge

----- 8

HORN

----- 2

----- 2

4X30 Screw

----- 2

Rod adjuster

----- 4

2.6X12mm Tp screw

----- 8

3X25mm screw

----- 6

# 3

## Install the servo

L/R

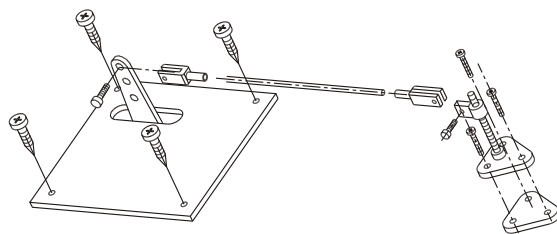
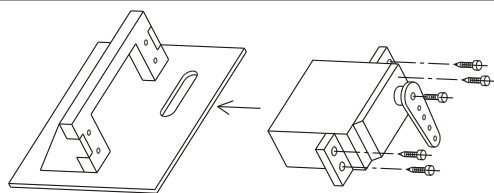

# 1

## Install the aileron

L/R

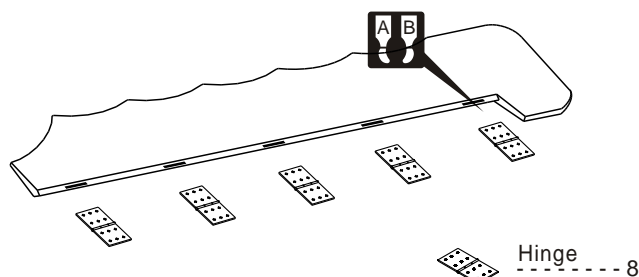
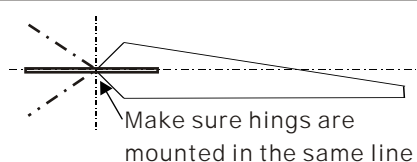

# 4

## Install the servo of aileron

L/R

Top wing  
Bottom view

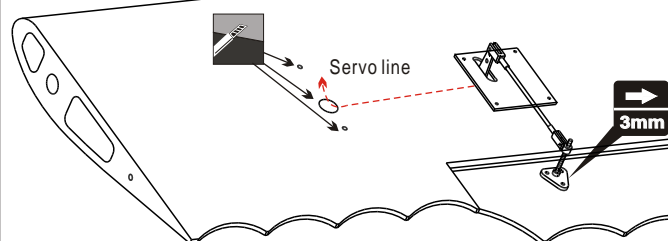

Connecting rod head ----- 2  
2.5X85mm rod ----- 2  
2.6X12mm Tp screw ----- 8  
3X25mm screw ----- 6  
2X8mm screw ----- 4  
HORN ----- 2  
4X30 Screw ----- 2  
Rod adjuster ----- 4

# 2

## Install the aileron

L/R

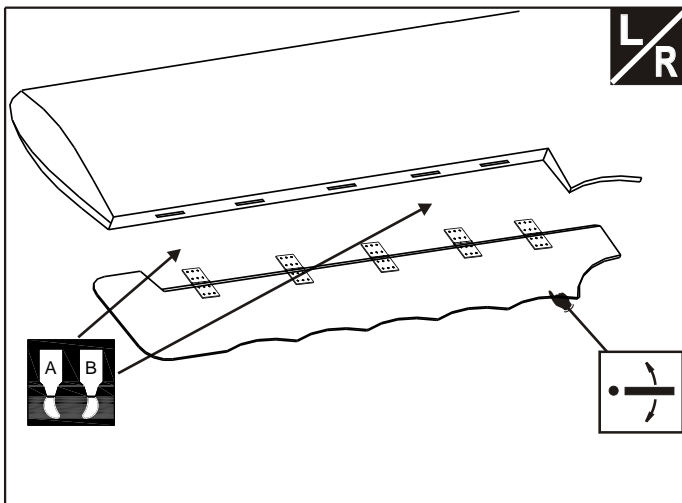

# 5

## Top wing

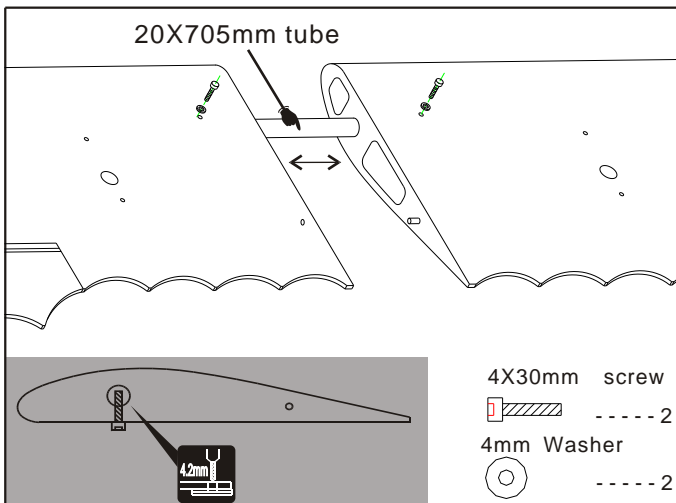

4X30mm screw ----- 2  
4mm Washer ----- 2



## Accessory list for this page.

4X30mm screw



----- 4

4mm Washer



----- 4

Hinge



----- 8

# 8

## Install the elevator

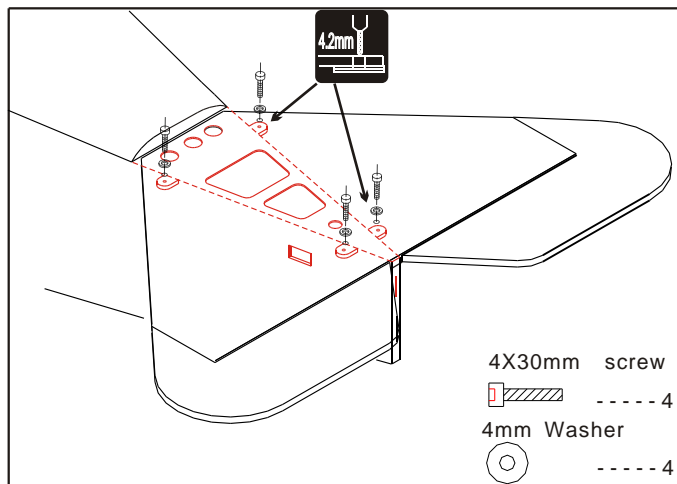

# 6

## Install the elevator

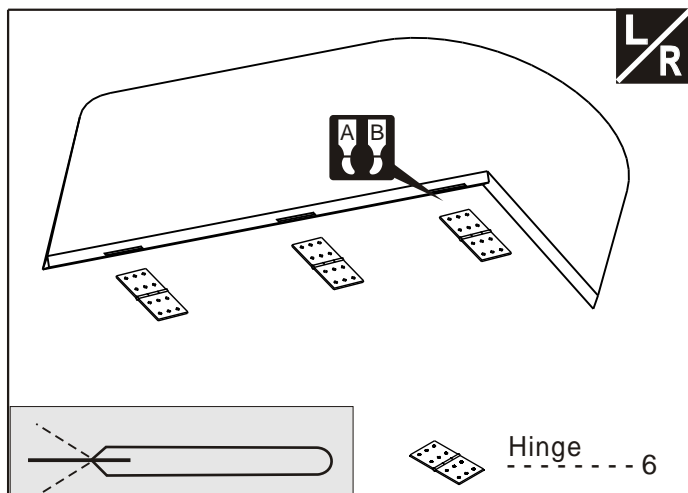

# 9

## Install the rudder

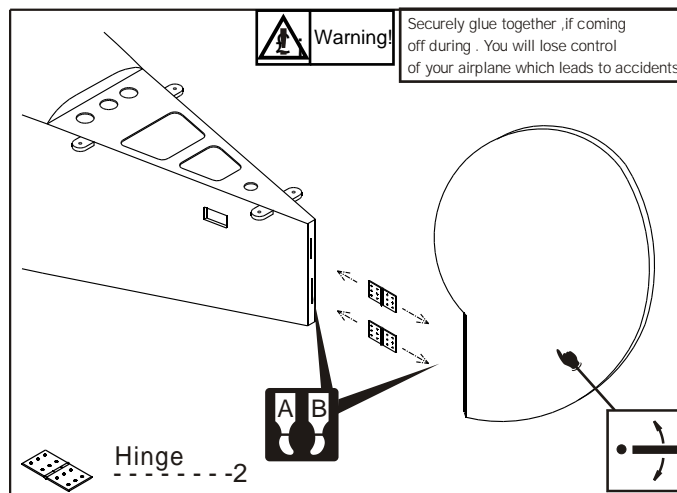

# 7

## Install the elevator

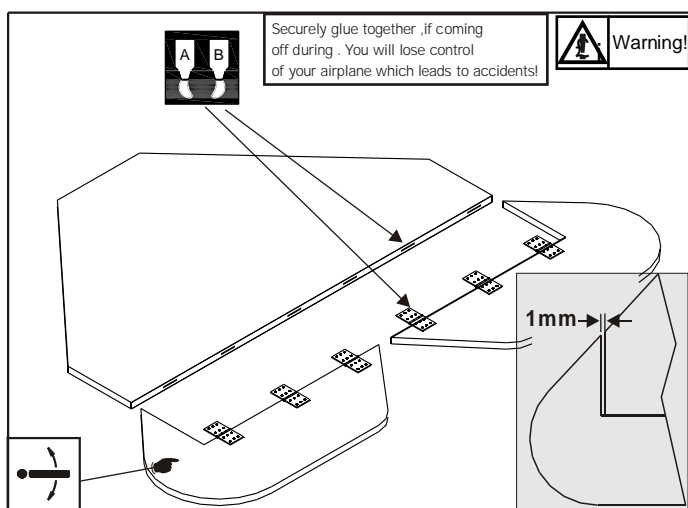

# 10

## Horizontal/Vertical tail

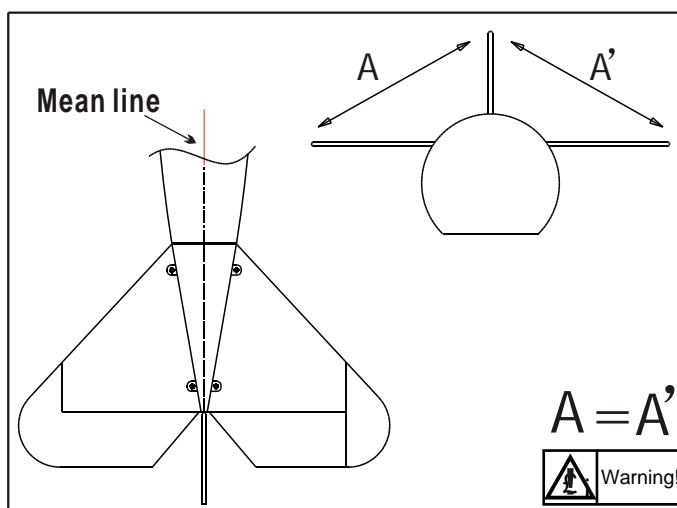





## Accessory list for this page.

HORN	----- 4	Rod	----- 4	5.2mm Collar	----- 2
4X30 Screw	----- 2	3mm Lock nut	----- 3	5.2mm Nylon collar	----- 2
Connecting rod head	----- 4	2X10mm screw	----- 4	3X3mm screw	----- 2
Rod adjuster	----- 4	1300mm Steel wire	----- 2	3X20mm Tp screw	----- 12
2.5X125mm rod	----- 8	Aluminium tube	----- 2	Pressure plate	----- 4
3X25mm screw	----- 2	2X10mm screw	----- 4		
3X25mm screw	----- 9	2X10mm screw	----- 8		

## 13 Install the tail pry

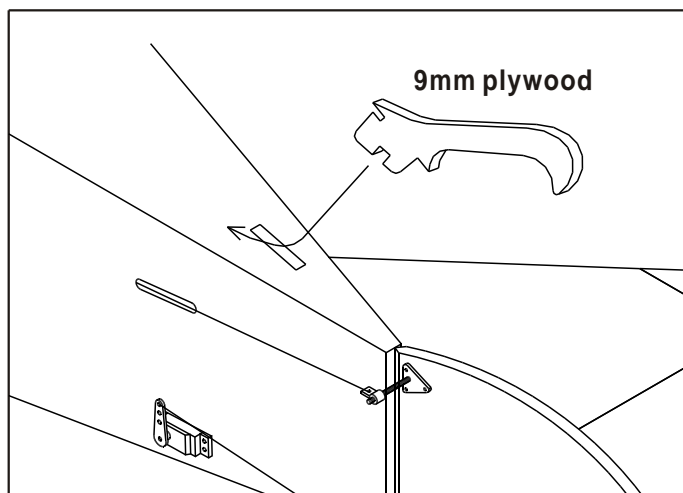

## 11 Install the rudder servo

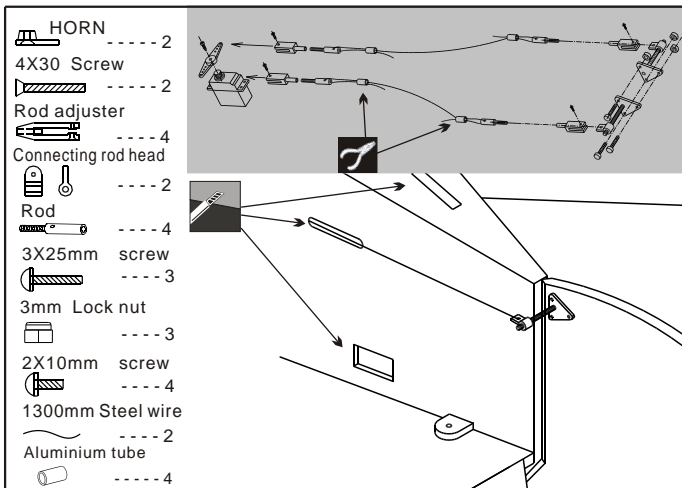

## 14 Install the main landing gear

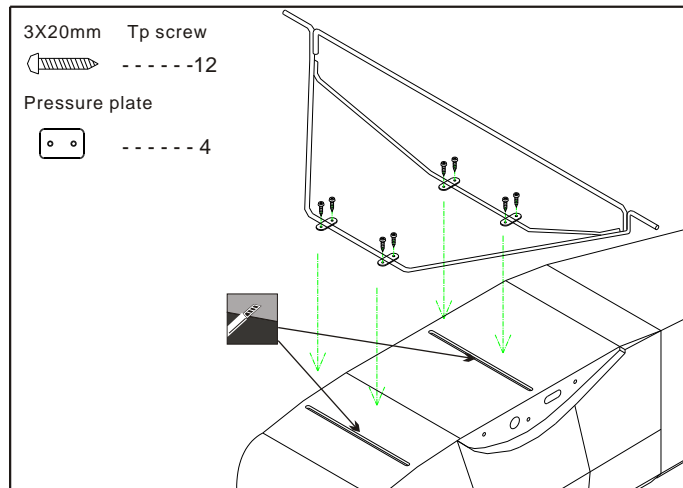

## 12 Install the elevator servo

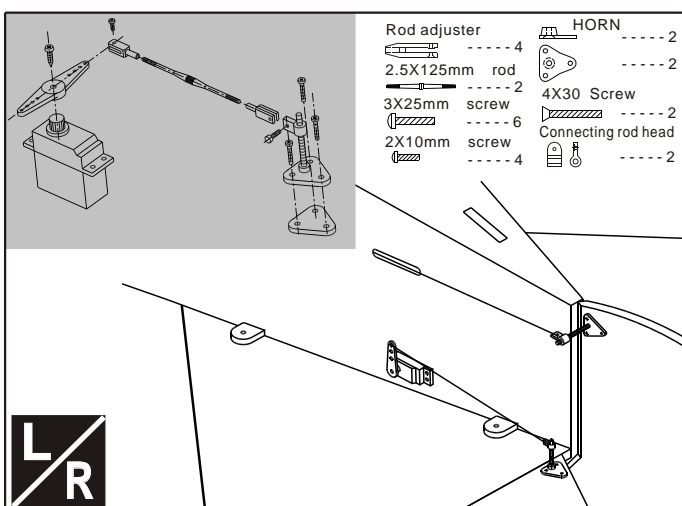

## 15 Install the main landing gear





## Accessory list for this page.

5X30mm screw	Pressure plate
----- 2	----- 2
5mm Washer	Pressure plate
----- 2	----- 3
4X55mm screw	3X20mm Tp screw
----- 2	----- 6
4X30mm screw	3X12mm Tp screw
----- 2	----- 4
4X16mm screw	4mm Washer
----- 2	----- 8
4mm Lock nut	
----- 2	

## 18 Install the middle wing

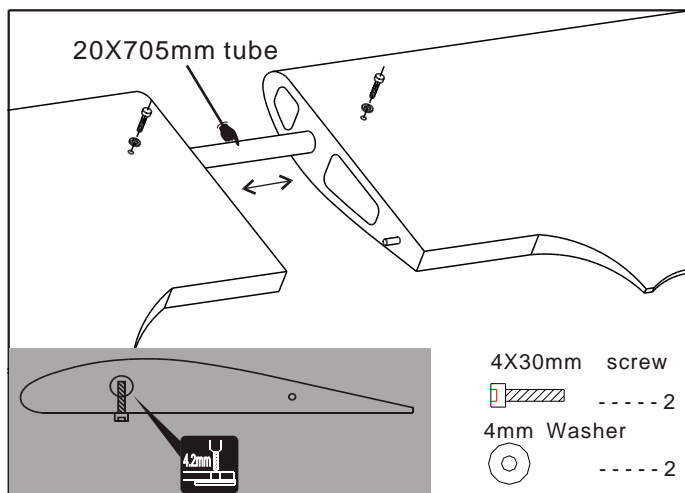

## 16

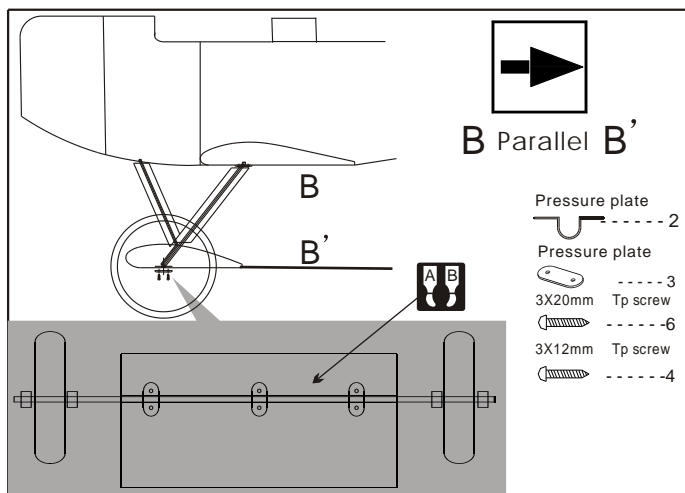

## 19 Install the middle wing

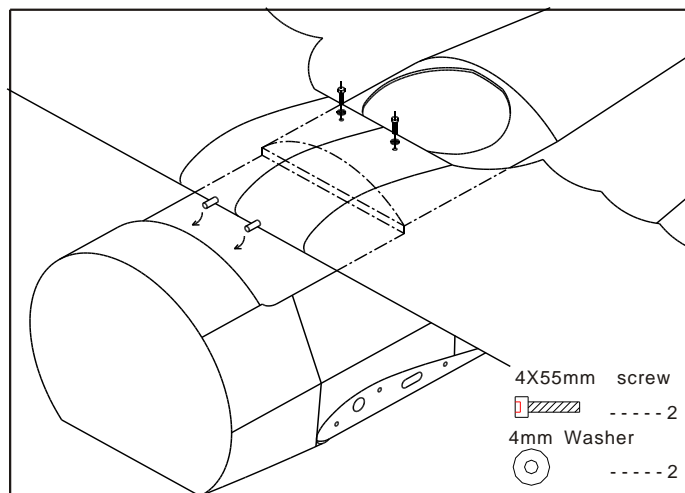

## 17 Install the below wing

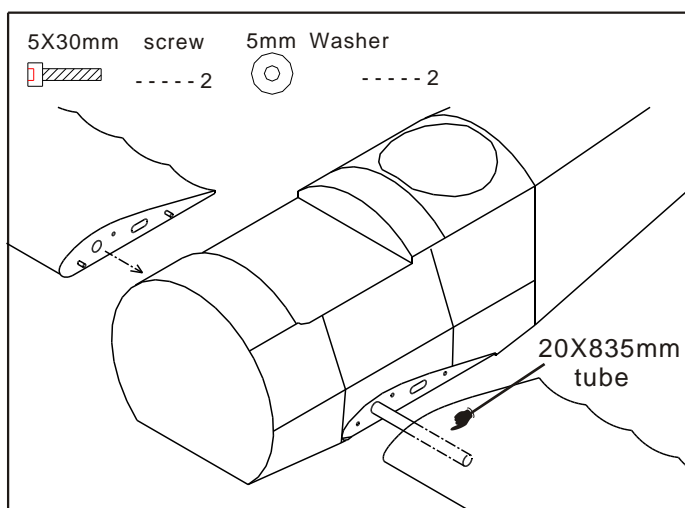

## 20 Install the wing support

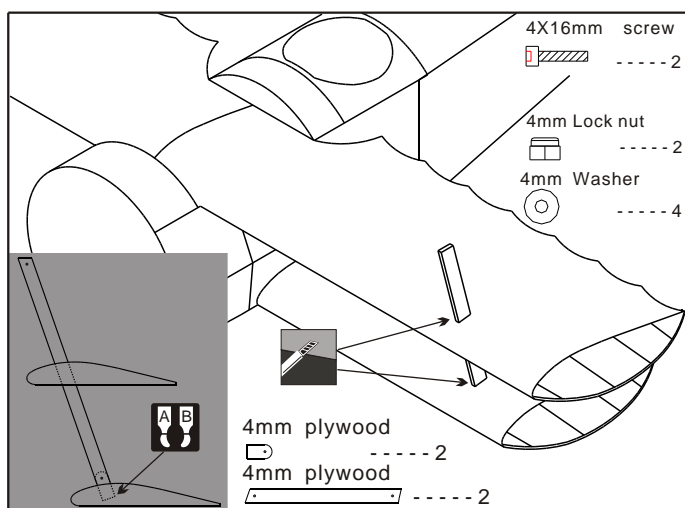



## Accessory list for this page.

3X20mm screw	3X3mm Screw
----- 12	----- 1
3X16mm screw	Linkage Stopper
----- 8	----- 1
3mm Lock nut	2mm Nut
----- 8	----- 1
4mm plywood	1.8X350mm Rod
----- 2	----- 1
4X16mm screw	4mm Washer
----- 2	----- 4
4mm Lock nut	
----- 2	

## 23 Assemble horizontal tail, tail gear separately

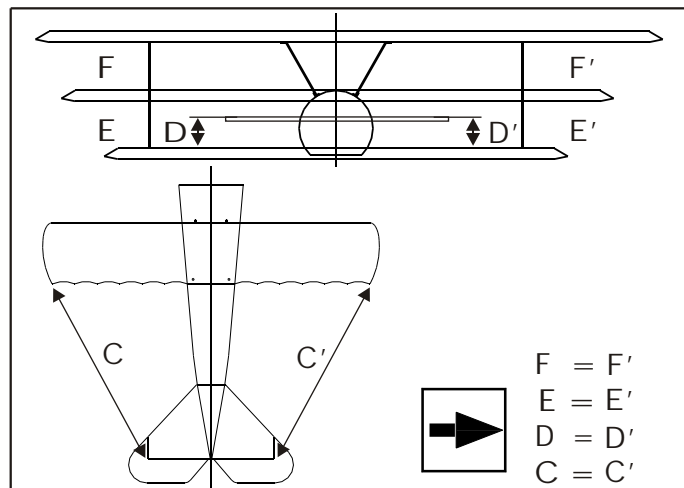

## 21 Install the top wing



## 24 Install the engine mount

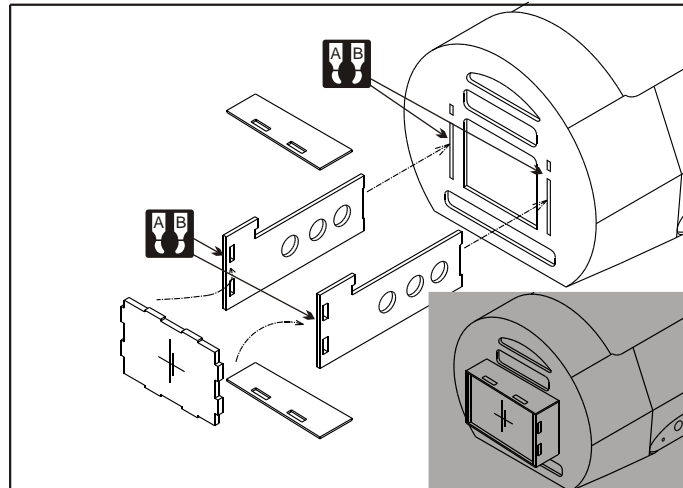

## 22 Install the top wing

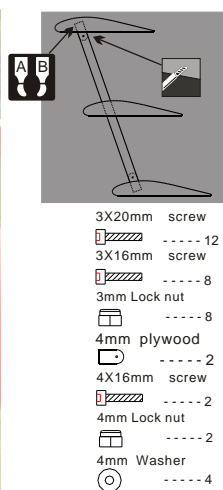

## 25 Install the engine

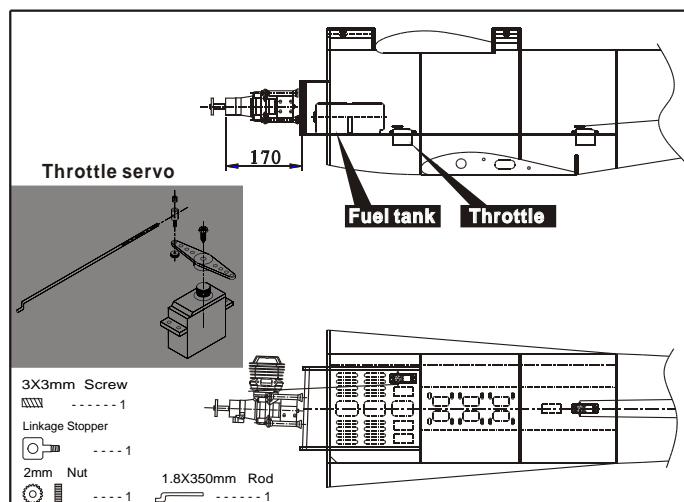



## Accessory list for this page.

3X25mm screw

 ----- 5

3X16mm screw

 ----- 5



3mm Washer

 ----- 7

3mm rubber gasket

 ----- 7

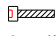
## 28 Install the cowling

3X16mm screw  
 ----- 5  
3mm Washer  
 ----- 5  
3mm rubber gasket  
 ----- 5



## 26 Assembly of the full tank

After confirming the position(see front of fuel tank). Insert and tighten the screw.

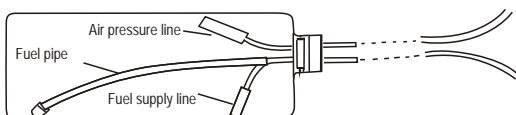
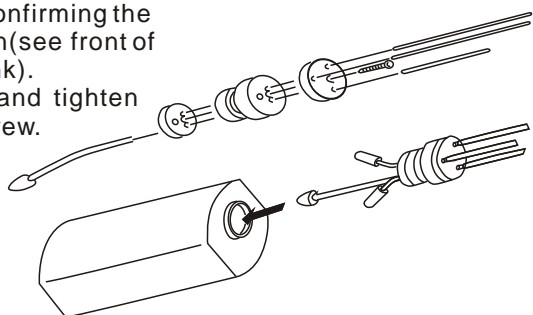

## 29 Install the canopy

Cut off the surplus part along the shaded area

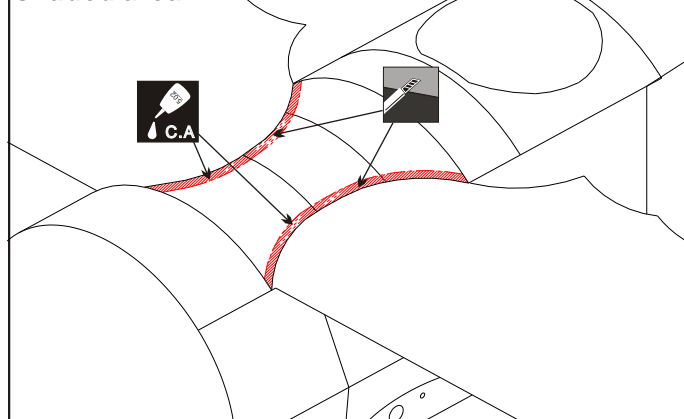

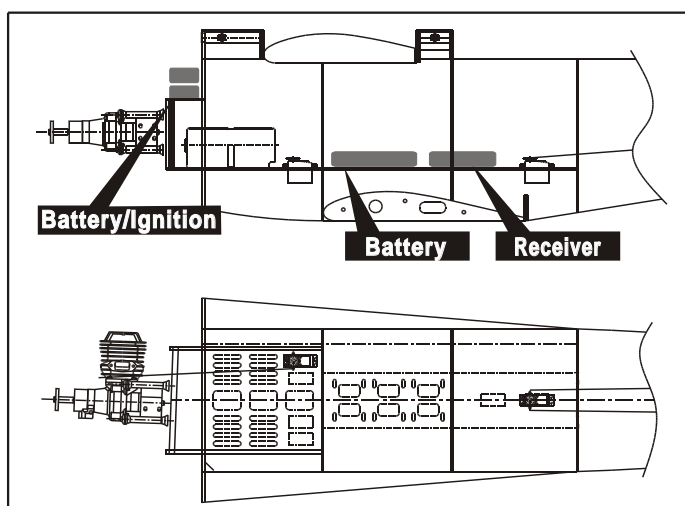

## 27 Radio Equipment



## 30 Install the canopy

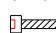

3X25mm screw  
 ----- 5  
3mm Washer  
 ----- 2  
3mm rubber gasket  
 ----- 2



## 31 Adjustment.

Adjust the travel of each control surface to the values in the diagrams.  
These values fit general flight capabilities.  
Readjust according to your needs and flight level.

### AILERON

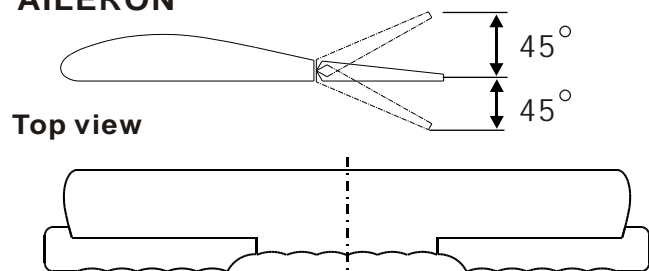

## 32 Adjustment.

Adjust the travel of each control surface to the values in the diagrams.  
These values fit general flight capabilities.  
Readjust according to your needs and flight level.

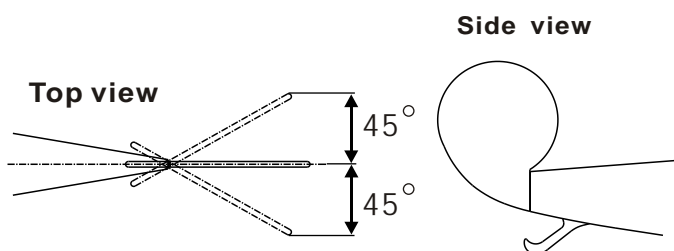

## 32 Adjustment.

Adjust the travel of each control surface to the values in the diagrams.  
These values fit general flight capabilities.  
Readjust according to your needs and flight level.

### Side view

### Top view

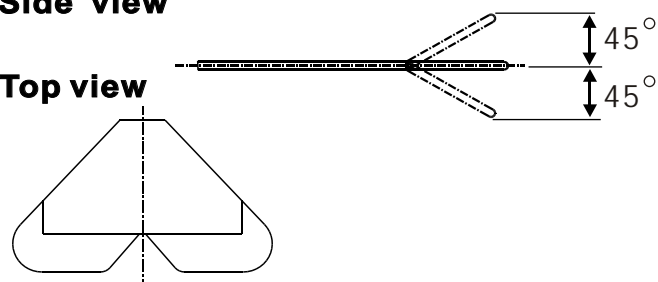

## 34 Centre of Gravity.

Never fly before checking the Cg' s required position.  
In order to obtain the CG specified ,reposition the receiver and battery.

