

Thank you for choosing CYmodel
Global : www.cymodel.com
Australia : www.austars-model.com
Italia : www.biellaexpress.com

Grumman TBF Avenger

Item Nr: CY8071B



Instruction Manual

Before commencing assembly, please read these instructions thoroughly.



Warning!

SAFETY PRECAUTIONS

This radio control model is not a toy!

- First-time builders should seek advice from people having building experience in order to assemble the model correctly and to produce its performance to full extent.
- Assemble this kit only in places out of children's reach!
- Take enough safety precautions prior to operating this model.
You are responsible for this model's assembly and safe operation!
- Always keep this instruction manual ready at hand for quick reference, even after completing the assembly.
- Could cause serious injury or even death

SPECIFICATION

Wing span.....2500mm(98.5in)
Wing area.....94 dm²(1457sq.in)
Empty weight.....7.4kg
Total length.....1850mm(72.8in)
Engine.....80-100cc gas engine
Radio.....7 channels 10 servos

REQUIRED FOR OPERATION (Purchase separately)

- 1** A minimum 6 channel radio for airplanes (with 10 servos).
And dry batteries.



CAUTION: Only use a minimum 6 channel radio for airplanes! (No other radio may be used!)

A minimum 6 channel
transmitter for airplanes.



12 AA-size Batteries



For handing the radio properly, refer to its instruction manual.

- 2** Engine and Muffler
Model Airplane engine
80-100 cc gas engine



Muffler

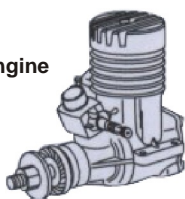

Glow plug

- 3** Propeller splinner

Purchase a propeller that
will match your engine



- 4** Silicone Tube  Fuel Filter 

- 5** required for engine starting Glow engine fuel only.



WARNING: Normal gasoline cannot
be used with glow engines.



Fuel Pump

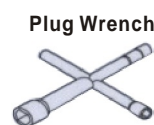

Plug Wrench

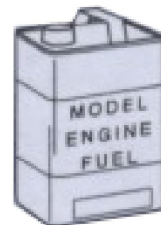

- 6** Glue  Instant glue  Epoxy Glue

TOOLS REQUIRED (Purchase separately)

Sharp Hobby Knife



Phillips Screw Driver



Awl



Needle Nose Pliers

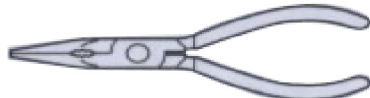

Wire Cutters



Scissors

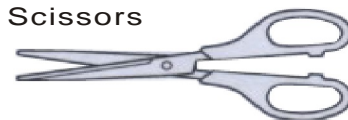

BEFORE YOU BEGIN

- 1** . Read through the manual before you begin ,so you will have an overall idea of what to do.
- 2** . Check all parts .if you find any defective or missing parts .contact your local dealer.
- 3** . Symbols used throughout this instruction manual,comprise.



Apply epoxy glue.



Drill holes with the specified
Diameter(here:2mm)



Must be purchased
separately!



Apply instant glue
(CA glue,super glue).



Ensure smooth non-binding
movement while assembling.



Pay close attention
here!



Assemble left and right
Sides the same way.



Cut off shaded portion.



Cut off excess.

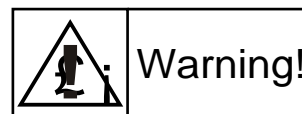









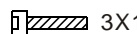

Warning!

Do not overlook this symbol.

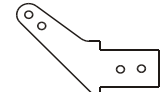
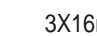
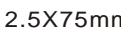

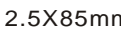
Accessory list for this page.

 Pin hinges ---16	 3mm washer -----12
 3mm Lock nut--12	 Rod adjuster -----6
 3X16 Screw --12	 Rod adjuster -----6
 HORN--12	 3X16mm Screw -----12
 2.5X75mm rod -----2	 Ball bearing -----6
 2.5X85mm rod -----4	 Ball bearing -----6

3

Install the servo

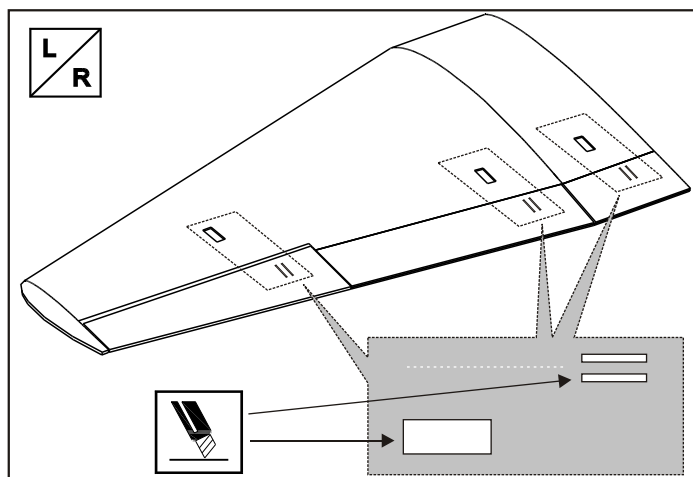

1

Install the aileron

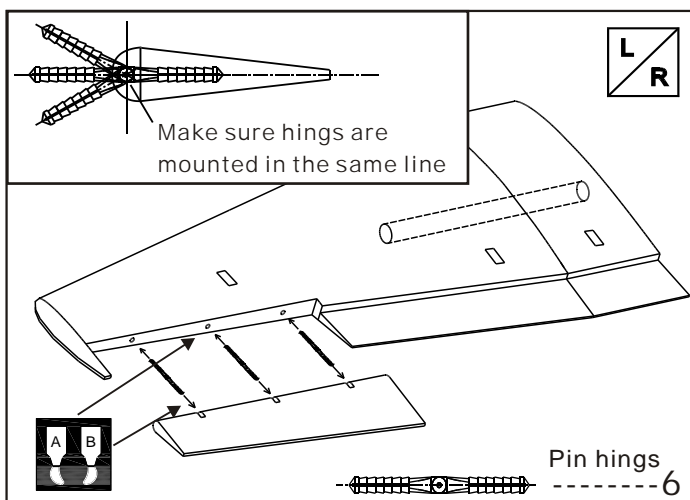

4

Install the nylon control horn and connect the linkage

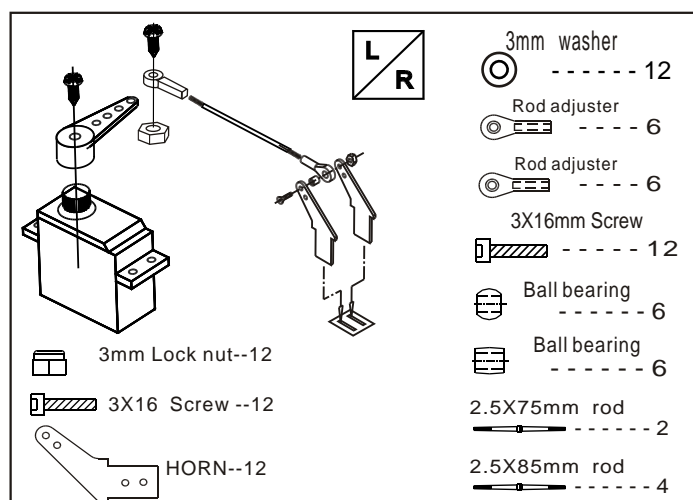

2

Install the flap

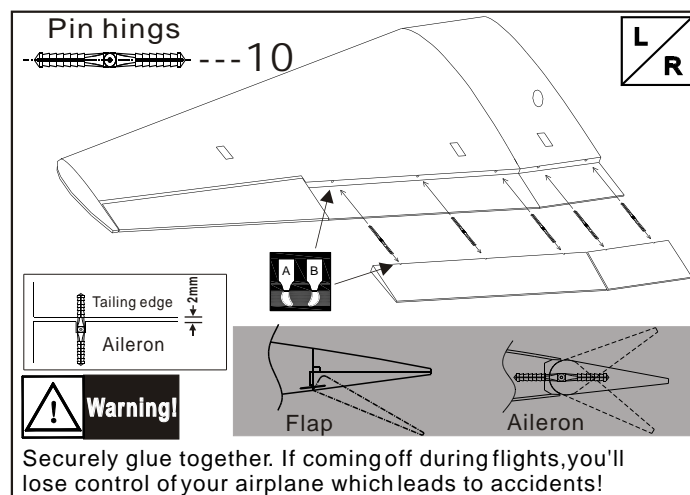

5

Install the nylon control horn and connect the linkage

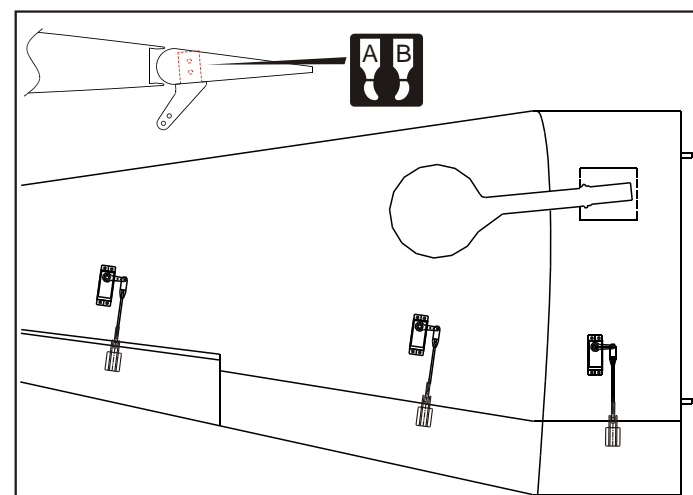



Accessory list for this page.

5X45mm Axletree

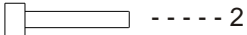

----- 2

3X20mm Tp screw

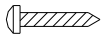

----- 8

5.2mm Collar



----- 2

3X3mm screw



----- 2

4X4mm screw



----- 2

Rod adjuster



----- 1

2X8mm screw



----- 1

Retainer



----- 1

Rod (1.8X80mm)



----- 1

2000mm Air line



----- 2

Pin hinges



----- 6

8

Install the main landing gear

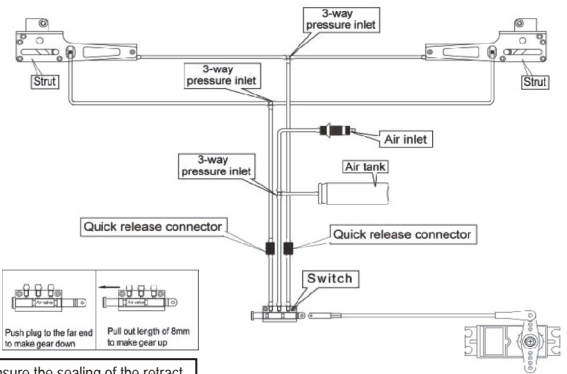

Warning!
Please insure the sealing of the retract system before flight.
Please notice the inner diameter for each side of the pressure reduction inlet.

Rod adjuster

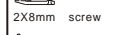

----- 1

2X8mm screw

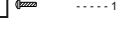

----- 1

Retainer



----- 1

Rod (1.8X80mm)



----- 1

2000mm Air line



----- 2

6

Install the landing gear

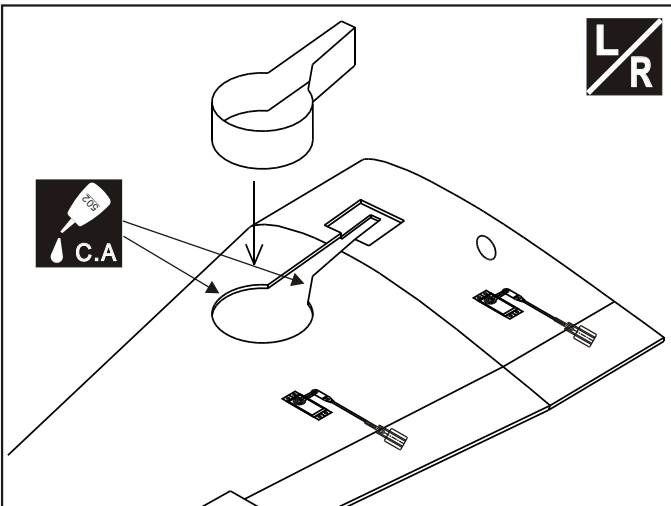

9

Epoxy pin hinges to elevator

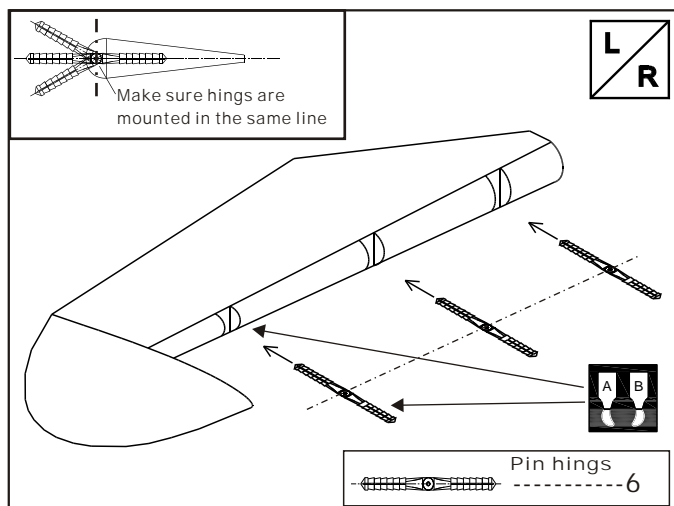

7

Install the main landing gear

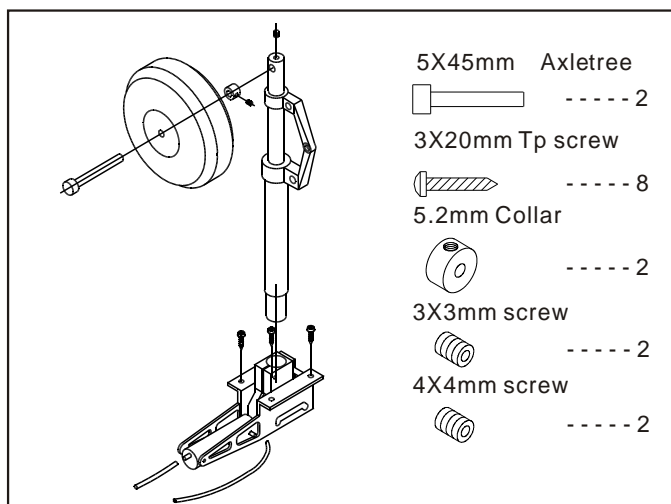

5X45mm Axletree

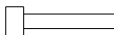

----- 2

3X20mm Tp screw



----- 8

5.2mm Collar



----- 2

3X3mm screw



----- 2

4X4mm screw



----- 2

10

Epoxy elevator hinges to horizontal tail

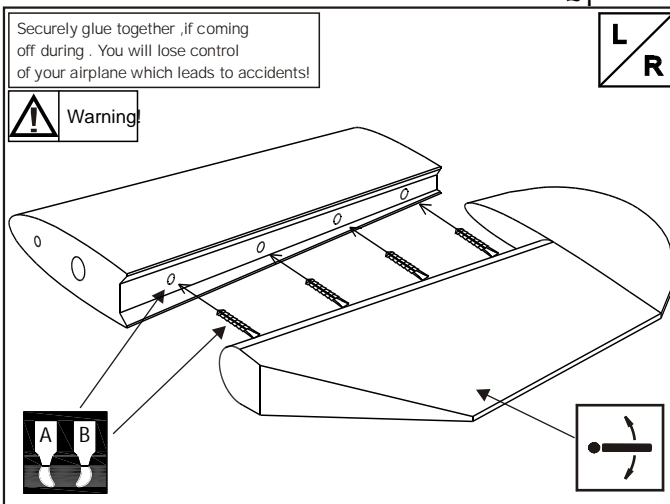



Accessory list for this page.



3mm Lock nut--4

3X3mm Screw

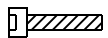

3X16 Screw --4



3.2mm Nylon Collar

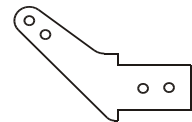

HORN--4



3.2mm Collar



Pin hinges



---3



---1

13

Epoxy pin hinges to rudder

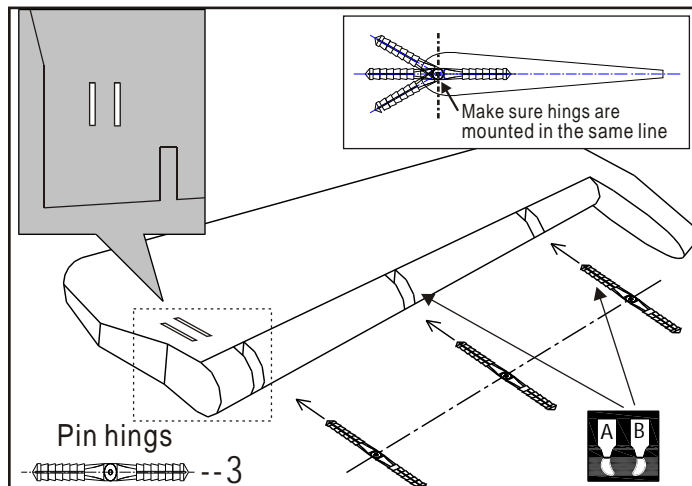

11

Install the elevator servos

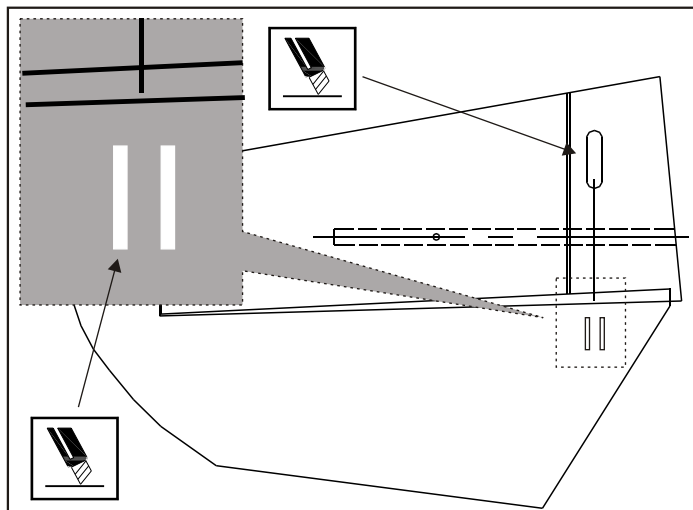

14

Epoxy pin hinges to rudder

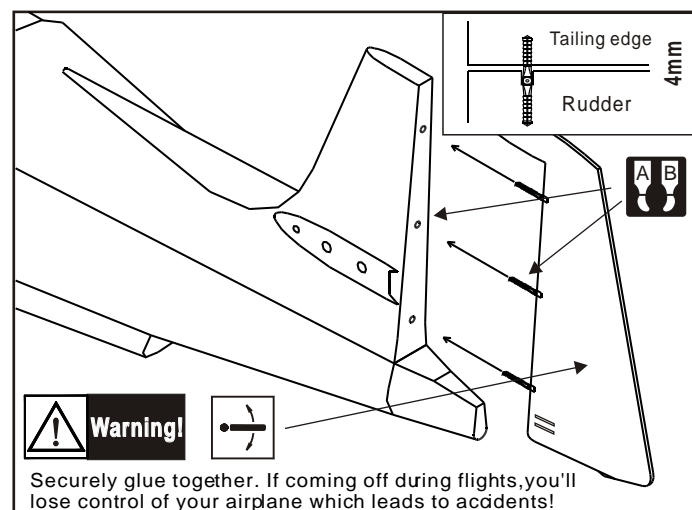

12

Install the elevator servos

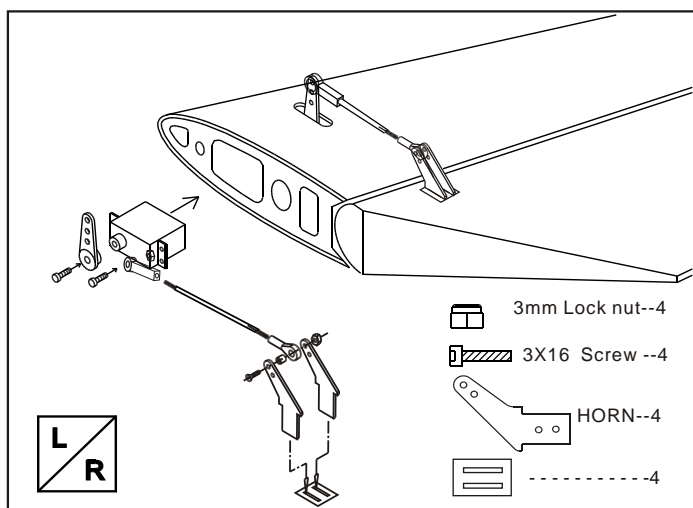

15

Install the tail wheel

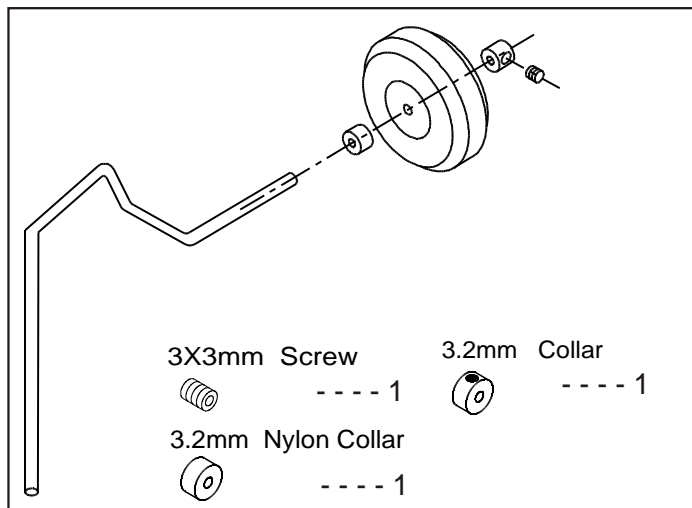



Accessory list for this page.

Rod	----- 4		----- 2
450mm Steel wire	----- 2	Rod adjuster	----- 2
Aluminium tube	----- 4	3mm Lock nut	----- 2
3X3mm Screw	----- 3	3X16 Screw	----- 2
3.2mm Rocker	----- 1	Steel wire	----- 2
3.2mm Collar	----- 3	HORN	----- 2
		Rod adjuster	----- 2

18 Engine Box Preparation

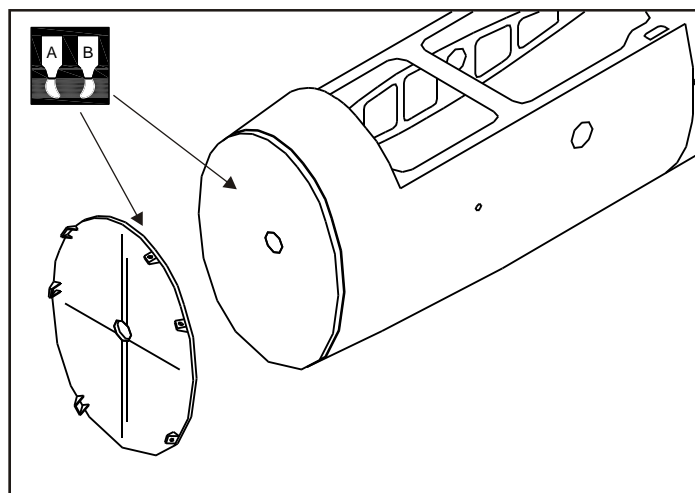

16 Install the tail wheel

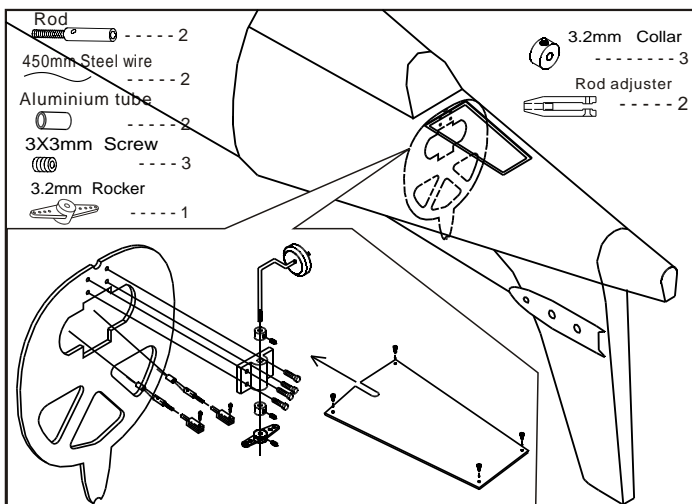

19 Install the engine

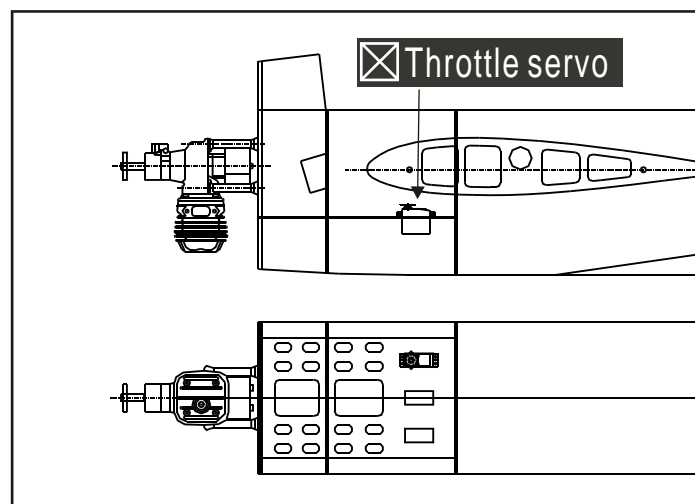

17 Rudder . Connect the linkage rod to the horn

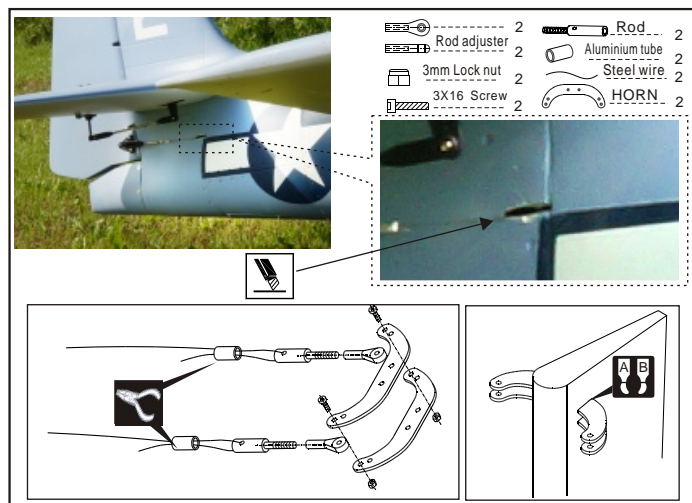

20 Assembly of the fuel tank

After confirming the position(see front of fuel tank). Insert and tighten the screw.

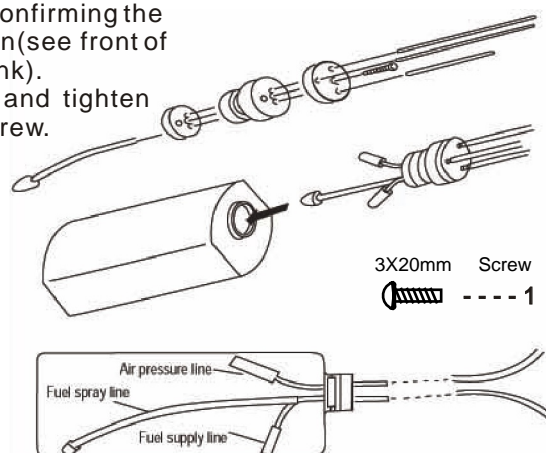



Accessory list for this page.

8mm nylon Nut

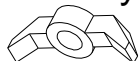

----- 4

Rod adjuster

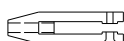

----- 2

M4X10mm screw

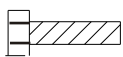

----- 2

2X8mm screw



----- 2

Aluminium tube



----- 2

M3X30mm screw

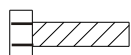

----- 4

Rod



----- 2

23

Assemble horizontal tail, vertical tail, tail gear separately

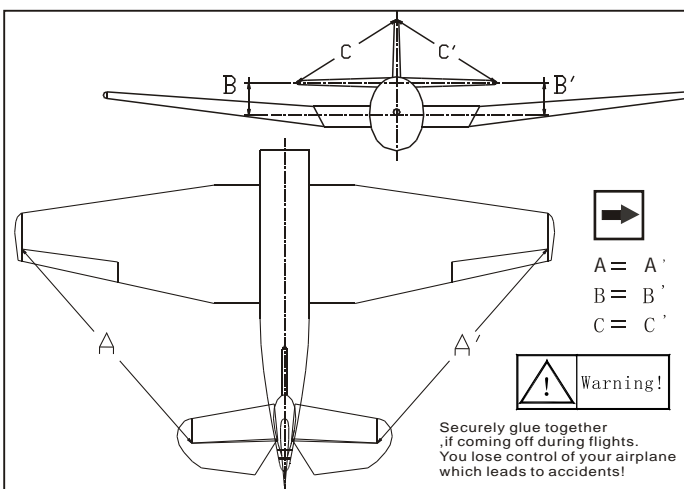

21

Mount the main wing on the fuselage

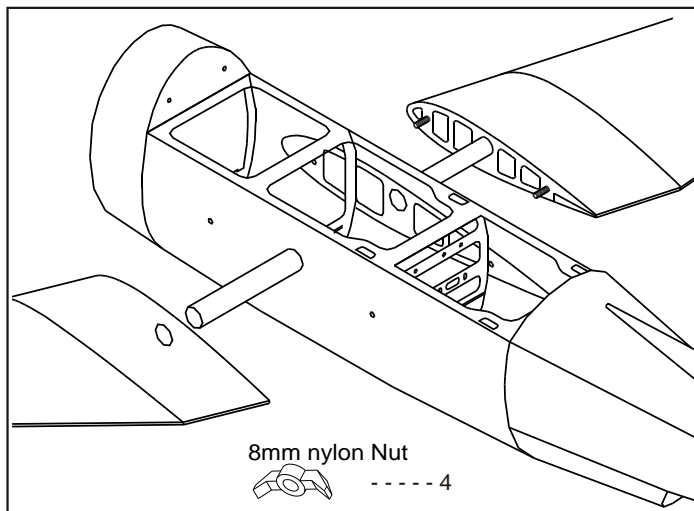

24

Assemble the servos and switch in the fuselage

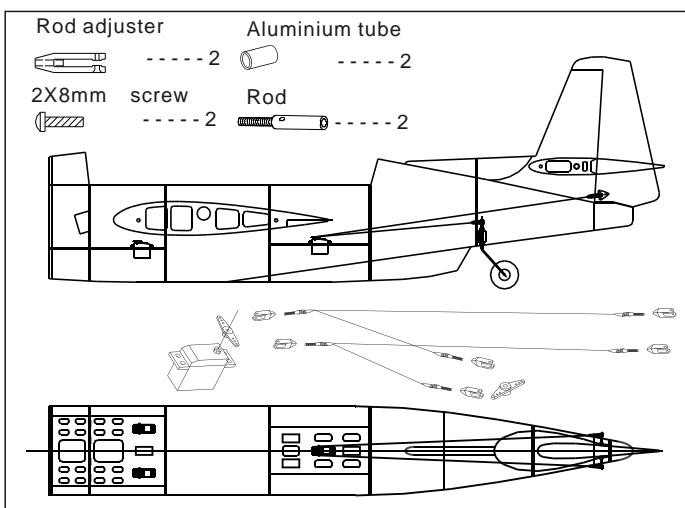

22

Epoxy the horizontal tail to fuselage

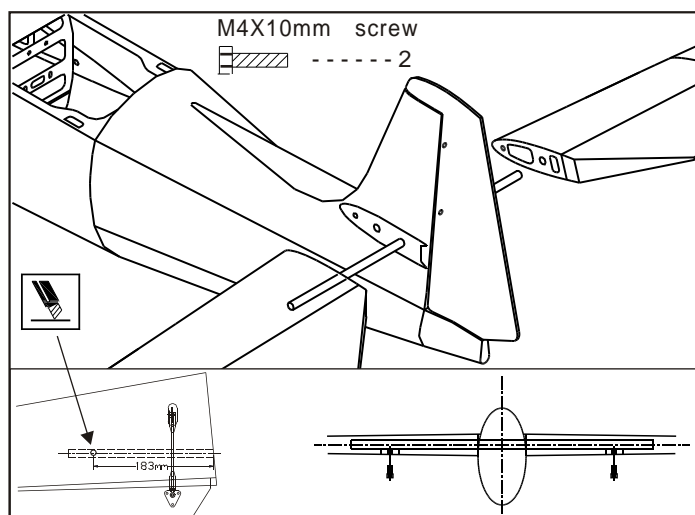

25

Assemble the canopy

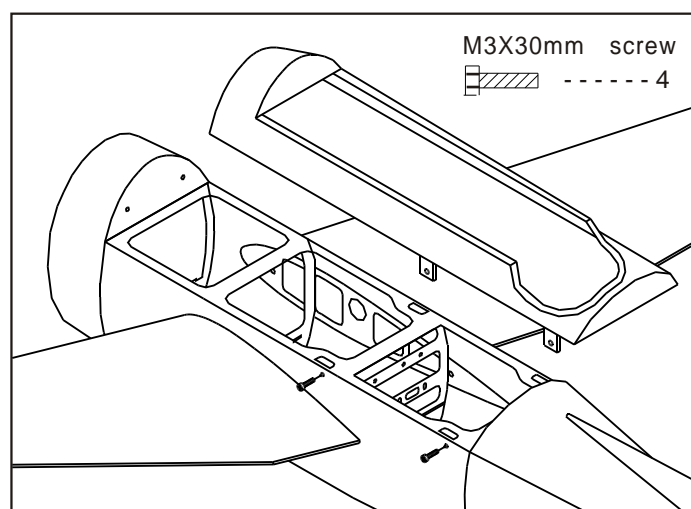



Accessory list for this page.

M3X25mm screw

 - - - - - 2

3mm Washer

 - - - - - 8

M3X15mm screw

 - - - - - 6

28

Assemble the canopy

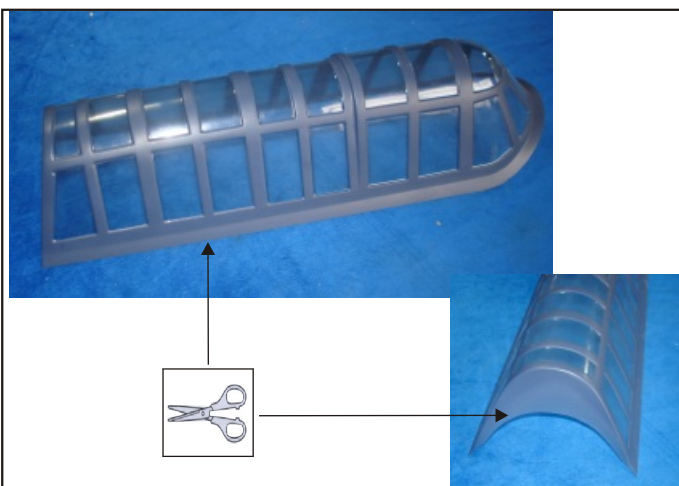

26

Assemble the canopy

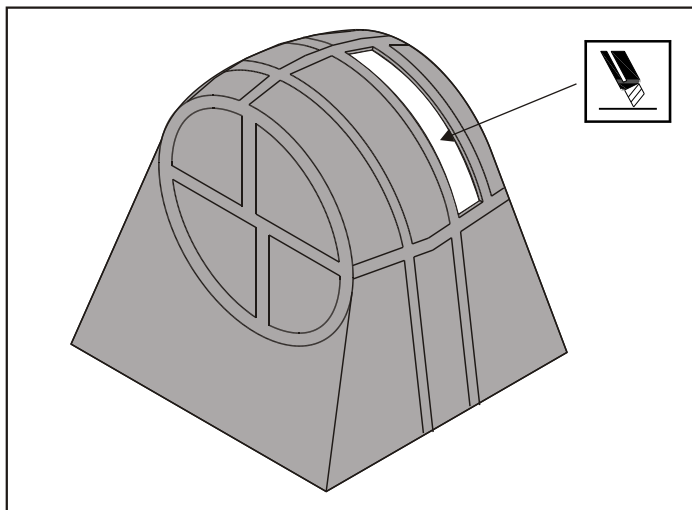

29

Assemble the canopy

M2.3X10mm screw

 - - - - - 8



27

Assemble the canopy

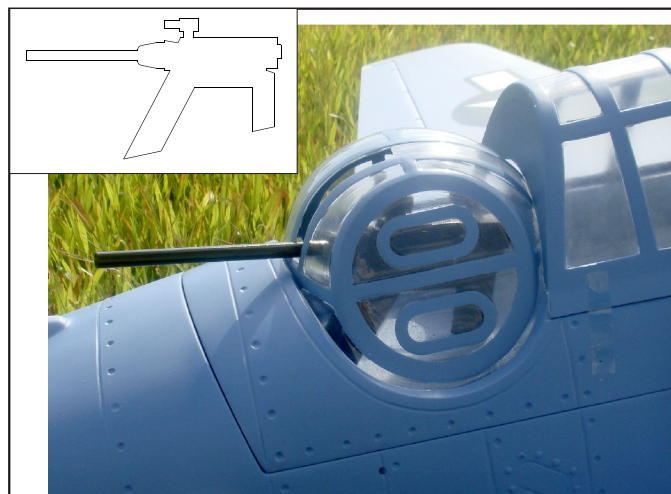

30

Install the cowling

M3X25mm screw

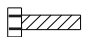
 - - - - - 6

3mm Washer

 - - - - - 6



31 Adjustment.

Adjust the travel of each control surface to the values in the diagrams.
These values fit general flight capabilities.
Readjust according to your needs and flight level.

AILERON

Top view

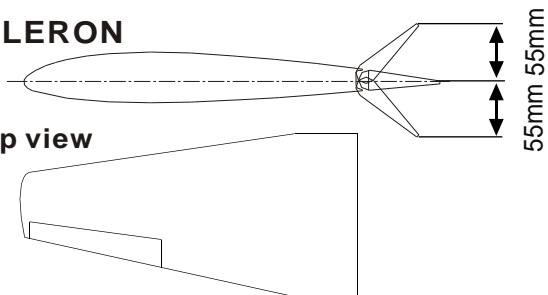

33 Adjustment.

Adjust the travel of each control surface to the values in the diagrams.
These values fit general flight capabilities.
Readjust according to your needs and flight level.

Side view

Top view

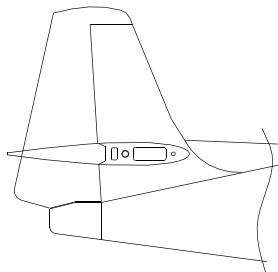
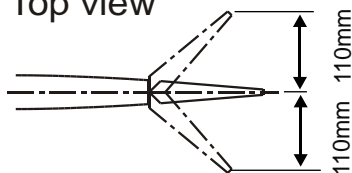

32 Adjustment.

Adjust the travel of each control surface to the values in the diagrams.
These values fit general flight capabilities.
Readjust according to your needs and flight level.

Side view

Top view

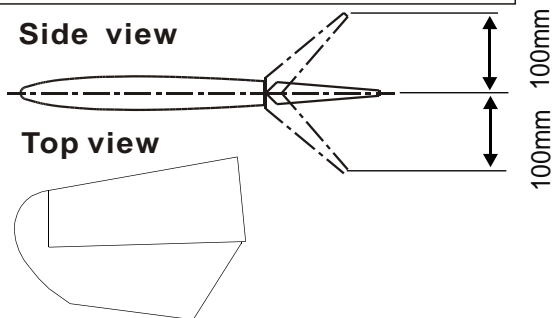

34 Centre of Gravity.

Never fly before checking the Cg's required position.
In order to obtain the CG specified, reposition the receiver and battery.

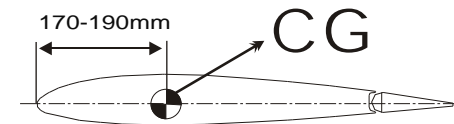

警告
Warning!

NEVER fly the model
without well balancing.

