

Thank you for choosing CYmodel

Global : [www.cymodel.com](http://www.cymodel.com)

# F8F Bearcat



## Instruction Manual

Before commencing assembly, please read these instructions thoroughly.



Warning!

### SAFETY PRECAUTIONS

**This radio control model is not a toy!**

- First-time builders should seek advice from people having building experience in order to assemble the model correctly and to produce its performance to full extent.
- Assemble this kit only in places out of children's reach!
- Take enough safety precautions prior to operating this model.  
You are responsible for this model's assembly and safe operation!
- Always keep this instruction manual ready at hand for quick reference, even after completing the assembly.
- Could cause serious injury or even death

### SPECIFICATION

Wing Span.....2135 mm (84 in)  
Wing Area.....72 dm<sup>2</sup>(1120 sq.in)  
Take-off weight....10.4 kg  
Length.....1680 mm (66.1in)  
Engine.....35-50cc gas engine  
Radio.....6 channels, 10 servos

## REQUIRED FOR OPERATION (Purchase separately)

- 1** A minimum 6 channel radio for airplanes (with 10 servos).  
And dry batteries.



CAUTION: Only use a minimum 6 channel radio for airplanes! (No other radio may be used!)

A minimum 6 channel transmitter for airplanes.



12 AA-size Batteries



For handing the radio properly, refer to its instruction manual.

- 2** Engine and Muffler  
Model Airplane engine  
35-50 cc gas engine

Muffler

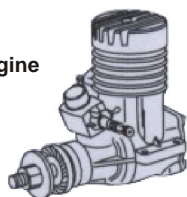
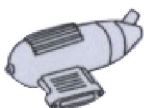

Glow plug



- 3** Propeller splinner

Purchase a propeller that will match your engine



- 4** Silicone Tube  Fuel Filter 

- 5** required for engine starting Glow engine fuel only.



WARNING: Normal gasoline cannot be used with glow engines.



Fuel Pump



Plug Wrench

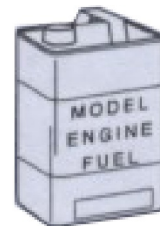

- 6** Glue



Instant glue



Epoxy Glue

- 7** Other equipment for enhancing airplane operation & perormance

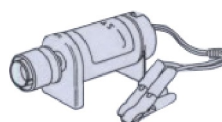

Engine Starter

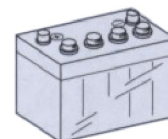

12V Battery (for starter)

## TOOLS REQUIRED ( Purchase separately)

Sharp Hobby Knife



Phillips Screw Driver



Awl



Needle Nose Pliers



Wire Cutters



Scissors

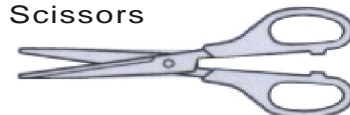

## BEFORE YOU BEGIN

- 1** . Read through the manual before you begin ,so you will have an overall idea of what to do.
- 2** . Check all parts .if you find any defective or missing parts .contact your local deater.
- 3** . Symbols used throughout this instruction manual,comprise.



Apply epoxy glue.



Drill holes with the specified Diameter(here:2mm)



Must be purchased separately!



Apply instant glue (CA glue,super glue).



Ensure smooth non-binding movement while assembling.



Pay close attention here!



Assemble left and right Sides the same way.



Cut off shaded portion.



Cut off excess.



Warning!

Do not overlook this symbol.

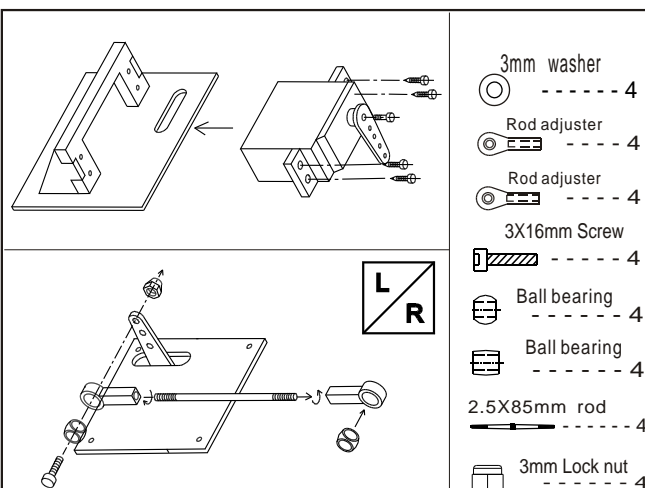
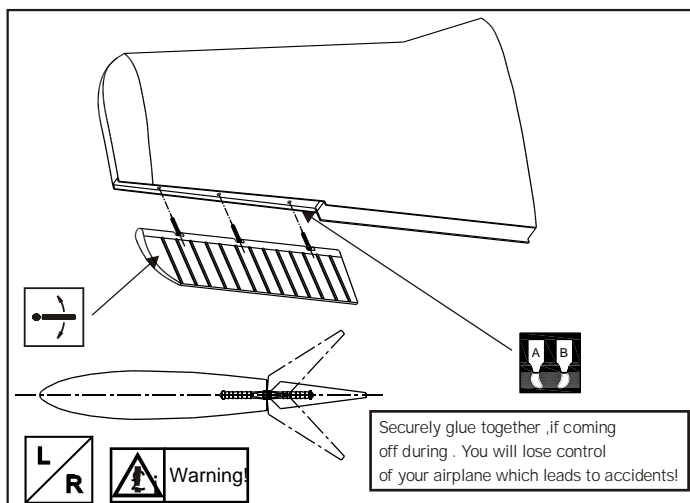
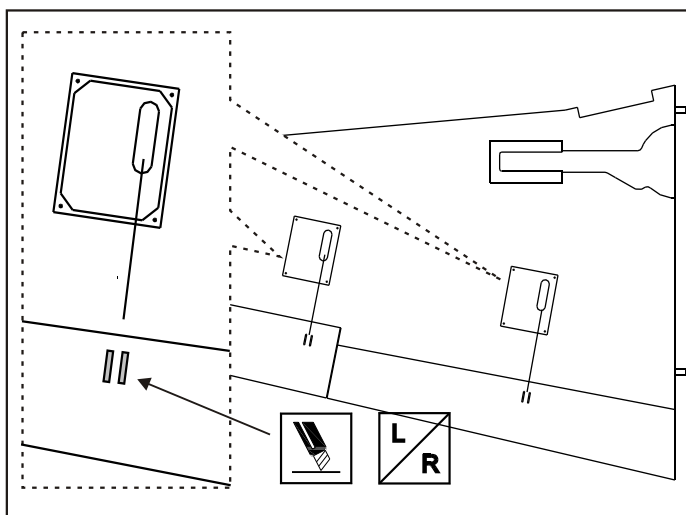
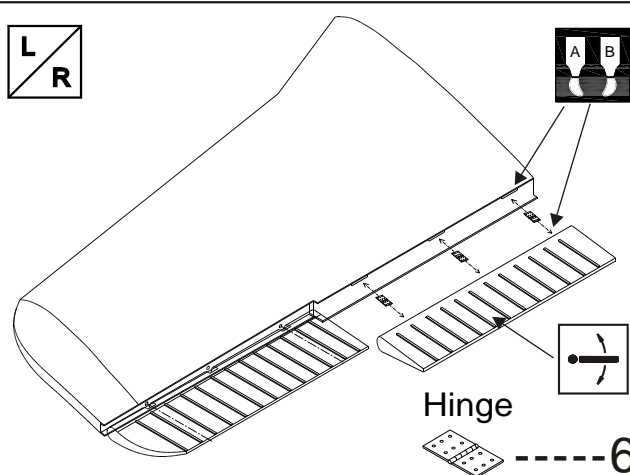



## Accessory list for this page.

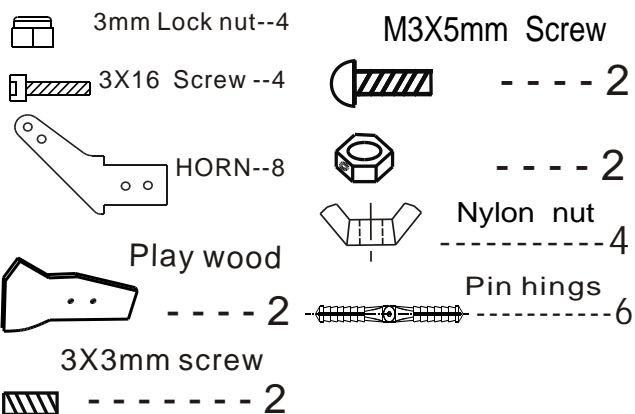

8

## Install the main landing gear

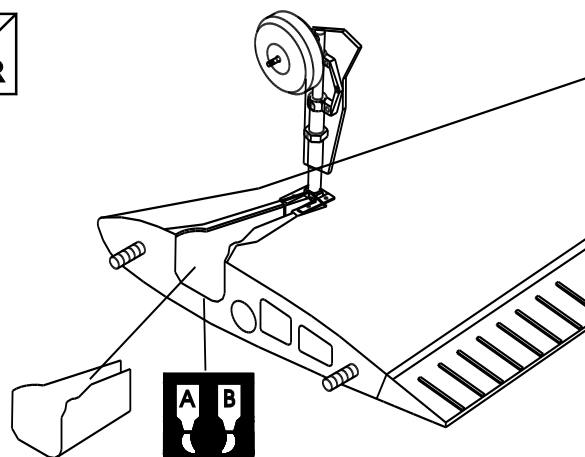

6

## Install the nylon control horn and connect the linkage

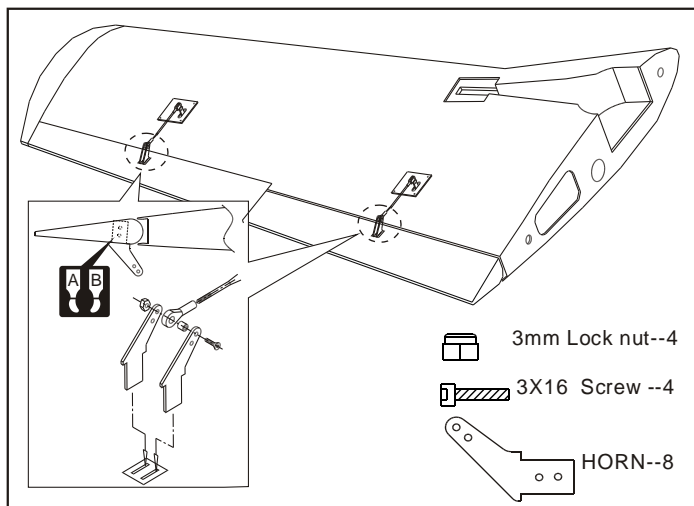

9

## Install the main wing

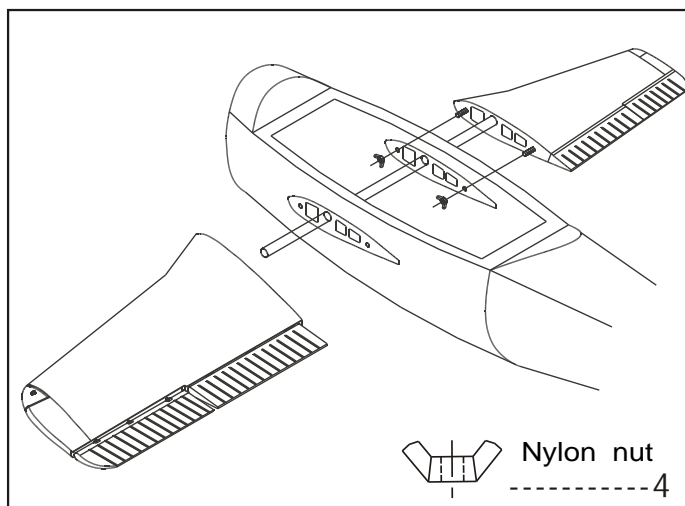

7

## Install the main landing gear

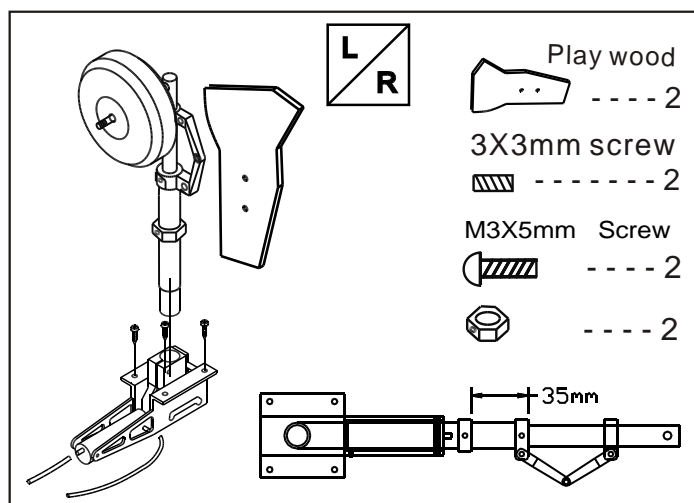

10

## Epoxy pin hinges to elevator

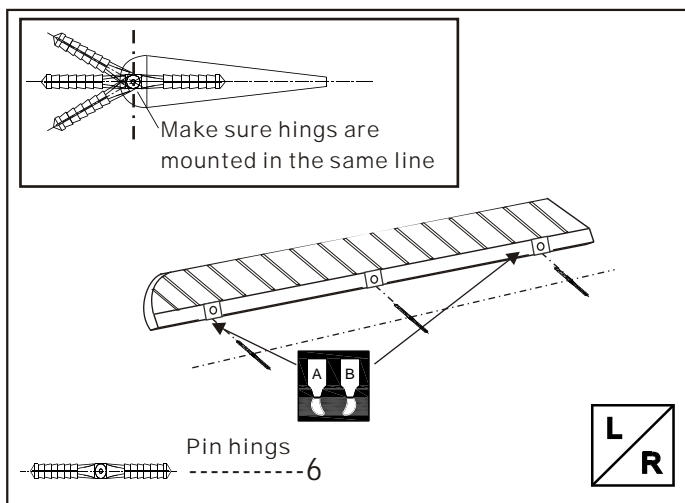





## Accessory list for this page.



HORN--2

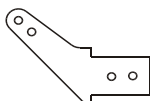

HORN--4

M3X30mm cap screw



----- 2

3mm Lock Nut



----- 2

## 13

## Install the horizontal tail

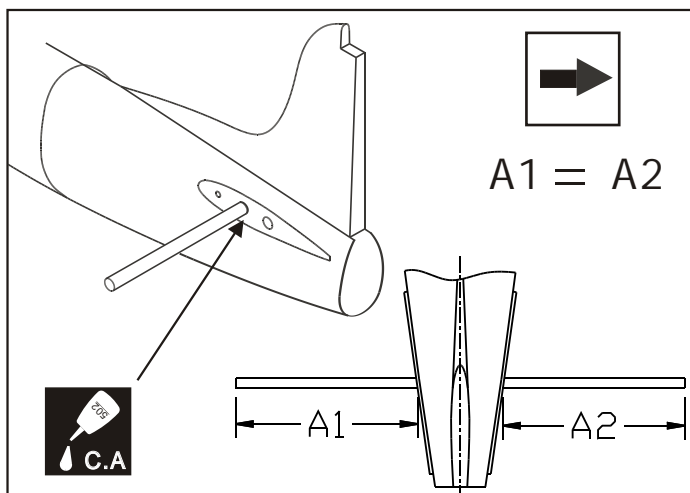

## 11

## Epoxy pin hinges to elevator

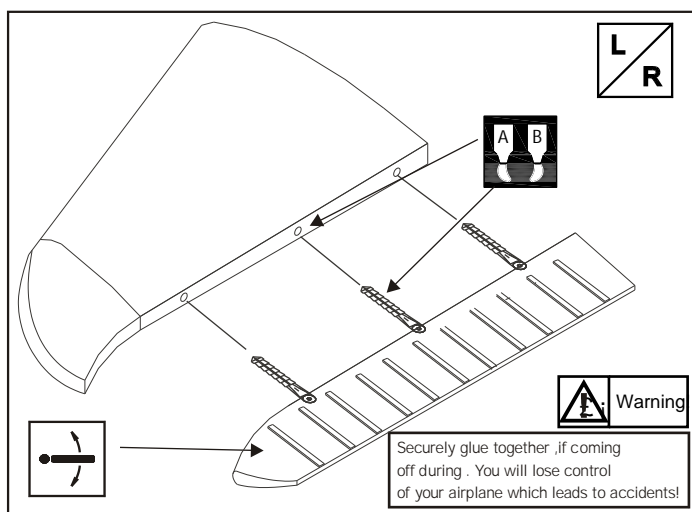

## 14

## Assemble horizontal tail

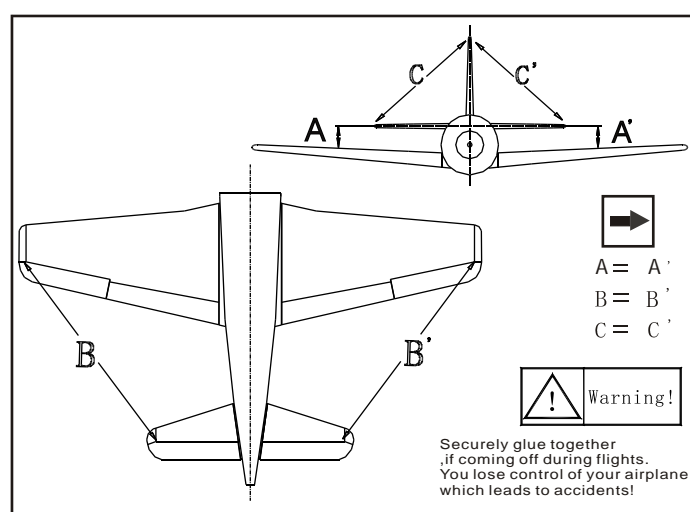

## 12

## Install the nylon control horn and connect the linkage

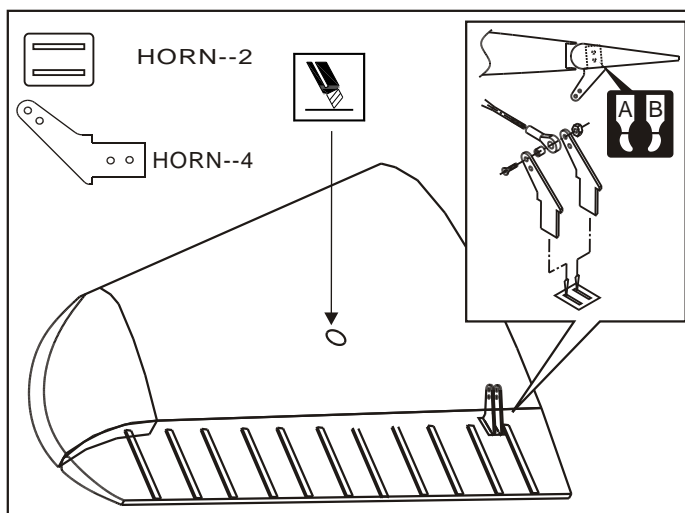

## 15

## Install the horizontal tail

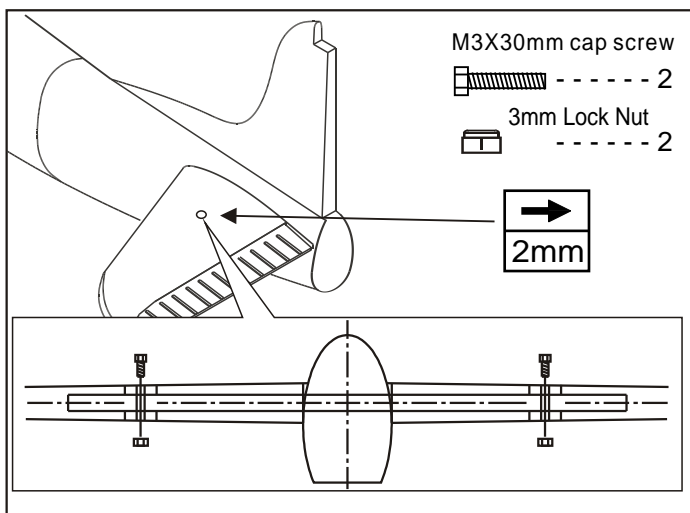



## Accessory list for this page.

Aluminum tube (8x120mm)	M4x45mm Screw
----- 1	----- 1
Connecting rod head	4mm Nut
----- 2	----- 2
Steel wire(250mm)	Steel wire(900mm)
----- 2	----- 2
4X20mm Tp screw	Aluminum tube (3x6mm)
----- 2	----- 4
6X9 screw	6mm nut
----- 1	----- 1
3X3mm Screw	3.2mm Collar
----- 3	----- 2
3.2mm Nylon Collar	3.2mm Rocker
----- 1	----- 1

## 18 Install the tail wheel

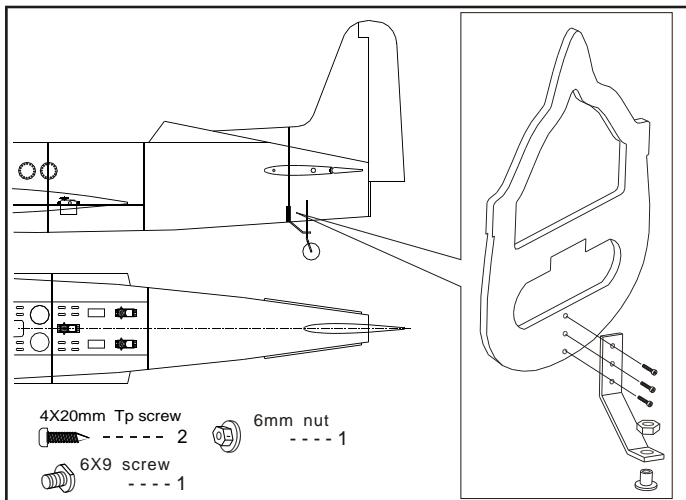

## 16 Rudder . Connect the linkage rod to the horn

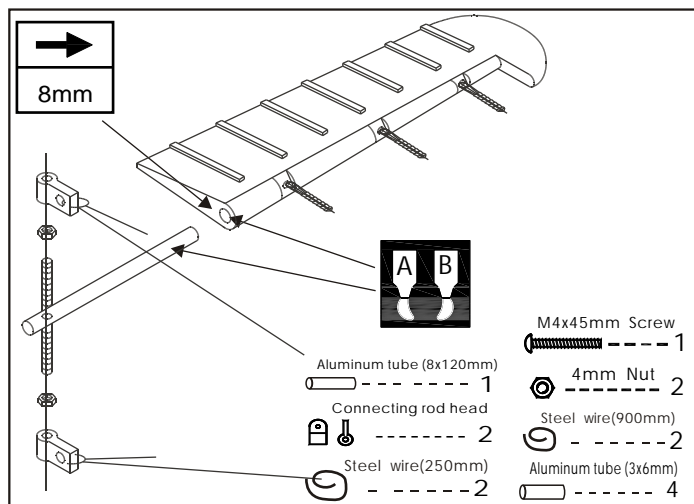

## 19 Install the tail wheel

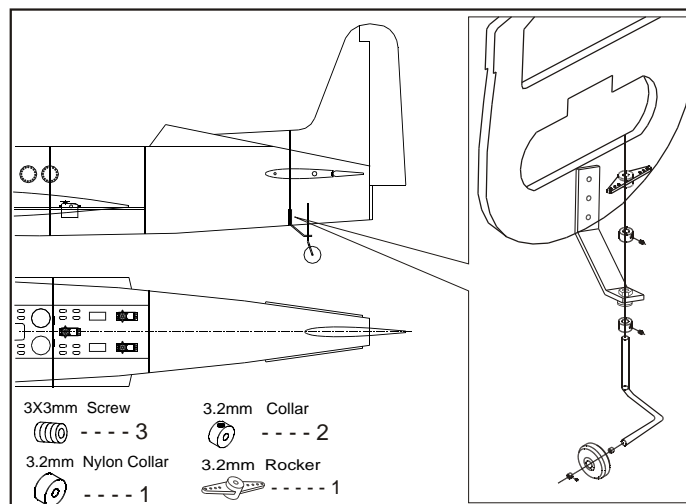

## 17 Epoxy the rudder to the vertical tail edge.

Securely glue together ,if coming off during . You will lose control of your airplane which leads to accidents!

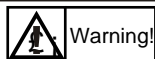

Warning!

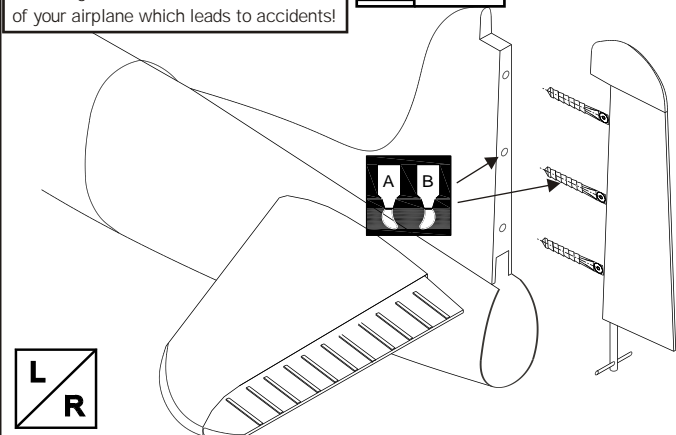

## 20 Install the tail wheel

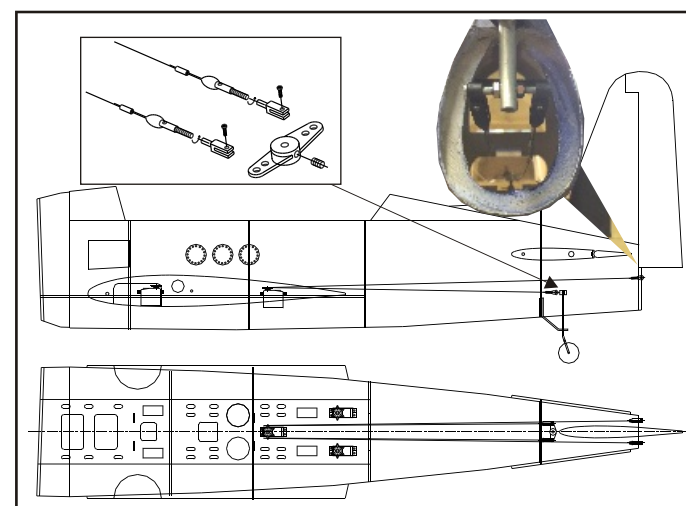



## Accessory list for this page.

2.3x10mm Tp Screw

----- 8

Ball bearing

----- 2

Ball bearing

----- 2

2.5X125mm rod

----- 4

M3X15mm screw

----- 5

3mm Washer

----- 5

Rod adjuster

----- 2

Rod adjuster

----- 2

Carbon fibre rod

----- 2

6mm plywood

----- 10

3mm Blind Nut

----- 5

## 23

## Mount elevator servo into the fuselage

Ball bearing

----- 2

Ball bearing

----- 2

2.5X125mm rod

----- 4

Rod adjuster

----- 2

Rod adjuster

----- 2

Carbon fibre rod

----- 2

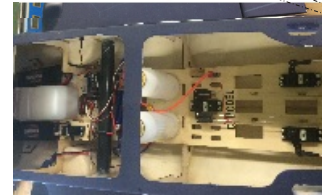

Elevator servo

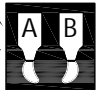

## 21

## Fitting of the tail wheel assembly

2.3x10mm Tp Screw

----- 4

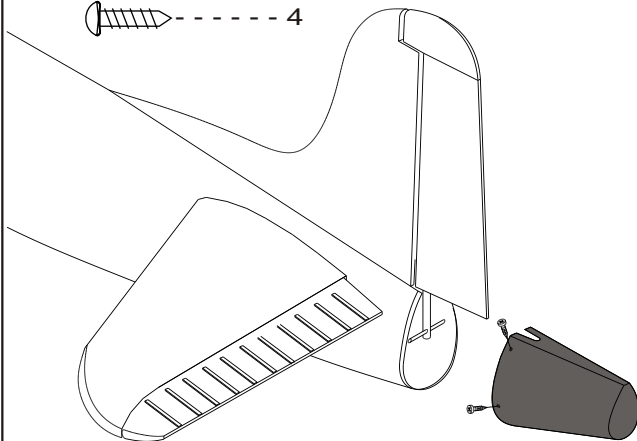

## 24

## Mount cowling on the fuselage

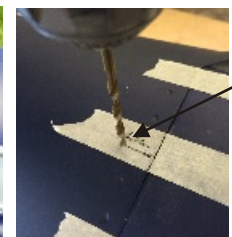

3.2mm



M3X15mm screw

----- 5

3mm Washer

----- 5

6mm plywood

----- 10

3mm Blind Nut

----- 5

## 22

## Assemble the plate to the fuselage

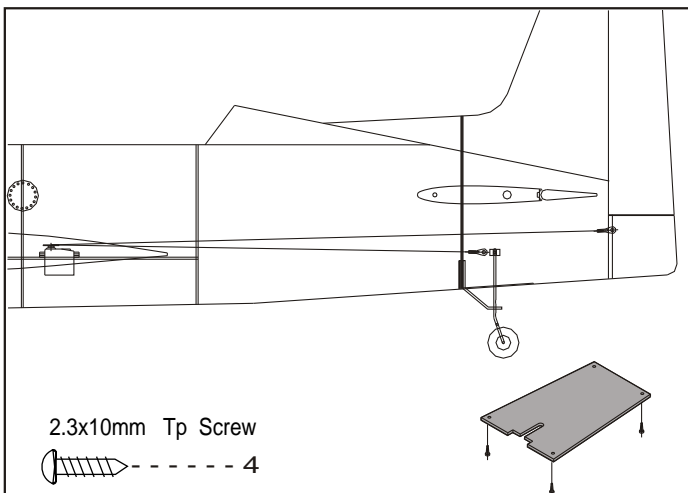

2.3x10mm Tp Screw

----- 4

## 25

## Installation the engine

185mm

50 CC gas engine

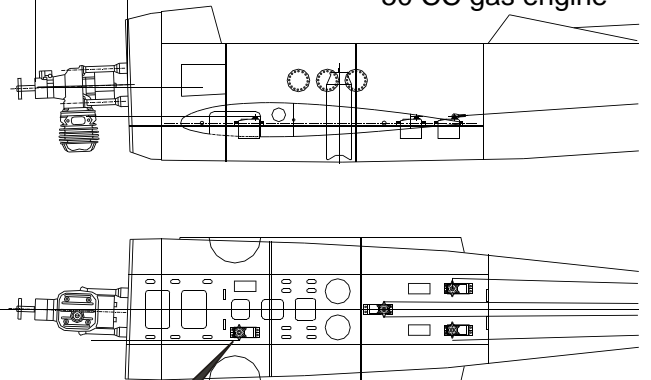

Throttle servo



## Accessory list for this page.

3mm plywood

 ----- 1

M3X20mm screw

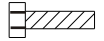
 ----- 2

3mm Washer

 ----- 2

M3X25mm screw

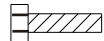
 ----- 2

3mm Washer

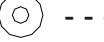
 ----- 2

## 28 Install the guided missile

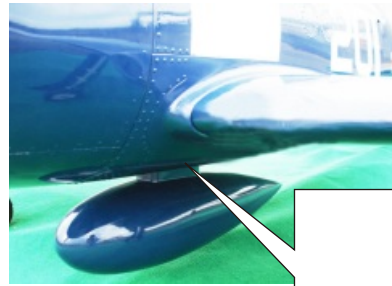

3mm plywood

 ----- 1

M3X20mm screw

 ----- 2

3mm Washer

 ----- 2

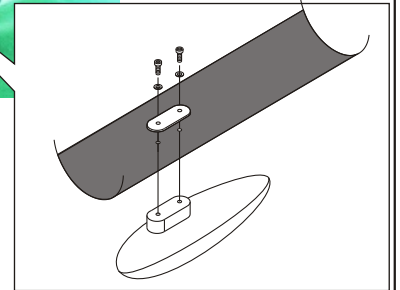

## 26 Assembly of the full tank

After confirming the position(see front of fuel tank). Insert and tighten the screw.

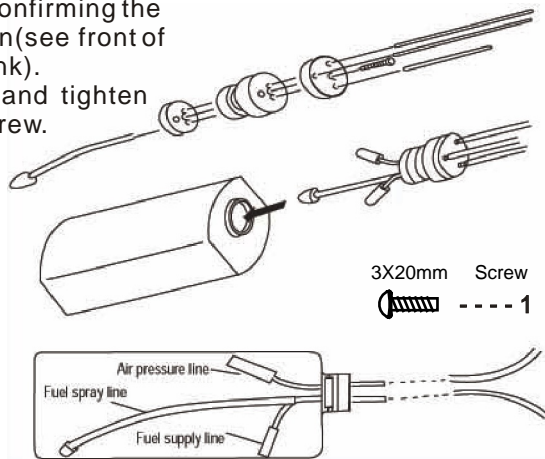

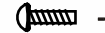
3X20mm Screw  
 ----- 1

## 29 Install the adorning

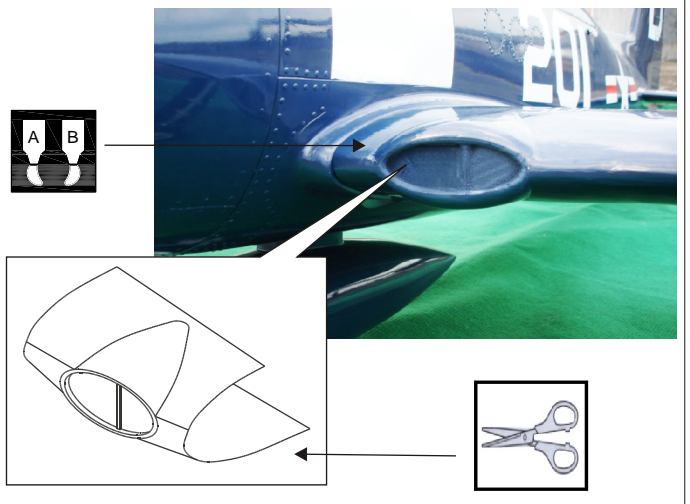

## 27 Mount the fuel into the fuselage

 Fuel tank



## 30 Mount canopy on the fuselage

M3X25mm screw

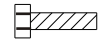
 ----- 2

3mm Washer

 ----- 2





## 31 Adjustment.

Adjust the travel of each control surface to the values in the diagrams.  
These values fit general flight capabilities.  
Readjust according to your needs and flight level.

### AILERON

Top view

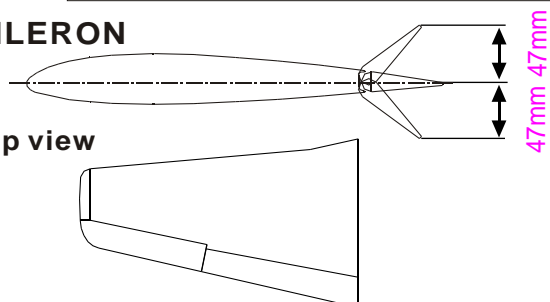

## 33 Adjustment.

Adjust the travel of each control surface to the values in the diagrams.  
These values fit general flight capabilities.  
Readjust according to your needs and flight level.

Top view

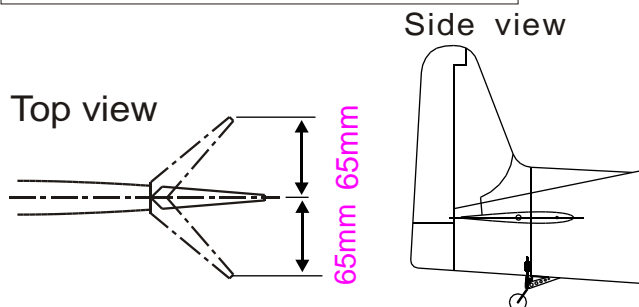

Side view

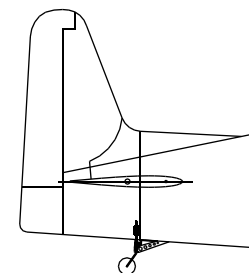

## 32 Adjustment.

Adjust the travel of each control surface to the values in the diagrams.  
These values fit general flight capabilities.  
Readjust according to your needs and flight level.

Side view

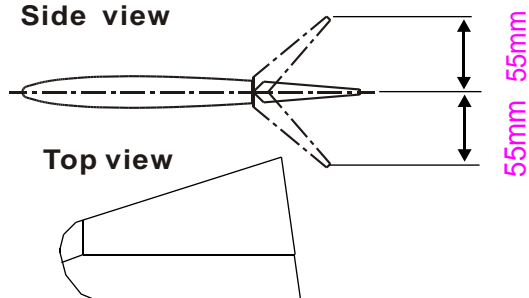

Top view

## 34 Centre of Gravity.

Never fly before checking the Cg's required position.  
In order to obtain the CG specified, reposition the receiver and battery.

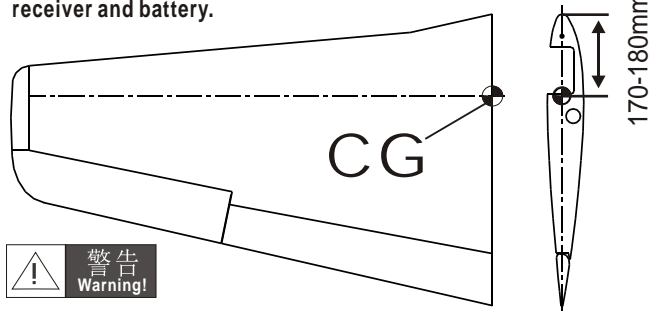

**NEVER** fly the model  
without well balancing.