

Before commencing assembly, please read these instructions thoroughly.



F8F Bearcat



Warning!

SAFETY PRECAUTIONS

This radio control model is not a toy!

- First-time builders should seek advice from people having building experience in order to assemble the model correctly and to produce its performance to full extent.
- Assemble this kit only in places out of children's reach!
- Take enough safety precautions prior to operating this model.
You are responsible for this model's assembly and safe operation!
- Always keep this instruction manual ready at hand for quick reference, even after completing the assembly.

SPECIFICATION

WingSpan.....2460 mm (96.8in)
WingArea.....96 dm²(1473sq.in)
Length.....1930 mm (76 in)
Engine.....80-100 cc gas engine
Radio.....6 channel, 10 servos

REQUIRED FOR OPERATION (Purchase separately)

- 1 A minimum 6 channel radio for airplanes (with 10 servos). And dry batteries.



CAUTION: Only use a minimum 6 channel radio for airplanes! (No other radio may be used!)



12 AA-size Batteries

A minimum 6 channel transmitter for airplanes.



For handing the radio properly, refer to its instruction manual.

- 2 Engine and Muffler
Model Airplane engine
80-100 cc gas engine

Muffler

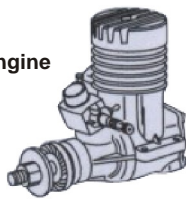

Glow plug



Purchase a propeller that will match your engine



- 3 Propeller splinner

- 4 Silicone Tube  Fuel Filter 

- 5 required for engine starting

Glow engine fuel only.



WARNING: Normal gasoline cannot be used with glow engines.



Fuel Pump

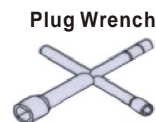

Plug Wrench

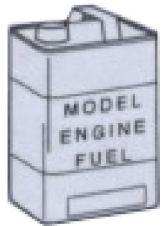

- 6 Glue



Instant glue



Epoxy Glue

- 7 Other equipment for enhancing airplane operation & performance

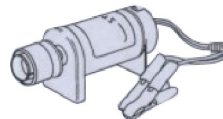

Engine Starter

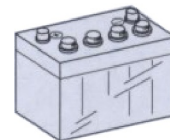

12V Battery (for starter)



Ignition

TOOLS REQUIRED (Purchase separately)

Sharp Hobby Knife



Phillips Screw Driver



Awl



Needle Nose Pliers



Wire Cutters



Scissors

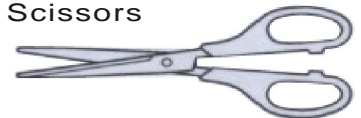

BEFORE YOU BEGIN

- 1 . Read through the manual before you begin ,so you will have an overall idea of what to do.
- 2 . Check all parts .if you find any defective or missing parts .contact your local deater.
- 3 . Symbols used throughout this instruction manual,comprise.



Apply epoxy glue.



Drill holes with the specified Diameter(here:2mm)



Must be purchased separately!



Apply instant glue (CA glue,super glue).



Ensure smooth non-binding movement while assembling.



Pay close attention here!



Assemble left and right Sides the same way.



Cut off shaded portion.



Cut off excess.









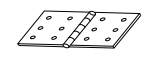

Warning!

Do not overlook this symbol.

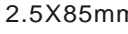

Accessory list for this page.

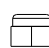
	Pin hinges	6		3X16mm Screw	4
	Hinge	6		Ball bearing	4
	3mm washer	4		Ball bearing	4
	Rod adjuster	4		2.5X85mm rod	4
	Rod adjuster	4		3mm Lock nut	4

3

Epoxy flap hinges to trailing edge

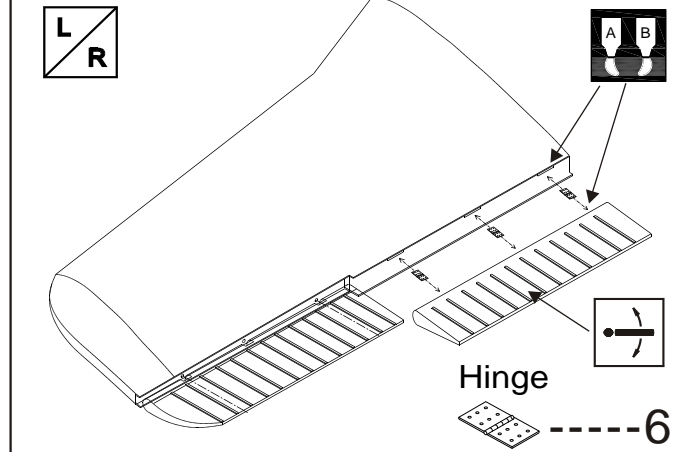

1

Epoxy pin hinges to aileron steadily

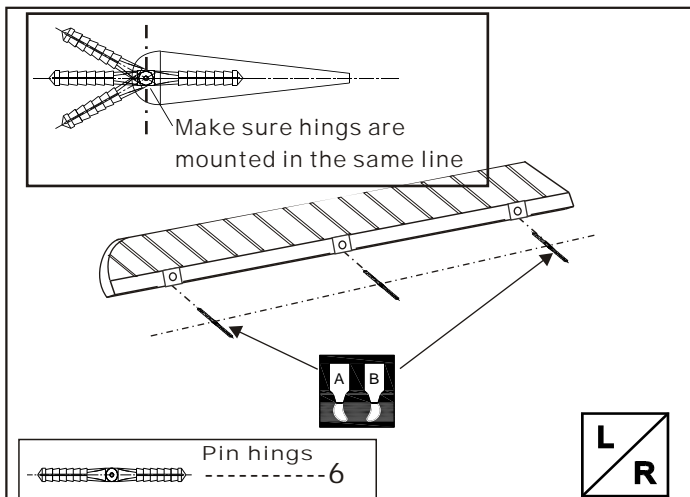

4

Install the servo

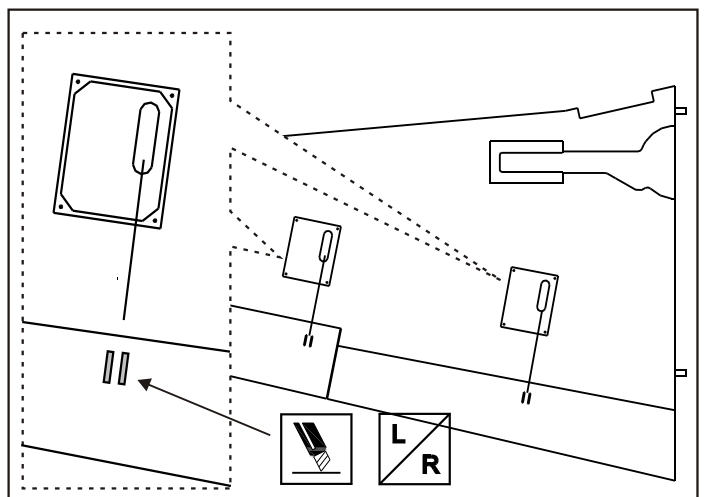

2

Install the aileron

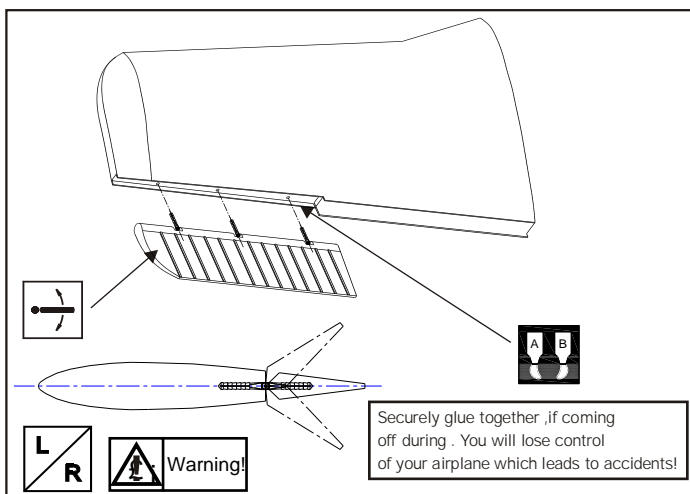

5

Install the nylon control horn and connect the linkage

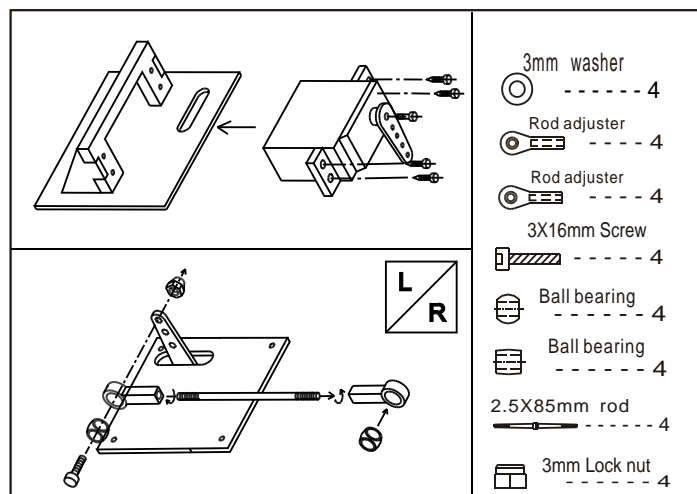



Accessory list for this page.

2.3x10mm screw

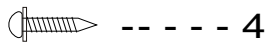

4

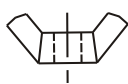

Nylon nut

4

Play wood

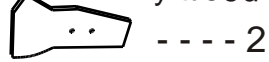

2

Pin hings



6

3X3mm screw



2



2

M3X5mm Screw



2

8

Install the main landing gear

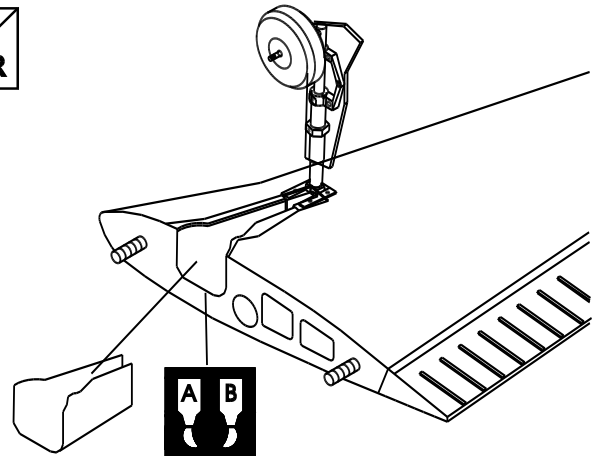

6

Install the lamp-chimney

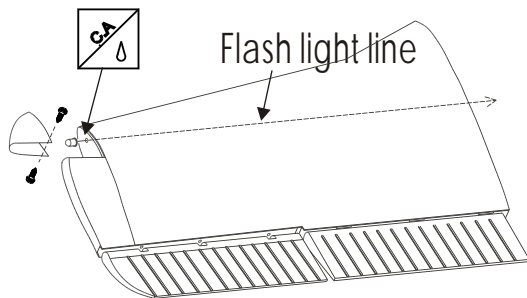

Black line

Battery

2.3x10mm screw

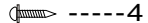

4

Red line

9

Install the main wing

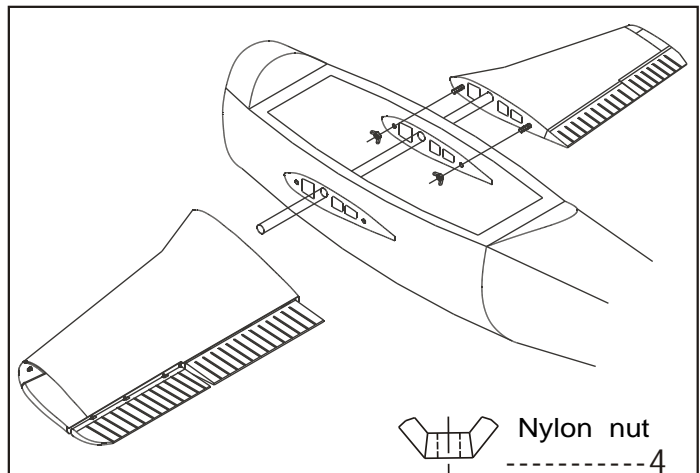

Nylon nut

4

7

Install the main landing gear

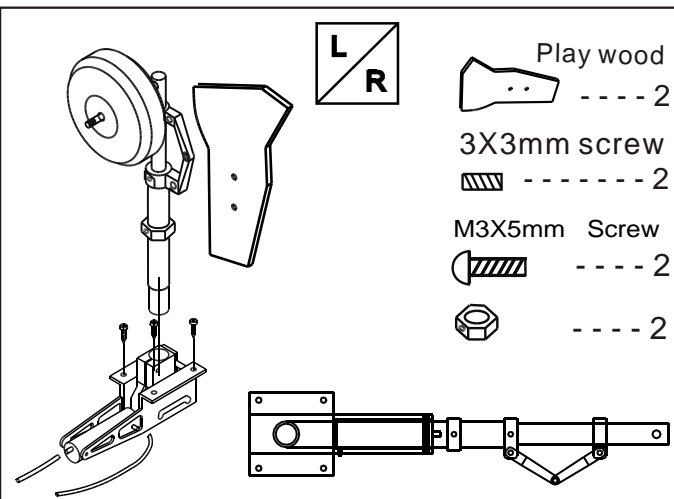

Play wood

2

3X3mm screw



2

M3X5mm Screw



2



2

10

Epoxy pin hings to elevator

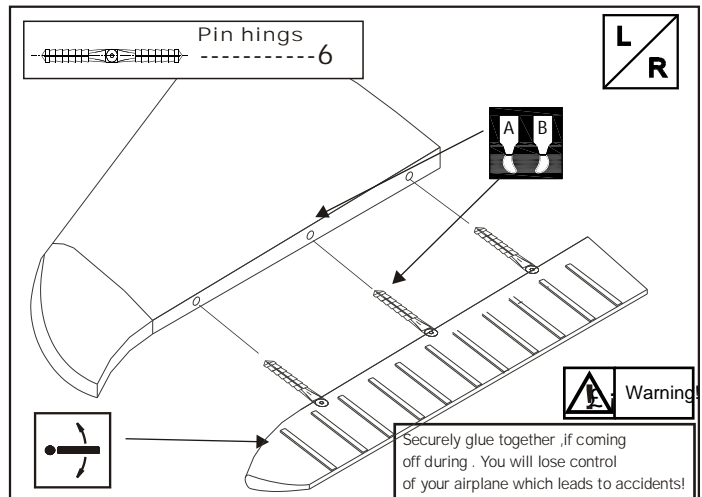

Pin hings

6



Warning!

Securely glue together, if coming off during. You will lose control of your airplane which leads to accidents!



Accessory list for this page.

3mm Lock nut--2

3X16 Screw --2

HORN--4

2.3x10mm Tp Screw

----- 8

M4X12mm cap screw

-----2

Pin hinges

-----3

13 Install the horizontal tail

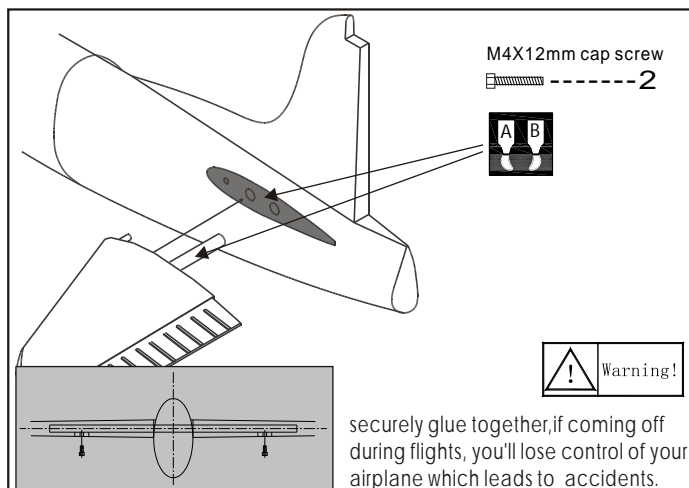

11 Install the servo

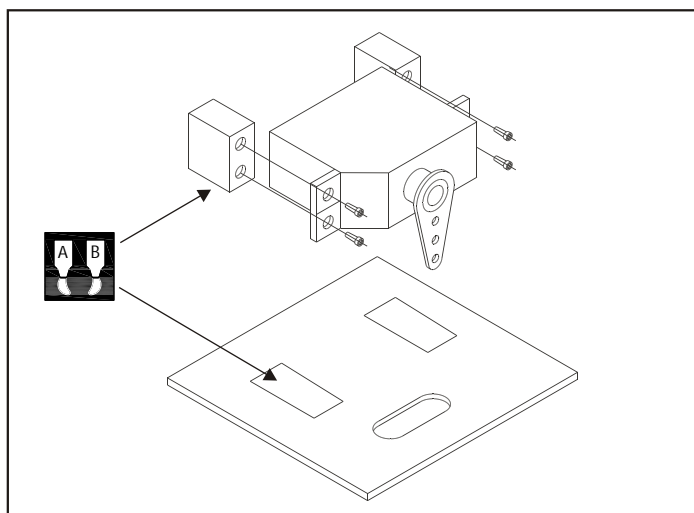

14 Assemble horizontal tail

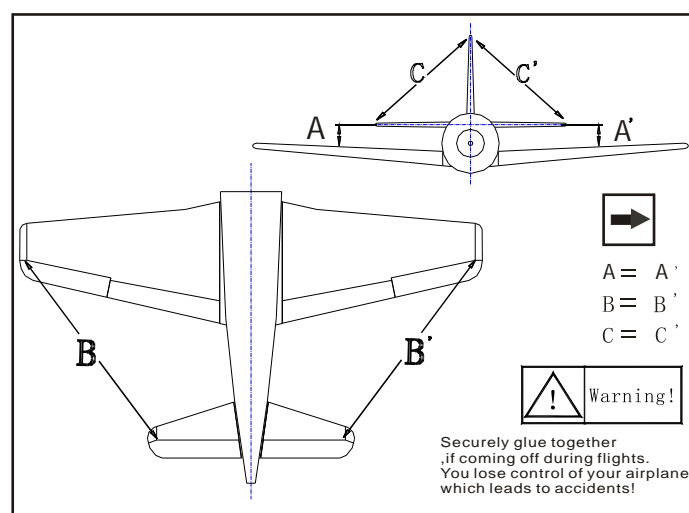

12 Install the nylon control horn and connect the linkage

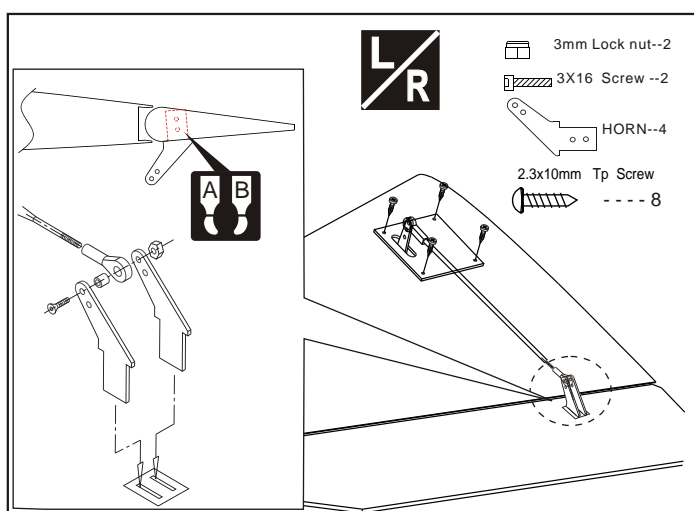

15 Epoxy pin hinges to rudder

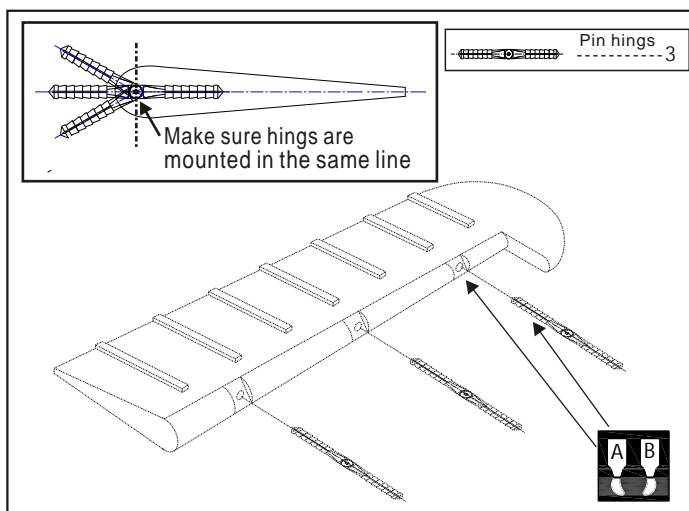



Accessory list for this page.

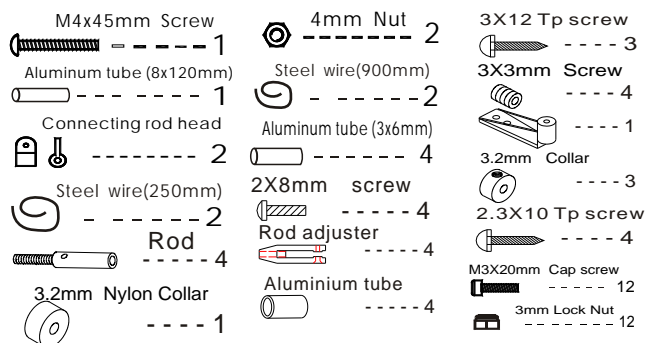

18

Install the landing gear

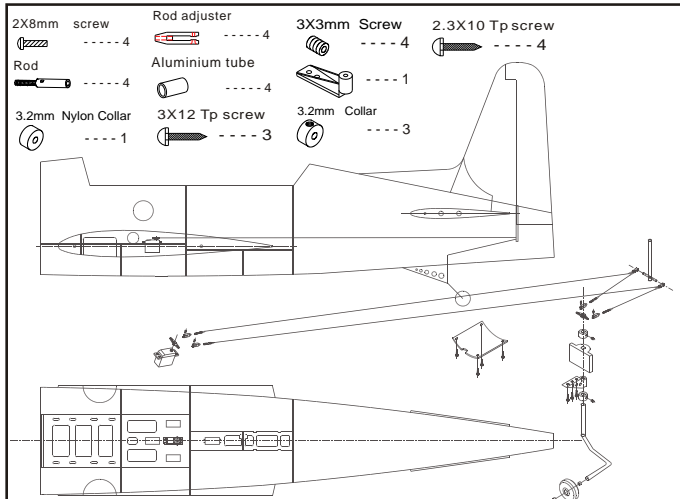

16

Rudder . Connect the linkage rod to the horn

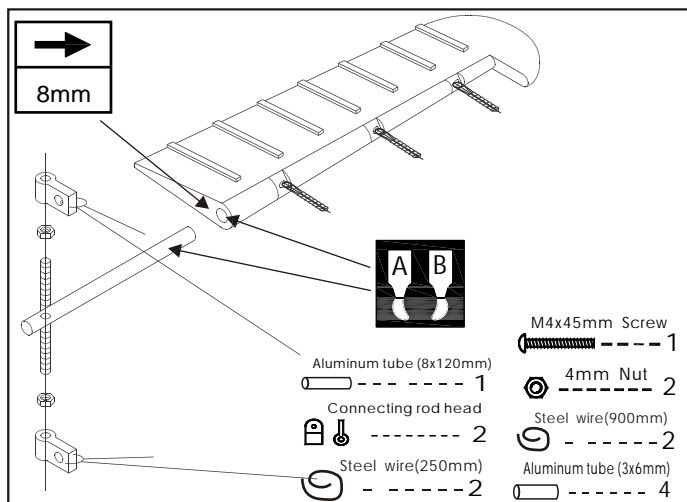

19

Engine Box Preparation

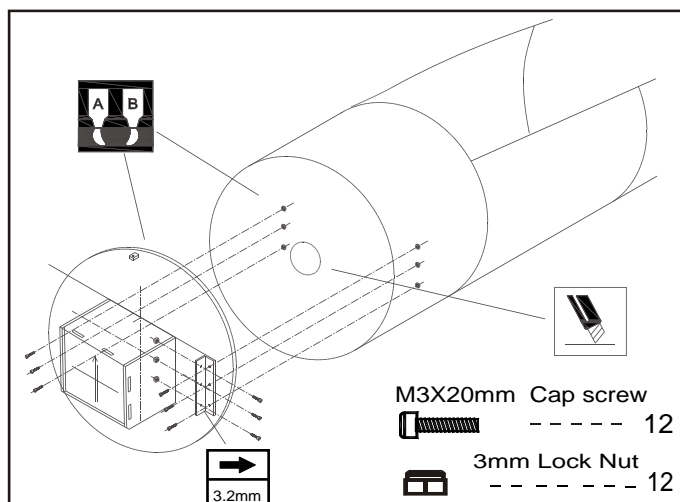

17

Epoxy rudder hinges steadily in position

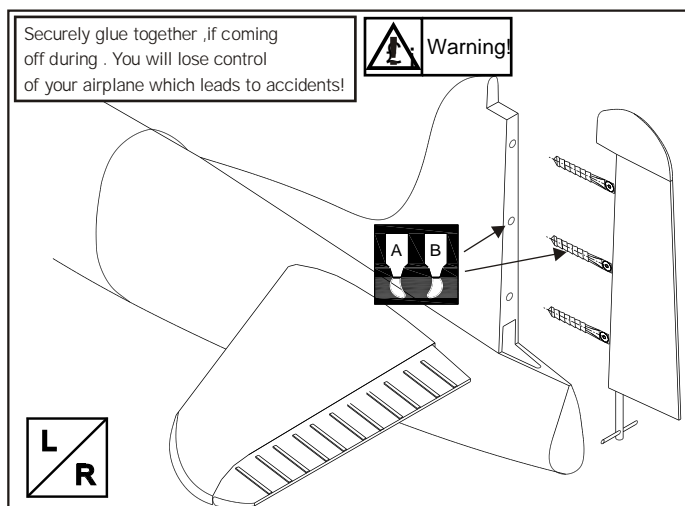

20

Installation the engine

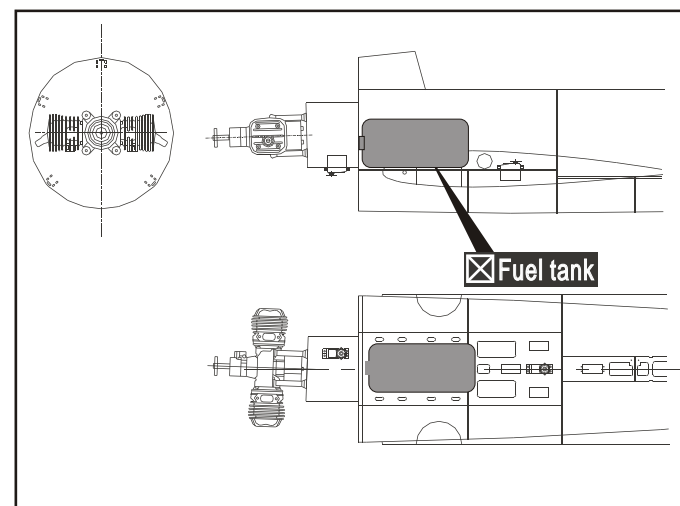



Accessory list for this page.

M3X15mm screw

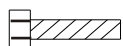
 ----- 5

3mm Washer

 ----- 9

M3X20mm screw

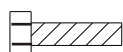
 ----- 2

M3X25mm screw

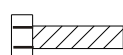
 ----- 2

23

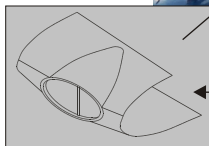

21 Assemble the cowling

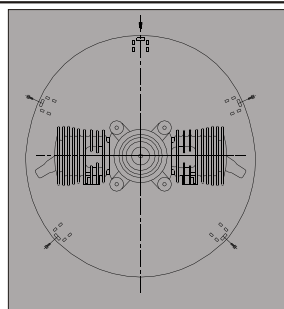

M3X15mm screw

 ----- 5

3mm Washer

 ----- 5



24 Mount canopy on the fuselage

M3X25mm screw

 ----- 2

3mm Washer

 ----- 2



22

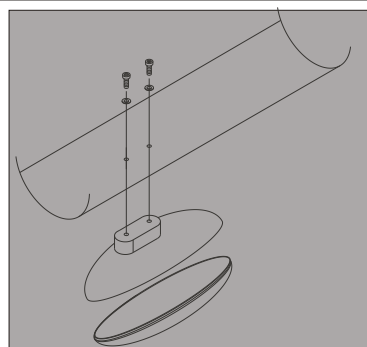

M3X20mm screw

 ----- 2

3mm Washer

 ----- 2



25

26 Adjustment.

Adjust the travel of each control surface to the values in the diagrams.
These values fit general flight capabilities.
Readjust according to your needs and flight level.

AILERON

Top view

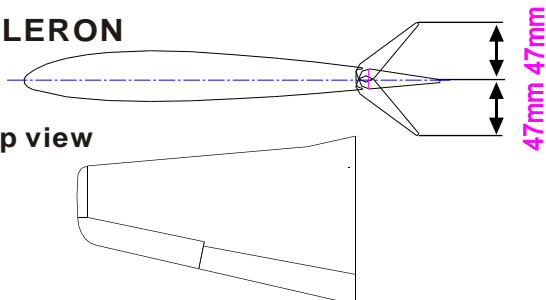

47mm

28 Adjustment.

Adjust the travel of each control surface to the values in the diagrams.
These values fit general flight capabilities.
Readjust according to your needs and flight level.

Side view

Top view

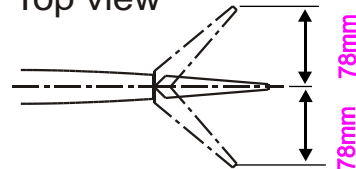

78mm

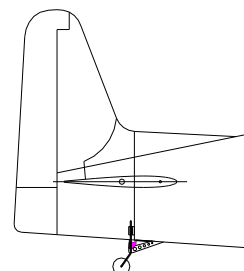

27 Adjustment.

Adjust the travel of each control surface to the values in the diagrams.
These values fit general flight capabilities.
Readjust according to your needs and flight level.

Side view

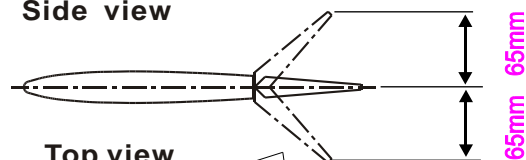

65mm

Top view

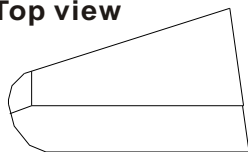

29 Centre of Gravity.

Never fly before checking the Cg' s required position.
In order to obtain the CG specified ,reposition the receiver and battery.

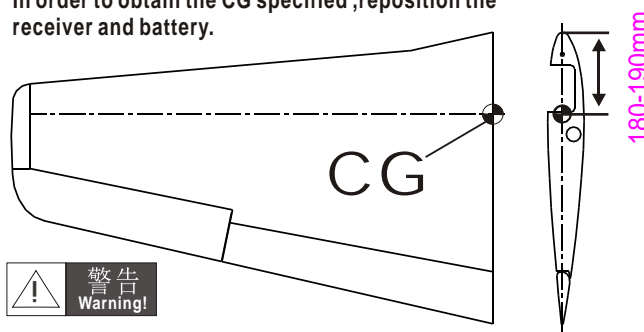

180-190mm



警告
Warning!

NEVER fly the model
without well balancing.

30 Spread a diagram