

Thank you for choosing CYmodel
Global : www.cymodel.com
Australia : www.austars-model.com
Italia : www.biellaexpress.com

Hawker SEA FURY

Item Nr: Cy8029



Instruction Manual

Before commencing assembly, please read these instructions thoroughly.



Warning!

SAFETY PRECAUTIONS

This radio control model is not a toy!

First-time builders should seek advice from people having building experience in order to assemble the model correctly and to produce its performance to full extent.

Assemble this kit only in places out of children's reach!

Take enough safety precautions prior to operating this model.

You are responsible for this model's assembly and safe operation!

Always keep this instruction manual ready at hand for quick reference, even after completing the assembly.

Could cause serious injury or even death

SPECIFICATION

Wing Span.....2420 mm (95.2 in)

Wing Area.....91.4 dm²(1418 sq.in)

Takeoff weight....9.4 kg

Length.....2204 mm (86.7in)

Engine.....100-150cc gas engine

Radio.....6 channels, 10 servos

REQUIRED FOR OPERATION (Purchase separately)

- 1** A minimum 6 channel radio for airplanes (with 10 servos).
And dry batteries.



CAUTION: Only use a minimum 6 channel radio for airplanes! (No other radio may be used!)

A minimum 6 channel transmitter for airplanes.



12 AA-size Batteries



For handing the radio properly, refer to its instruction manual.

- 2** Engine and Muffler
Model Airplane engine
100-150 cc gas engine



Muffler



Ignition

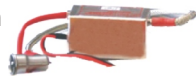

- 3** Propeller splinner

Purchase a propeller that will match your engine



- 4** Silicone Tube  Fuel Filter 
- 5** required for engine starting Glow engine fuel only.



WARNING: Normal gasoline cannot be used with glow engines.



Fuel Pump

Plug Wrench

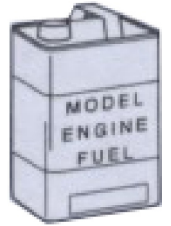
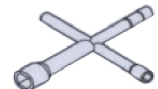

- 6** Glue



Instant glue



Epoxy Glue

- 7** Other equipment for enhancing airplane operation & performance

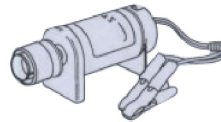

Engine Starter

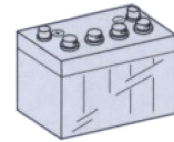

12V Battery (for starter)

TOOLS REQUIRED (Purchase separately)

Sharp Hobby Knife



Phillips Screw Driver

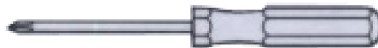

Awl



Needle Nose Pliers

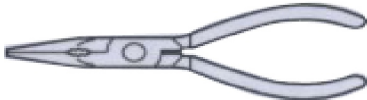

Wire Cutters



Scissors

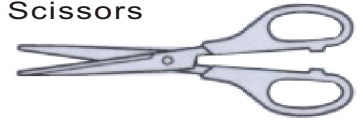

BEFORE YOU BEGIN

1. Read through the manual before you begin, so you will have an overall idea of what to do.
2. Check all parts. If you find any defective or missing parts, contact your local dealer.
3. Symbols used throughout this instruction manual, comprise.



Apply epoxy glue.



Drill holes with the specified Diameter(here:2mm)



Must be purchased separately!



Apply instant glue (CA glue, super glue).



Ensure smooth non-binding movement while assembling.



Pay close attention here!



Assemble left and right Sides the same way.



Cut off shaded portion.



Cut off excess.



Warning!

Do not overlook this symbol.



Accessory list for this page.

2.3x8mm Tp Screw

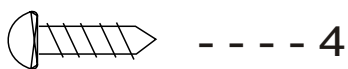

Pin hinges



Hinge



3

Apply instant type A/B glue to aileron and pin hinge

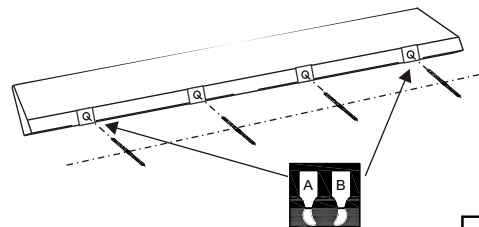
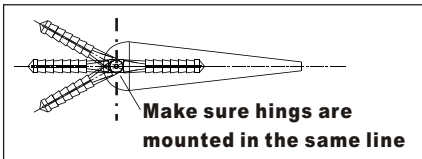

1

Install the navigation lights to the wing

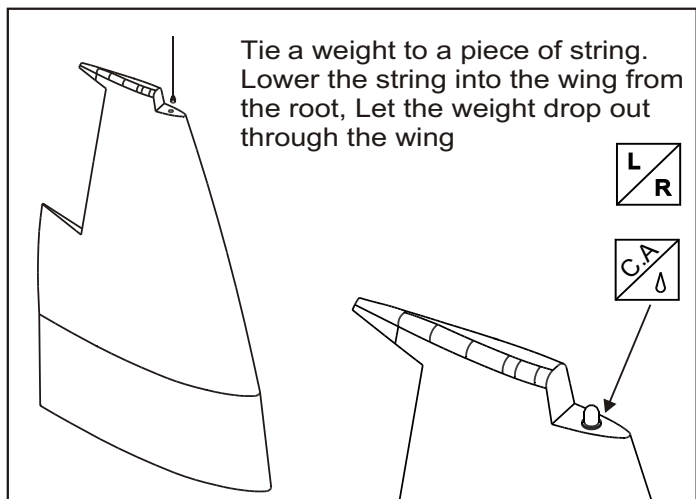

4

Install the aileron

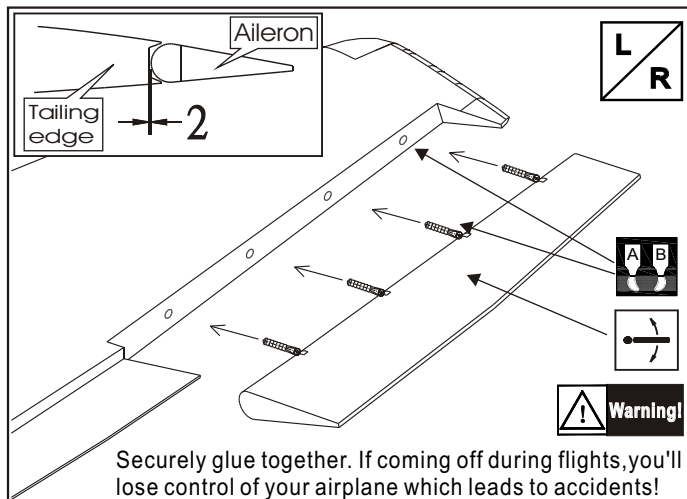

2

Install the lamp-chimney to the wings

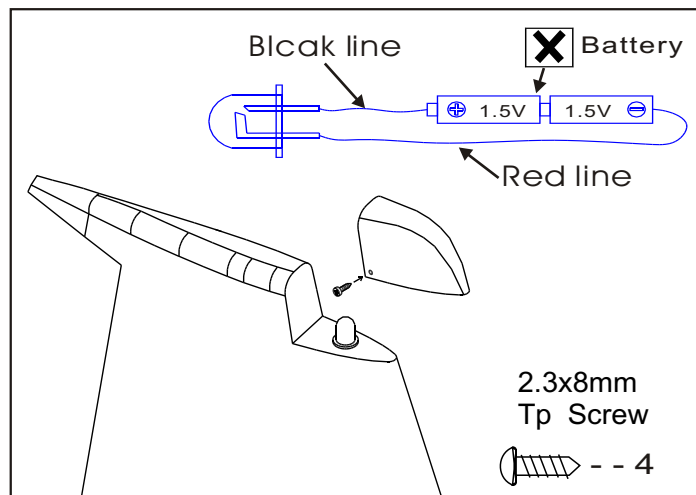

5

Epoxy the flap to the wing as illustration

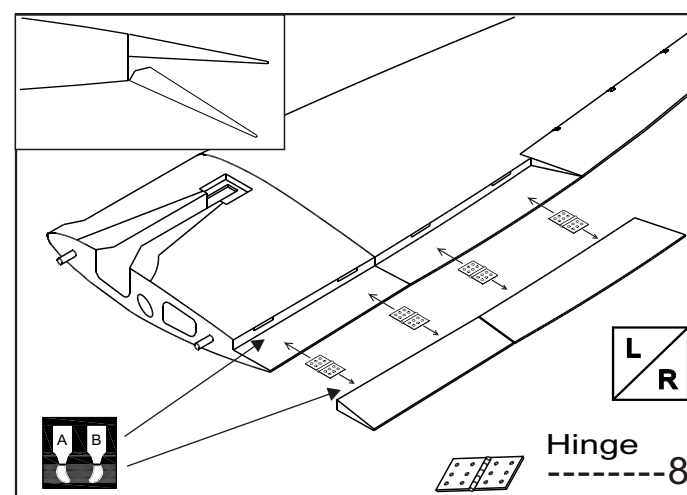



Accessory list for this page.

Rod adjuster

--- 12

Connecting rod head

--- 6

Rod (2.5x85mm)

--- 4

Horn

--- 6

--- 2

Rod (2.5x100mm)

--- 2

M3X35mm Screw

--- 4

M3X30mm Screw

--- 2

M2X8mm Screw

--- 12

M3X30mm Screw

--- 12

M4X35mm Screw

--- 4

8

Install the nylon control horn and connect the linkage

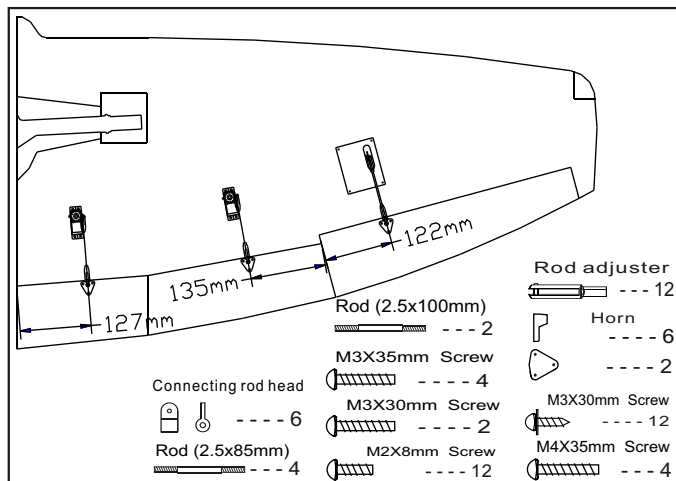

6

Assemble of the servo

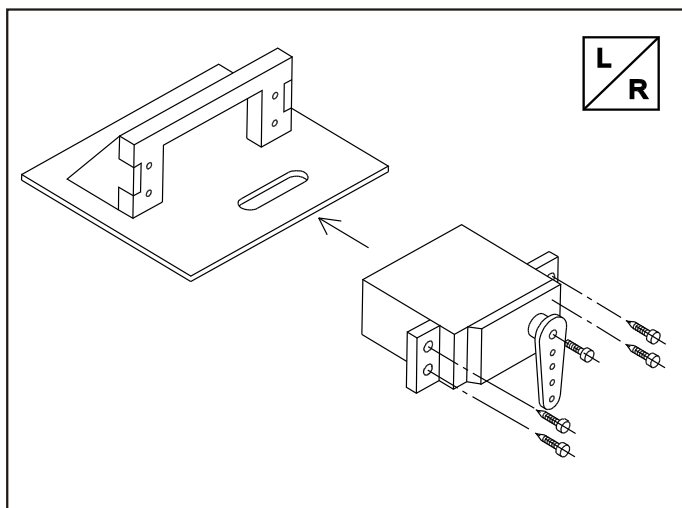

9

Install the nylon control horn and connect the linkage

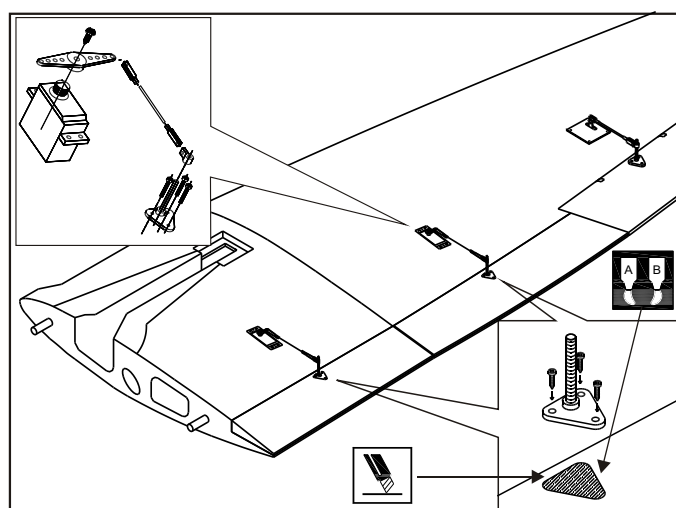

7

Assemble of the servo

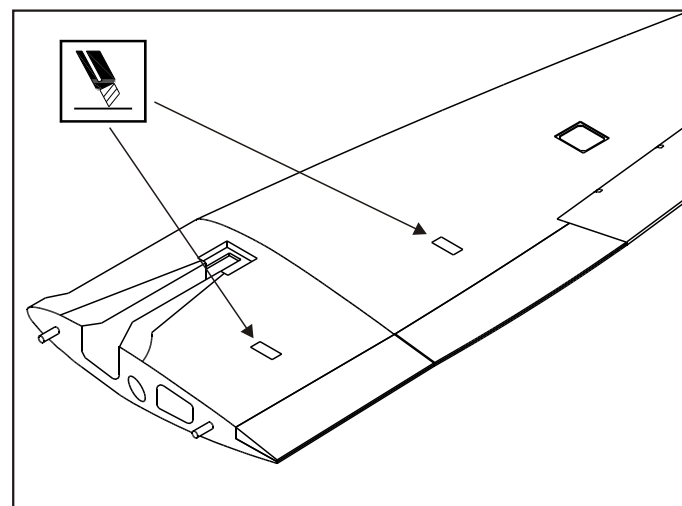

10

Epoxy the wheel wells to the holes Trim the holes if necessary

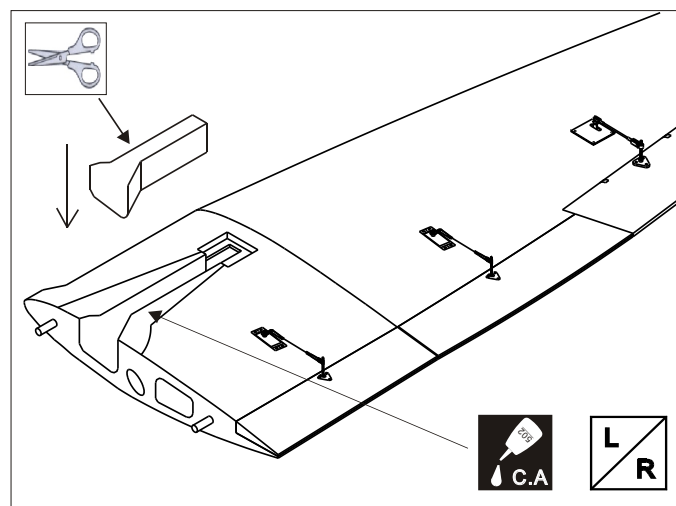



Accessory list for this page.

5X45mm Axletree	Rod adjuster	Horn
3X20mm Tp screw	2X8mm screw	Rod adjuster
5.2mm Collar	2000mm Air line	Connecting rod head
3X3mm screw	Retainer	M2X8mm Screw
4X4mm screw	Rod (1.8X80mm)	M3X35mm Screw
	Pin hinges	M3X30mm Screw
	Rod (2.5x85mm)	M4X35mm Screw

13 Epoxy pin hinges to elevator

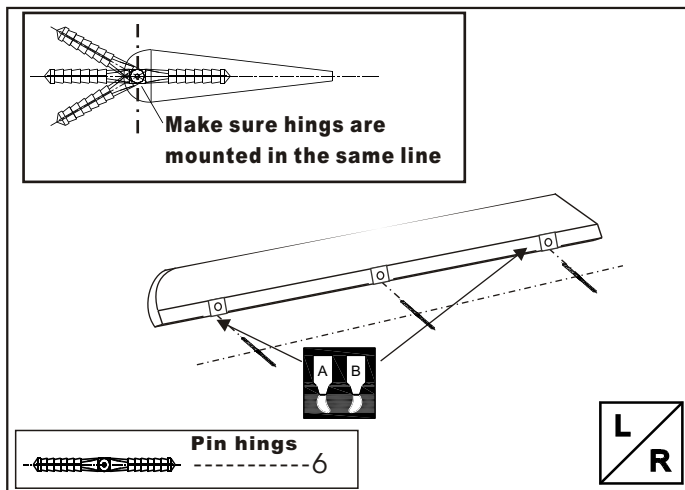

11 Assemble of the landing gear

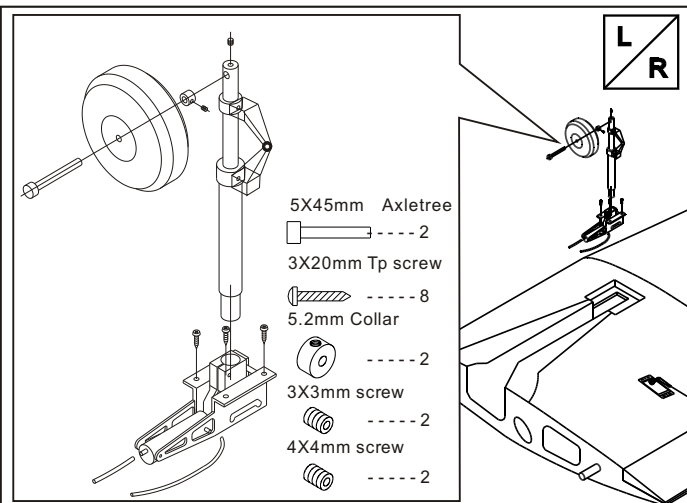

14 Epoxy elevator hinges to horizontal tail

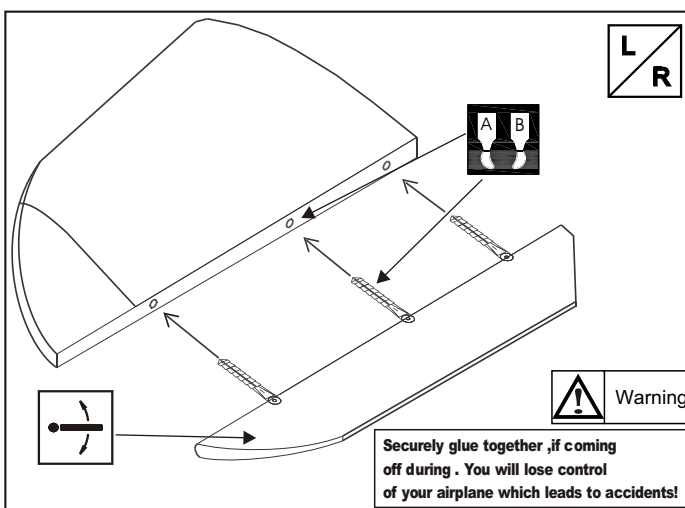

12 Two wheel retract system

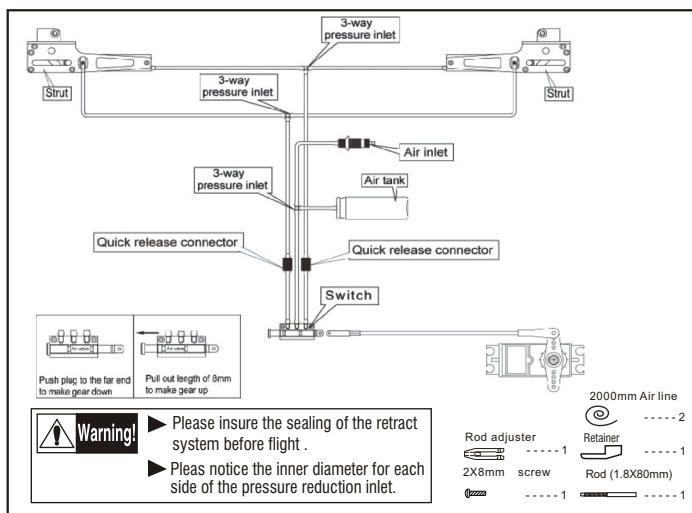

15 Install the elevator servos

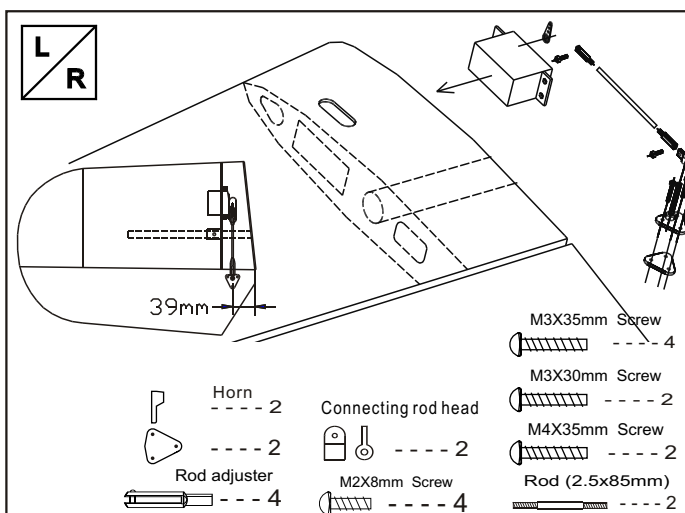



Accessory list for this page.

Pin hinges -----4	Horn -----2	M4X45mm Screw -----3
M3X16mm Cap screw -----4	Connecting rod head -----2	M3X35mm Screw -----3
3X3mm Screw -----4	Rod adjuster -----2	M2X8mm Screw -----2
3.2mm Rocker -----1	Rod -----2	Set Nut -----3
3.2mm Nylon Collar -----1	10mm tube -----2	
3.2mm Metal Collar -----3	8mm prapilionaceous Nut -----4	

18 Install the tail wheel

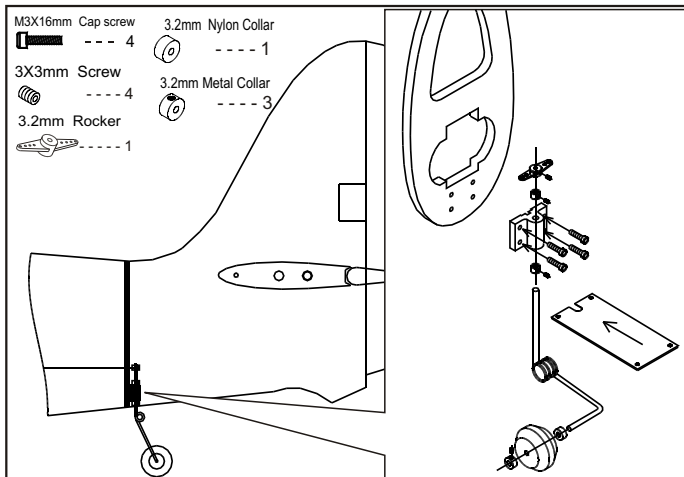

16 Epoxy pin hinges to rudder

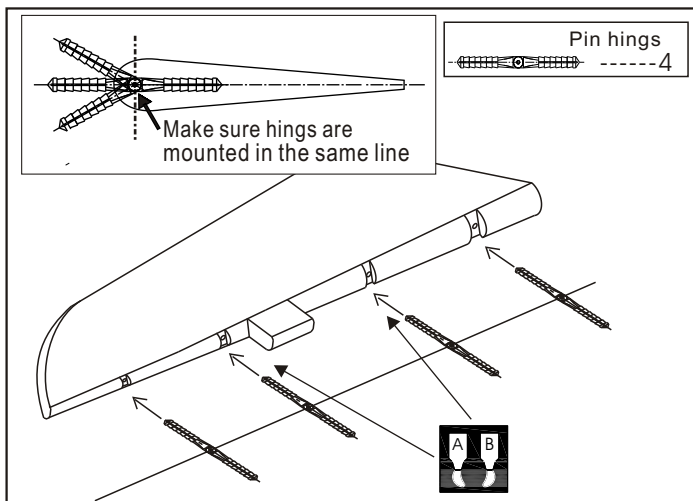

19 Rudder . Connect the linkage rod to the horn

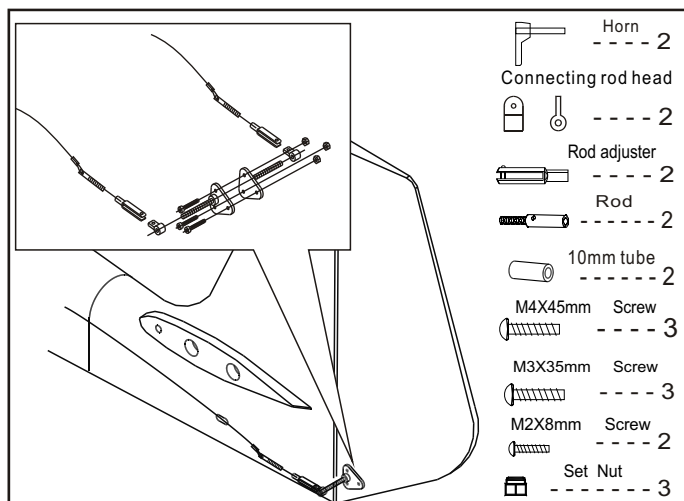

17 Install the rudder

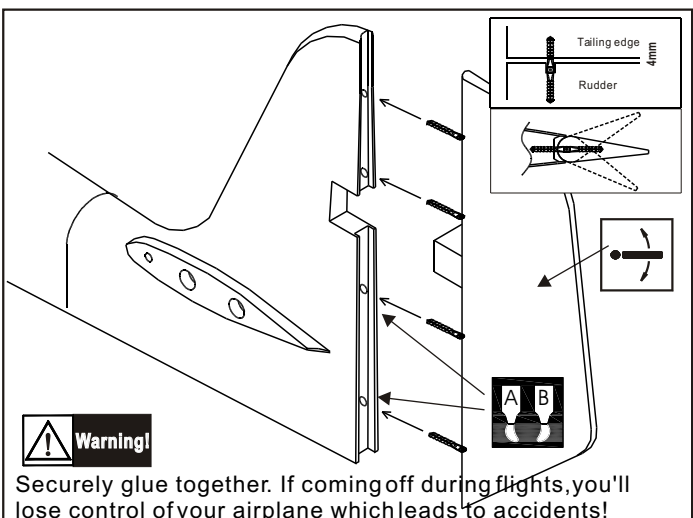

20 Mount the main wing on the fuselage

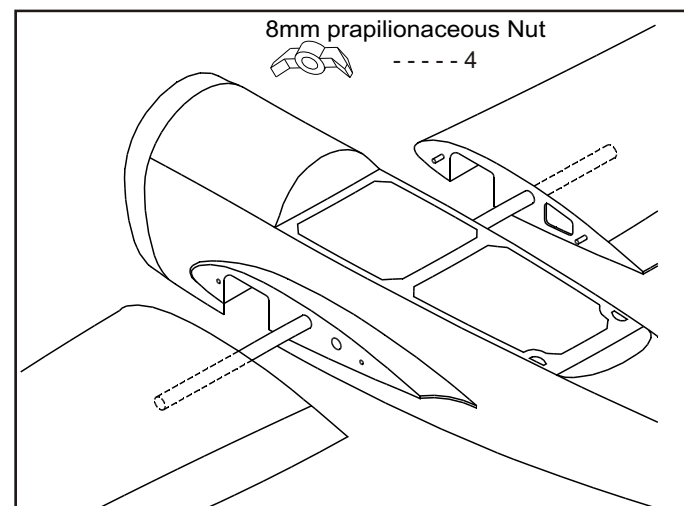



Accessory list for this page.

M4X10mm screw

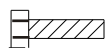
 ----- 2

Aluminium tube

 ----- 16

3mm Blind Nut

 ----- 12

M3X20mm screw

 ----- 12

23

Assembly of the engine

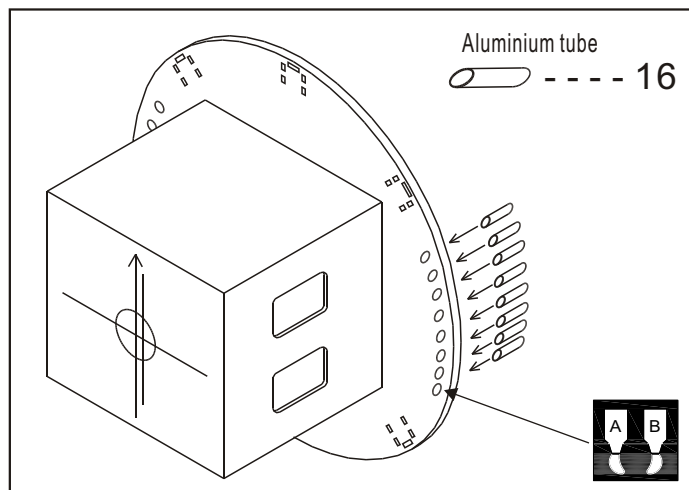

21

Epoxy the horizontal tail to fuselage

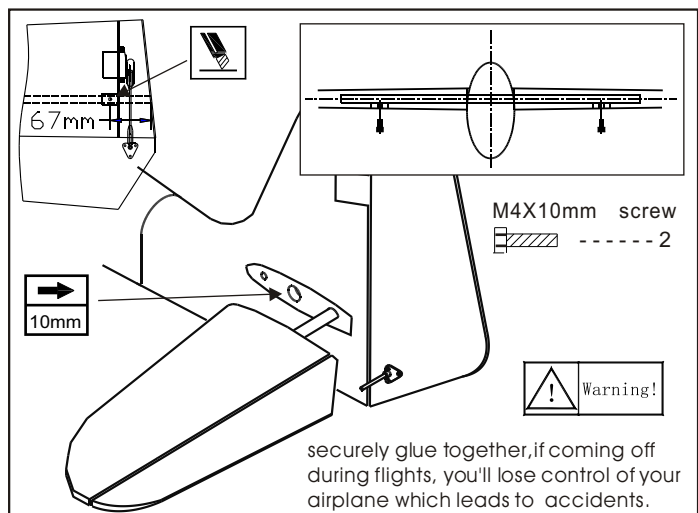

24

Assembly of the engine

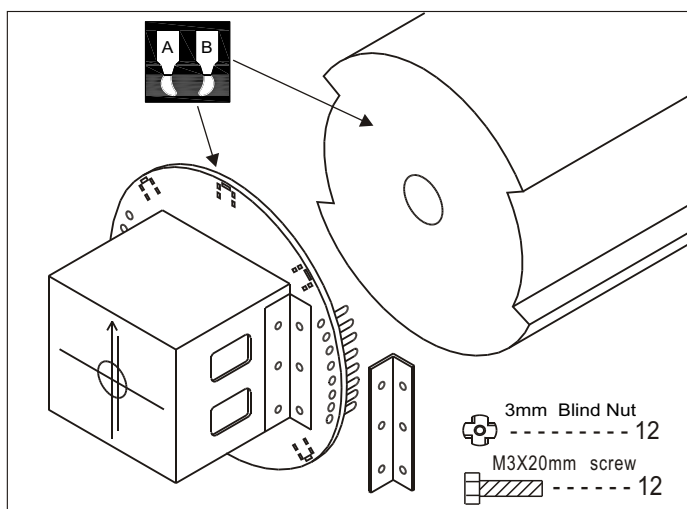

22

Assemble horizontal tail, vertical tail, tail gear separately

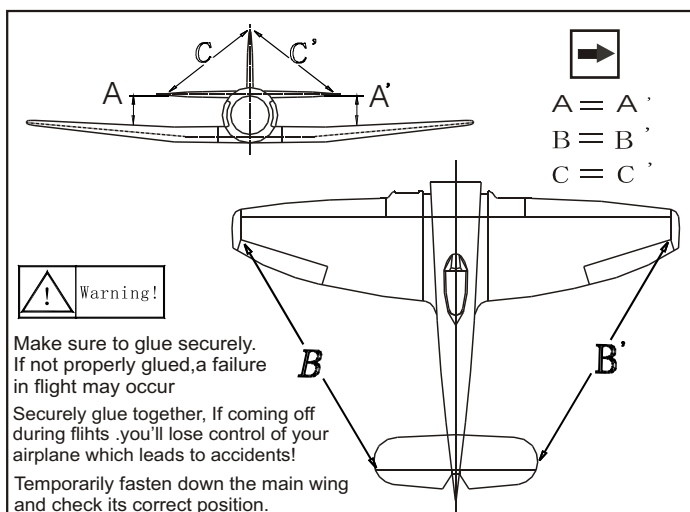

25

Assembly of the engine

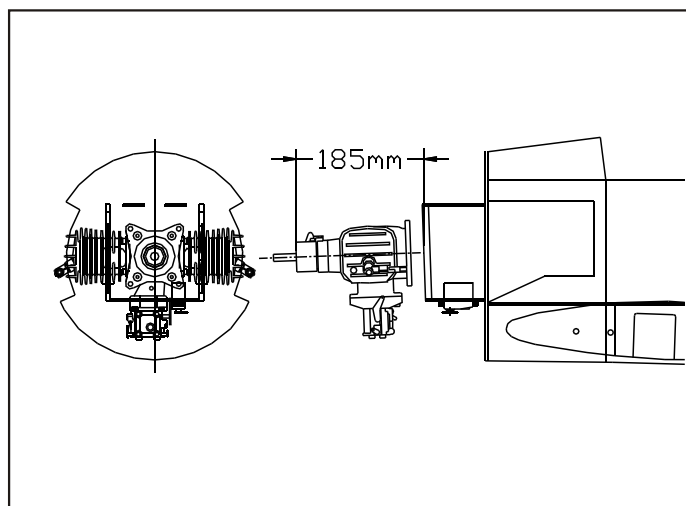



Accessory list for this page.

Rod adjuster

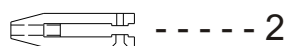

----- 2

2X8mm screw



----- 2

Aluminium tube



----- 2

Rod

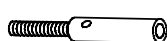

----- 2

M3X15mm screw

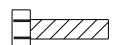

----- 5

3mm Washer



----- 6

28 Assemble the servos and switch in the fuselage

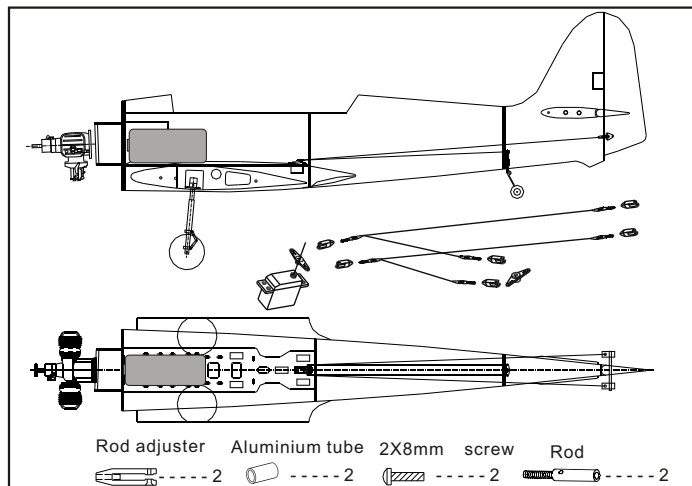

Rod adjuster Aluminium tube 2X8mm screw Rod

----- 2 ----- 2 ----- 2 ----- 2

26 Epoxy the wheel wells to the holes Trim the holes if necessary

After confirming the position(see front of fuel tank).
Insert and tighten the screw.

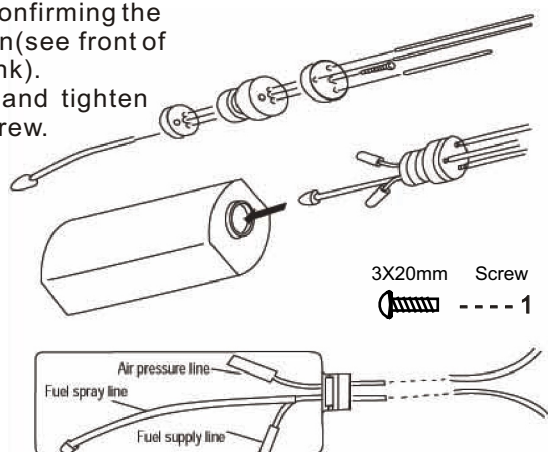

3X20mm Screw

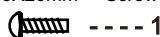

----- 1

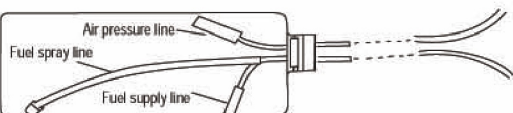

29 Trim the surplus shaded portion away from the canopy

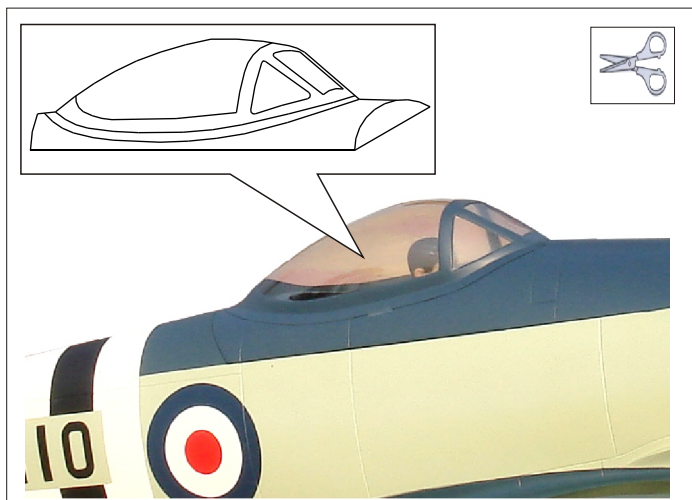

27 Assemble of the landing gear

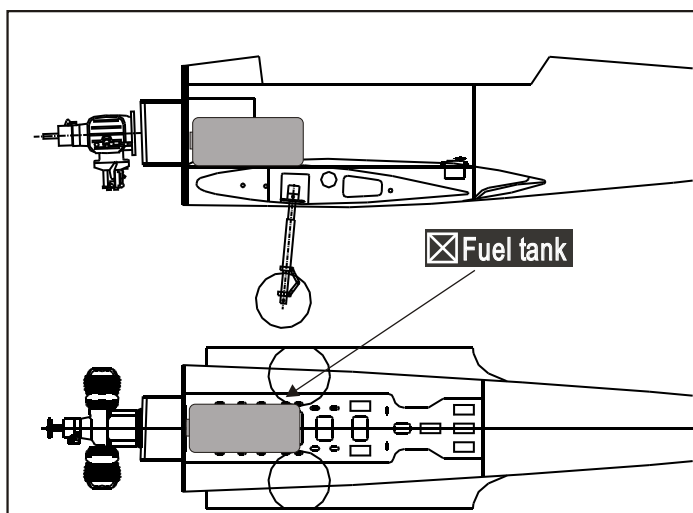

☒ Fuel tank

30 Install the cowling

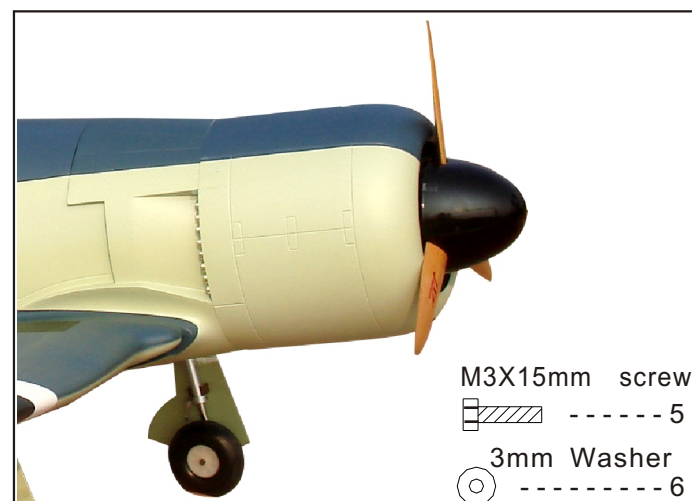

M3X15mm screw

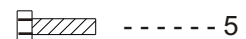

----- 5

3mm Washer



----- 6

31 Adjustment.

Adjust the travel of each control surface to the values in the diagrams.
These values fit general flight capabilities.
Readjust according to your needs and flight level.

AILERON

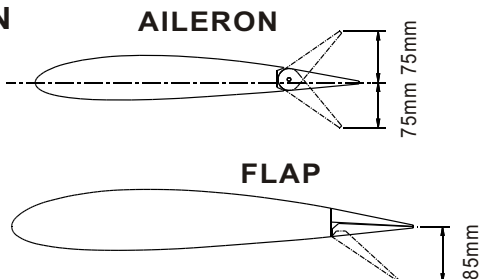

33 Adjustment.

Adjust the travel of each control surface to the values in the diagrams.
These values fit general flight capabilities.
Readjust according to your needs and flight level.

Side view

Top view

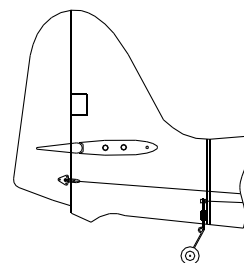
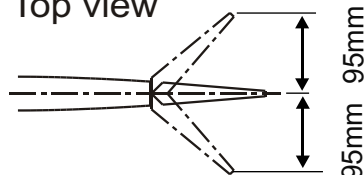

32 Adjustment.

Adjust the travel of each control surface to the values in the diagrams.
These values fit general flight capabilities.
Readjust according to your needs and flight level.

ELEVATOR

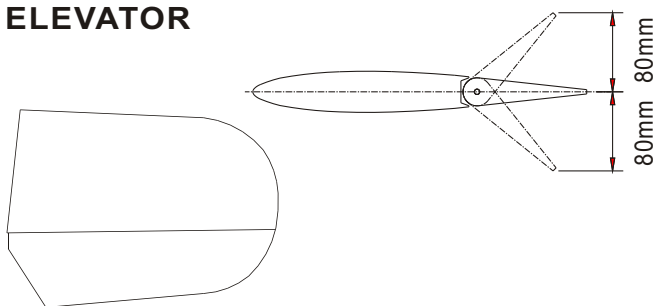

34 Centre of Gravity.

Never fly before checking the Cg's required position.
In order to obtain the CG specified, reposition the receiver and battery.

170-180mm

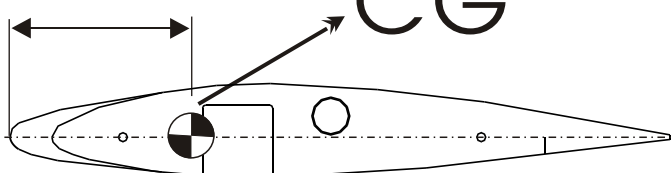

警告
Warning!

NEVER fly the model
without well balancing.

35 Centre of Gravity.

