

Before commencing assembly, please read these instructions thoroughly.

**ALMOST - READY - TO - FLY**



# Gee Bee V2



Warning!

## SAFETY PRECAUTIONS

**This radio control model is not a toy!**

## SPECIFICATION

- First-time builders should seek advice from people having building experience in order to assemble the model correctly and to produce its performance to full extent.
- Assemble this kit only in places out of childrens reach!
- Take enough safety precautions prior to operating this model. You are responsible for this models assembly and safe operation!
- Always keep this instruction manual ready at hand for quick reference, even after completing the assembly
- Could cause serious injury or even death.

Wing Span: 2800 mm (110 in)  
Wing Area: 151.5 dm<sup>2</sup> (2349 sq. in)  
Total Length: 2700 mm (106.3 in)  
Radio : 5-8 channels , 8-9 servos  
Engine : 150cc gas engine

# REQUIRED FOR OPERATION (Purchase separately)

- 1** A minimum 5-8channel radio for airplanes (with 8-9servos). And dry batteries.



**CAUTION:** Only use a minimum 5-8channel radio for airplanes! (No other radio may be used!)

A minimum 4 channel transmitter for airplanes.



12 AA-size Batteries

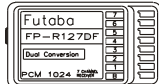

5 Channel receiver



remote control

For handing the radio properly, refer to its instruction manual.

- 2** Battery (need 2)  Switch (need 2) 

- 3** Servo(need 11) 

- 4** Engine and Muffler  
Model Airplane engine:150-250cc gas engine





Muffler

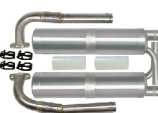

Muffler



- 5** Glue    
Epoxy Glue Instant glue

- 6** required for engine starting  **WARNING:** Normal gasoline cannot be used with glow engines.

Glow engine fuel only.

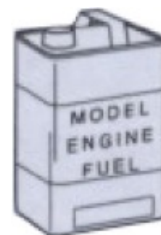

Fuel Pump



Plug Wrench

- 7** Silicone Tube  Fuel Filter 

- 8** Other equipment for enhancing airplane operation & performance

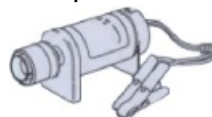

Engine Starter

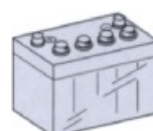

12V Battery (for starter)

- 9** Purchase a propeller that will match your engine   
26X10----28X10  
26X12----28X12

## TOOLS REQUIRED ( Purchase separately)

Sharp Hobby Knife



Phillips Screw Driver



Awl



Needle Nose Pliers

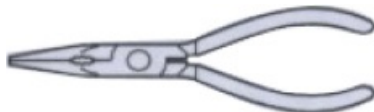

Wire Cutters



Scissors

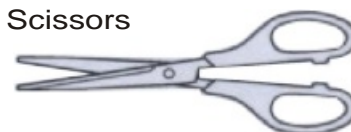

## BEFORE YOU BEGIN

1. Read through the manual before you begin ,so you will have an overall idea of what to do.
2. Check all parts .if you find any defective or missing parts .contact your local dealer.
3. Symbols used throughout this instruction manual,comprise.



Apply epoxy glue.



Drill holes with the specified Diameter(here:2mm)



Must be purchased separately!



Apply instant glue (CA glue,super glue).



Ensure smooth non-binding movement while assembling.



Pay close attention here!



Assemble left and right Sides the same way.



Cut off shaded portion.



Cut off excess.



Do not overlook this symbol.



## Accessory list for this page.

3X12mm Tp screw



----- 6

HORN



----- 6

3X30mm screw



----- 12



4X30 Screw

----- 4

2X8mm screw



----- 12

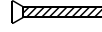

Rod adjuster

----- 6

2.5X85mm rod

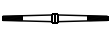

----- 6

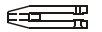

Connecting rod head

----- 12

Hinge

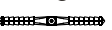

----- 24



----- 6

Hinge



----- 6

# 3

## Install the flap

L/R

Bottom view

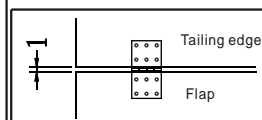
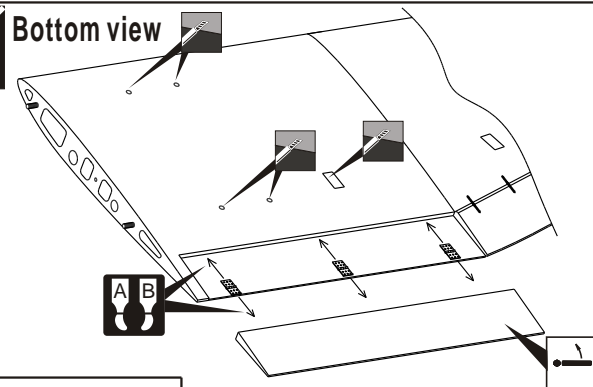

Hinge



----- 6

# 1

## Install the aileron

L/R

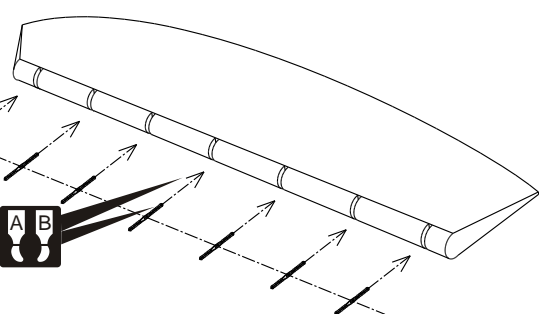

Hinge



----- 14

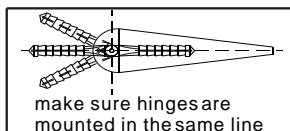

# 4

## Install the servos of aileron and flap

L/R

Bottom view

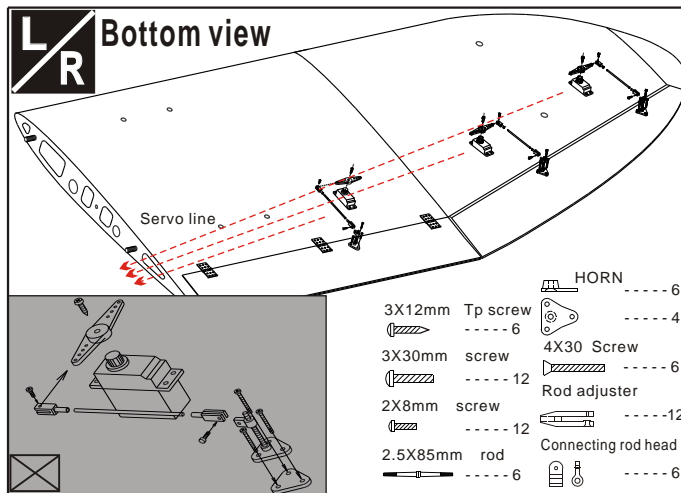

HORN



----- 6

3X12mm Tp screw



----- 6



4X30 Screw

----- 4

3X30mm screw



----- 12



Rod adjuster

----- 6

2X8mm screw



----- 12



Rod adjuster

----- 12

2.5X85mm rod



----- 6



Connecting rod head

----- 6

# 2

## Install the aileron

L/R

Bottom view

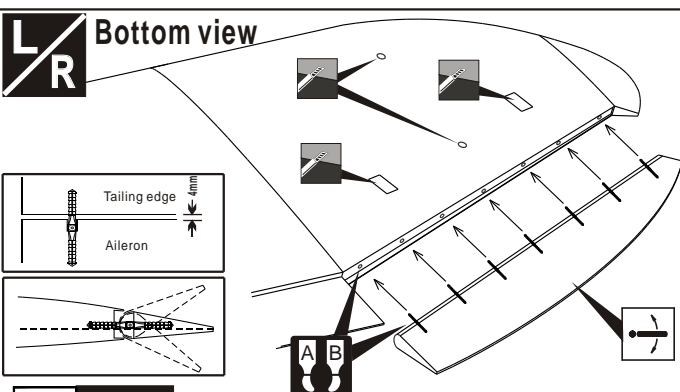

Tailing edge



----- 4mm

Aileron



----- 4mm



**Warning!**

Securely glue together. If coming off during flights, you'll lose control of your airplane which leads to accidents!

# 5

## Install the elevator

L/R

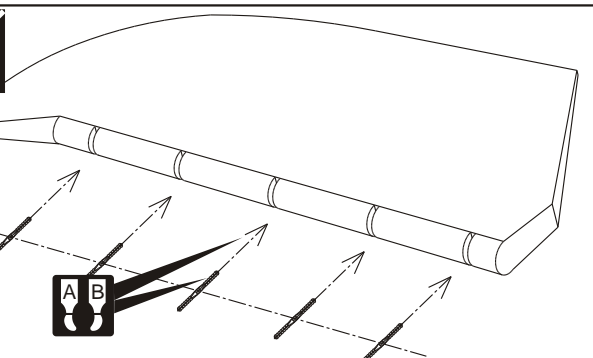

Hinge



----- 10

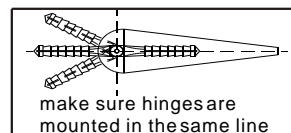



## Accessory list for this page.

HORN	----- 2	5X30mm screw	----- 4
4X30 Screw	----- 2	5mm Washer	----- 4
Rod adjuster	----- 4	Hinge	----- 4
Connecting rod head	----- 2	3X35mm screw	----- 6
2.5X85mm rod	----- 2	2X8mm screw	----- 4

## 8 Install the rudder

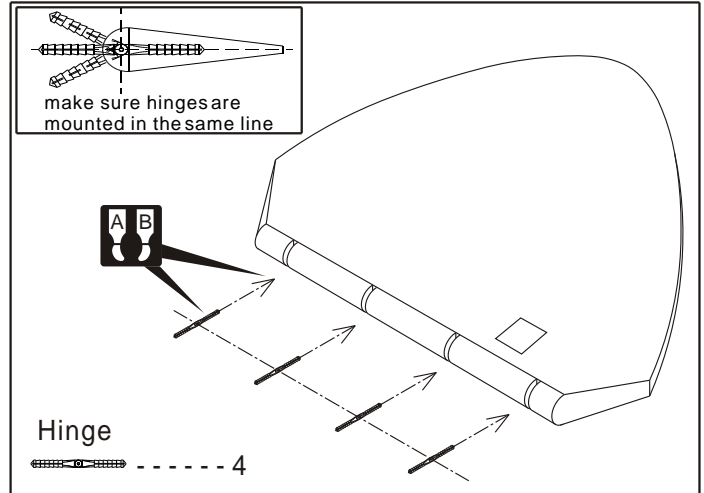

## 6 Install the elevator

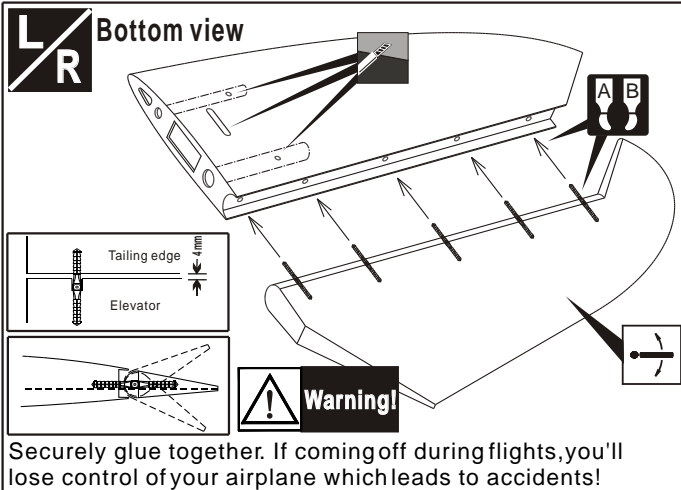

## 9 Install the rudder

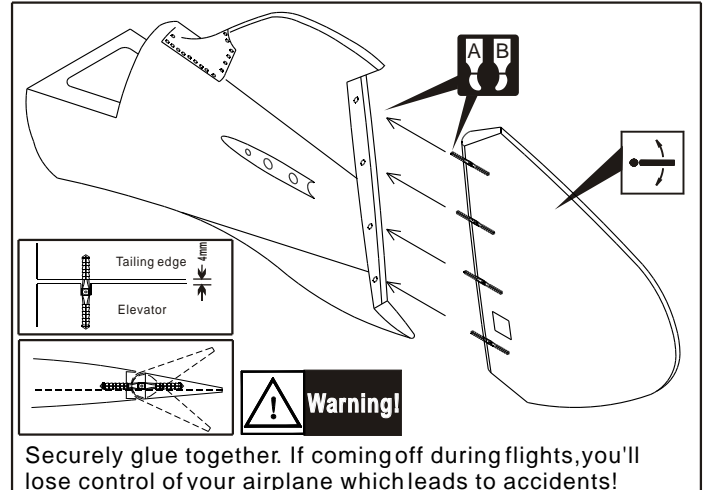

## 7 Install the elevator servos

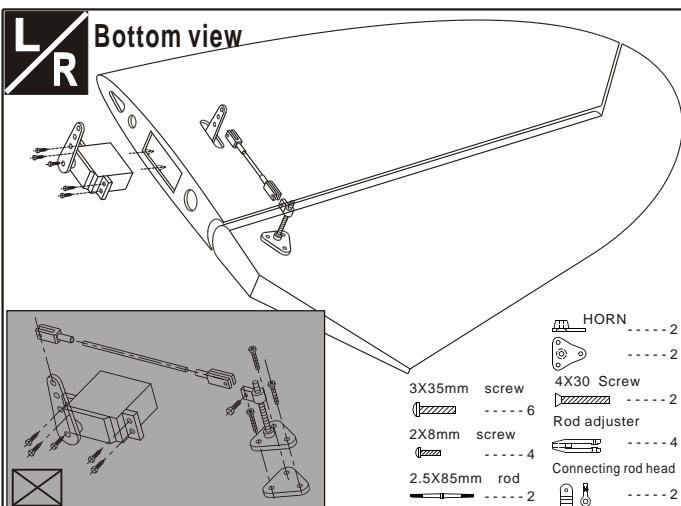

## 10 Install the fuselage

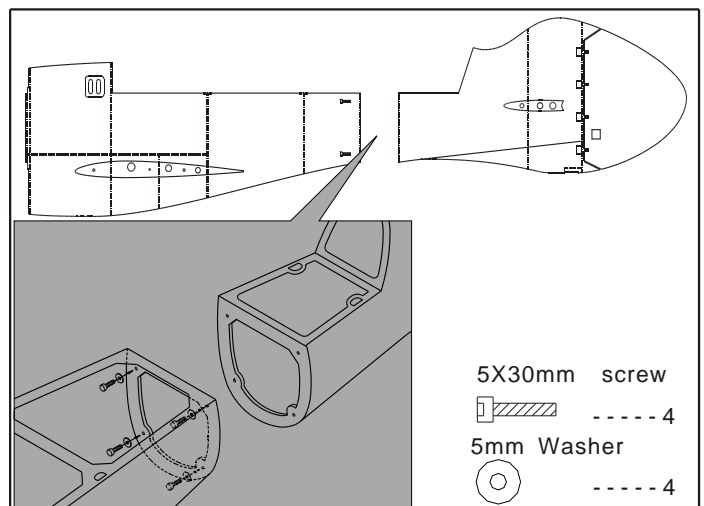





## Accessory list for this page.

<b>HORN</b>	1550mm Steel wire	3.2mm Rocker
4X30 Screw	Aluminium tube	3X3mm Screw
Rod adjuster	3X45mm screw	150mm spring
Connecting rod head	3mm nut	3X20Tp screw
2X8mm screw	3.2mm Nylon Collar	4mm Washer
Rod	3.2mm Collar	4X16mm screw
M6 Nut	M6X9 screw	

## 13 Install the rudder servos

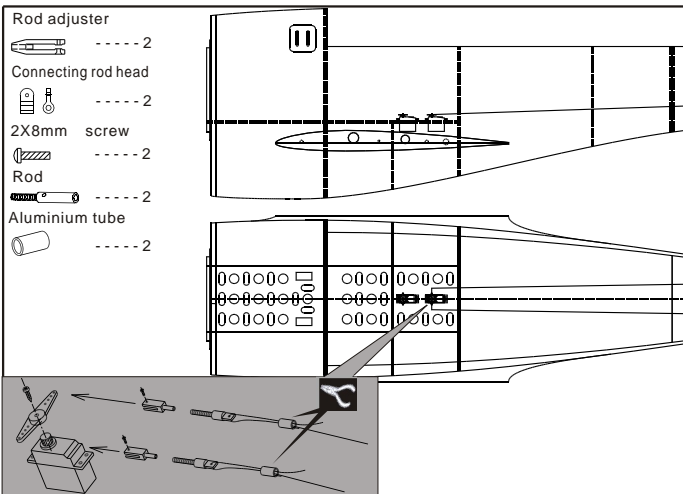

## 11 Install the elevator

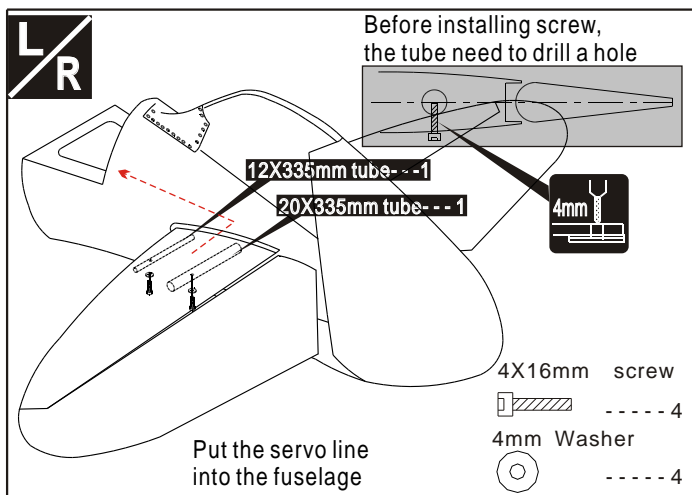

## 14 Install the tail wheel

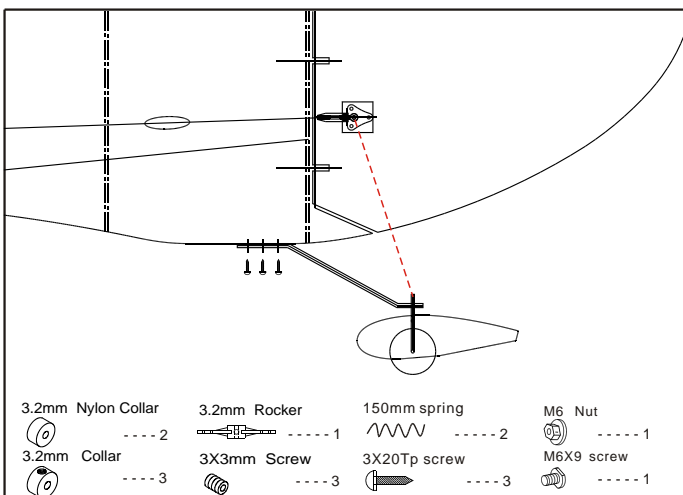

## 12 Install the rudder servos

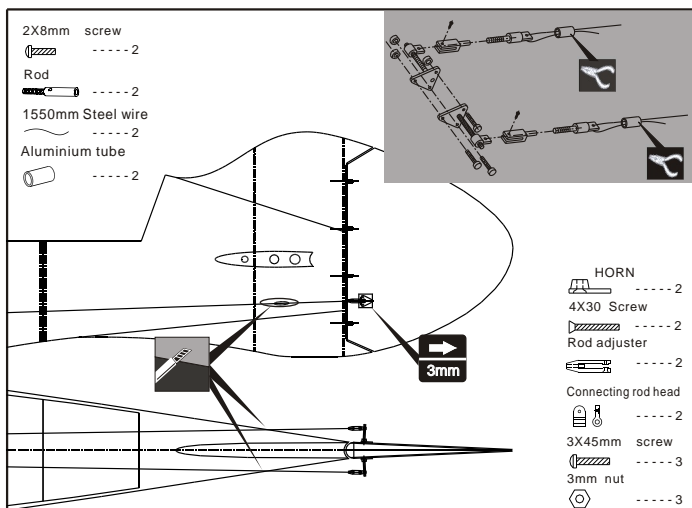



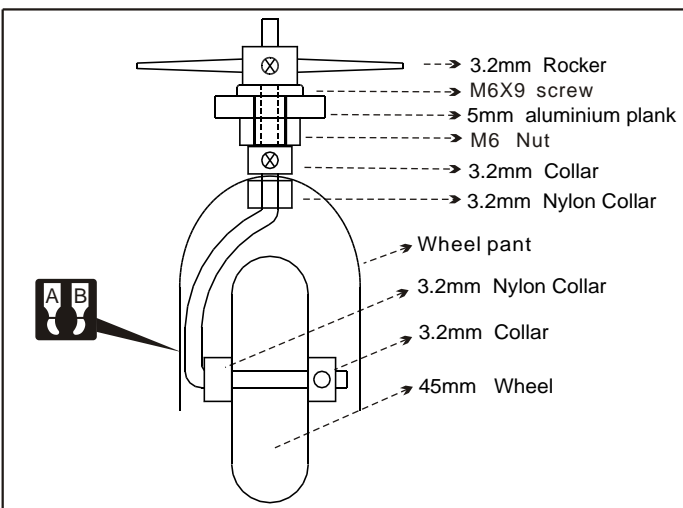





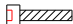

## 15 Install the tail wheel



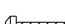

## Accessory list for this page.

5X85mm Axle	4X12mm screw
 ----- 2	 ----- 8
4X16mm screw	4mm Lock nut
 ----- 8	 ----- 8
5.2mm Collar	5X30mm screw
 ----- 6	 ----- 10
3X3mm screw	5mm Washer
 ----- 10	 ----- 10
3X20mm Tp screw	8mm nylon Nut
 ----- 18	 ----- 4
3mm Plywood	2.3X10 Tp screw
 ----- 28	 ----- 28

## 18 Install the main landing gear

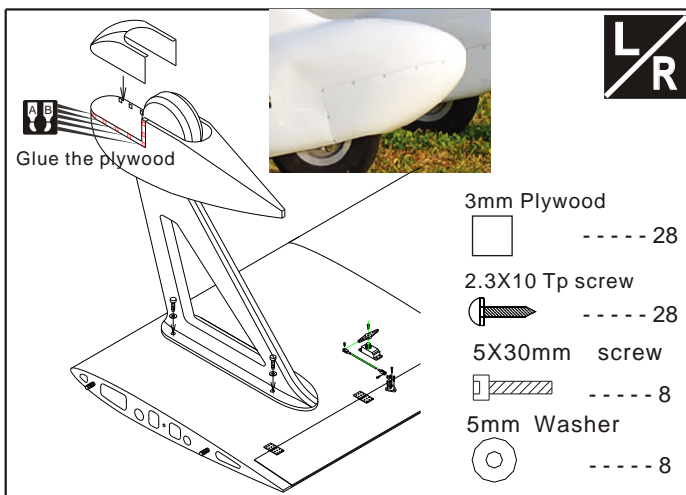

## 16 Install the main landing gear

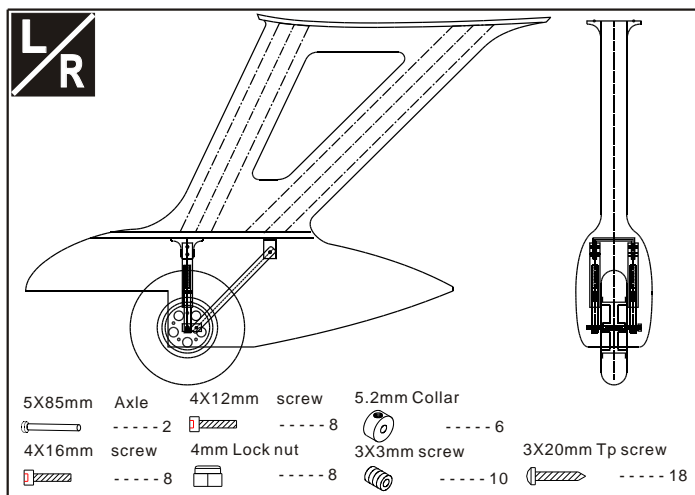

## 19 Main wing

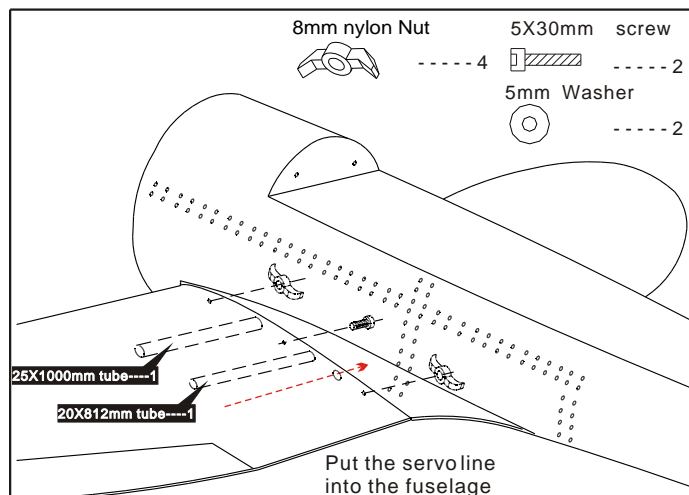

## 17 Install the main landing gear

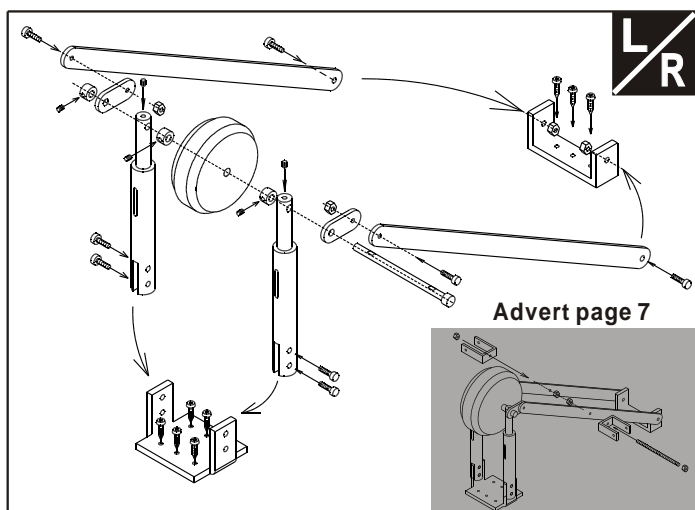

## 20 Horizontal/Vertical tail

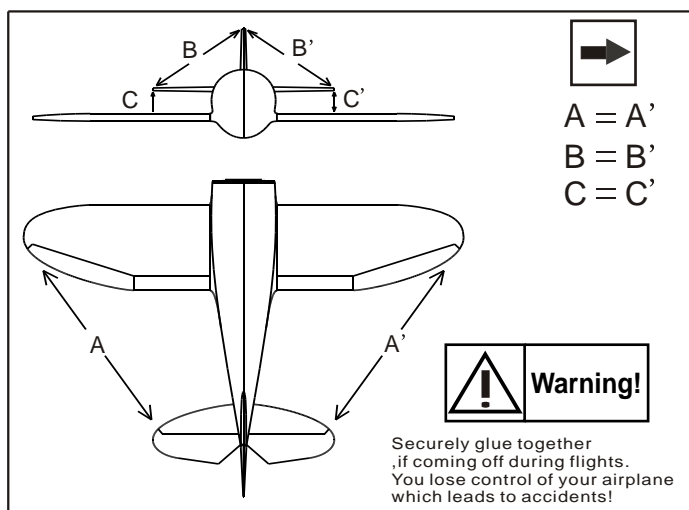



## Accessory list for this page.

### Rod adjuster

2X8mm screw ----- 16

2X8mm screw ----- 16

Rod ----- 16

1200mm Steel wire ----- 4

900mm Steel wire ----- 4

700mm Steel wire ----- 4

3X12mm Tp screw ----- 2

### Aluminium tube

----- 24

Linkage stopper

----- 8

3X40mm screw

----- 2

4X90mm screw

----- 2

4mm Lock nut

----- 8

3mm Lock nut

----- 2

# 23

## Strengthen the main wing and landing gear

### Top and bottom

Linkage stopper

----- 8

Aluminium tube

----- 8

900mm Steel wire

----- 4

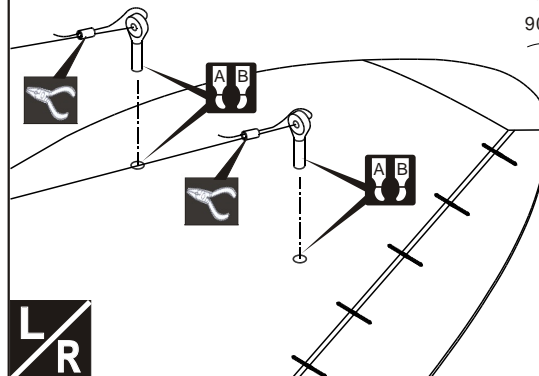

# 2

# 21

## Strengthen the main wing and landing gear

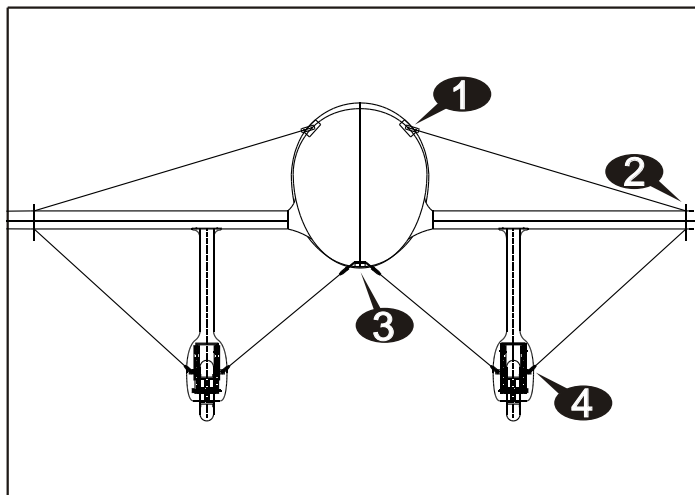

# 24

## Strengthen the main wing and landing gear

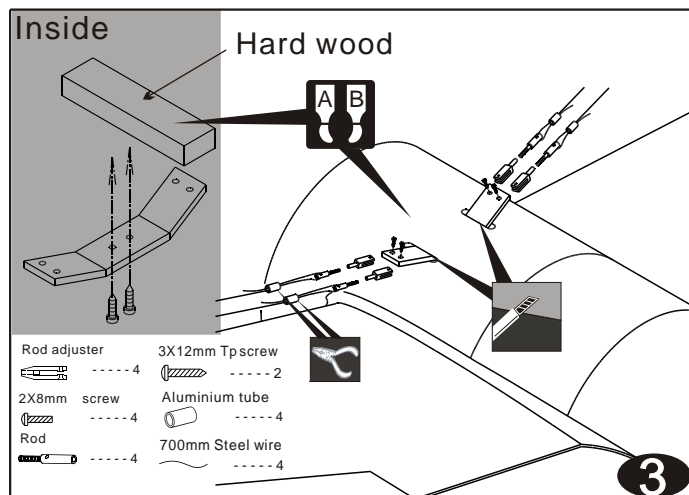

# 3

# 22

## Strengthen the main wing and landing gear

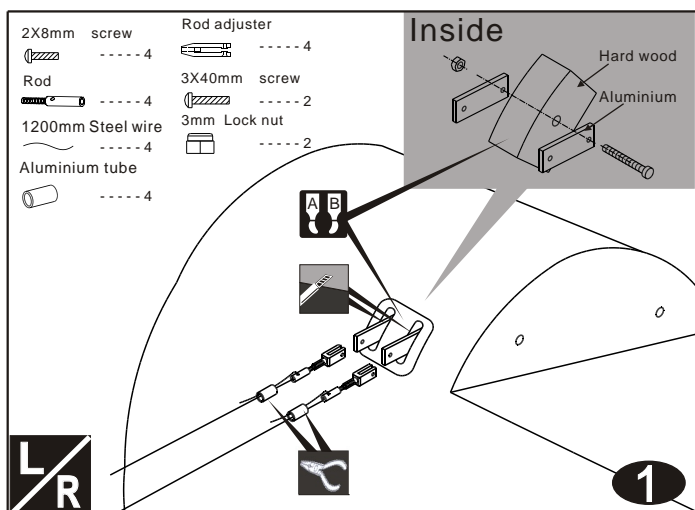

# 1

# 25

## Strengthen the main wing and landing gear

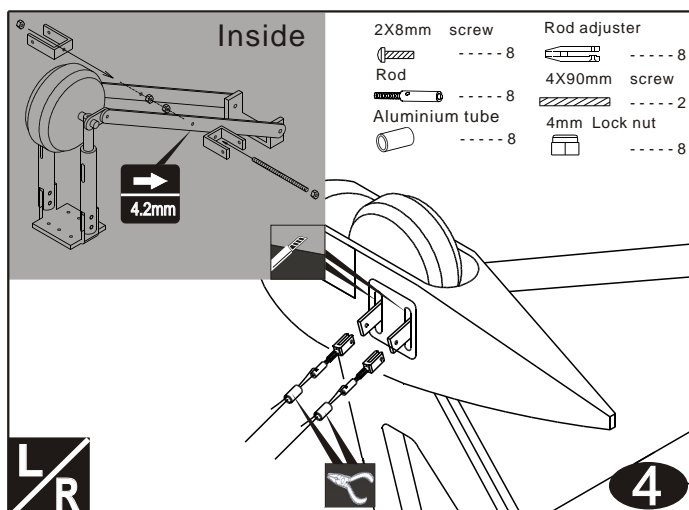

# 4



## Accessory list for this page.

3X20mm screw



-----14

3mm Lock nut



-----14

3mm Washer



-----28

Aluminium plank

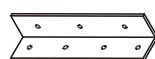

-----2

Linkage Stopper



-----1

2mm Nut



-----1

1.8X500mm Rod



-----1

3X3mm Screw



-----1

## 28 Install the engine(150-250CC)

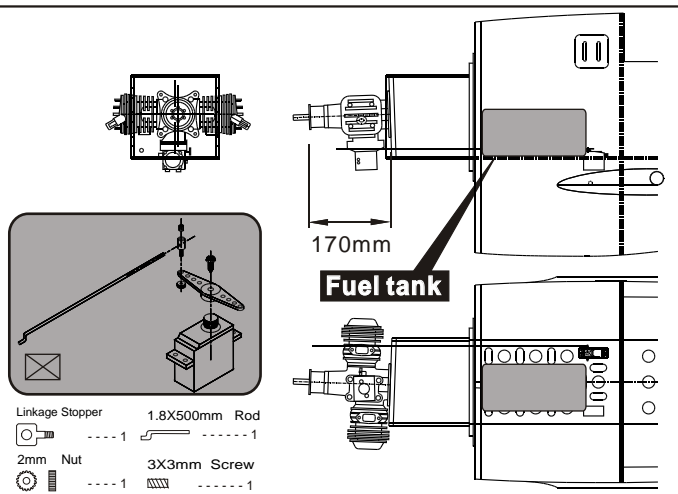

## 26 Strengthen the main wing and landing gear



## 29 Assembly of the fuel tank

After confirming the position(see front of fuel tank).  
Insert and tighten the screw

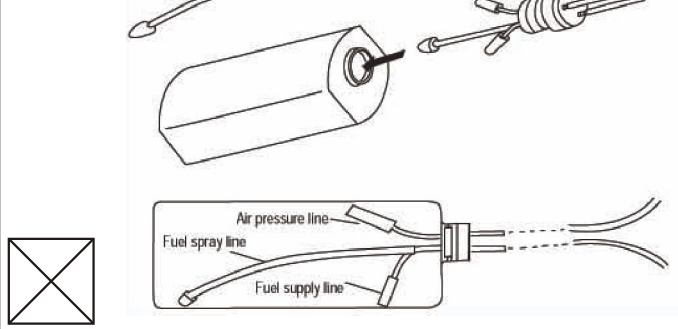

## 27 Install the engine mount

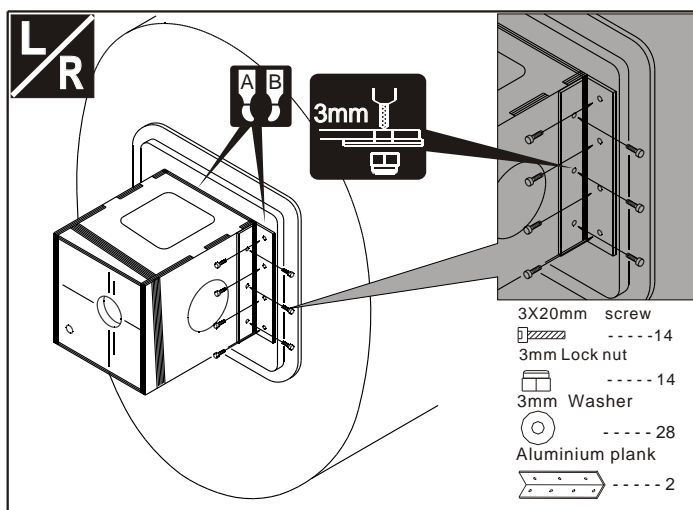

## 30 Radio Equipment

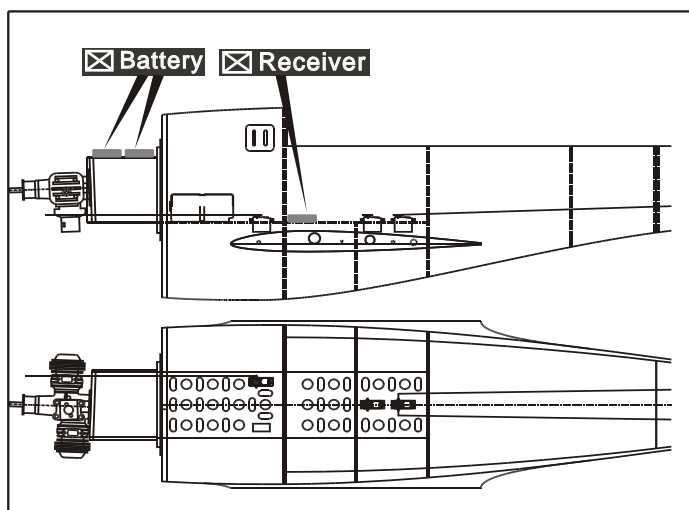





## Accessory list for this page.

3X30mm Screw

 ----- 6

3X12mm Screw

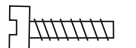
 ----- 7

3mm rubber band



 ----- 13

3mm washer

 ----- 13

## 33 Install the canopy

3X30mm Screw 3mm rubber band 3mm washer

 ----- 6  ----- 6  ----- 6



## 31 Install the cowling

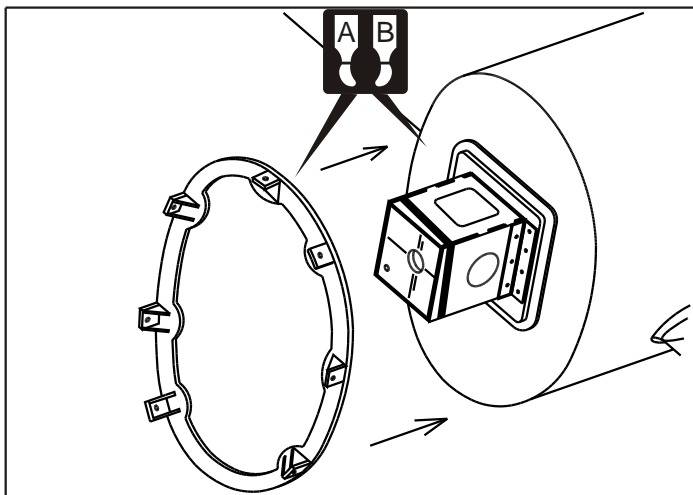

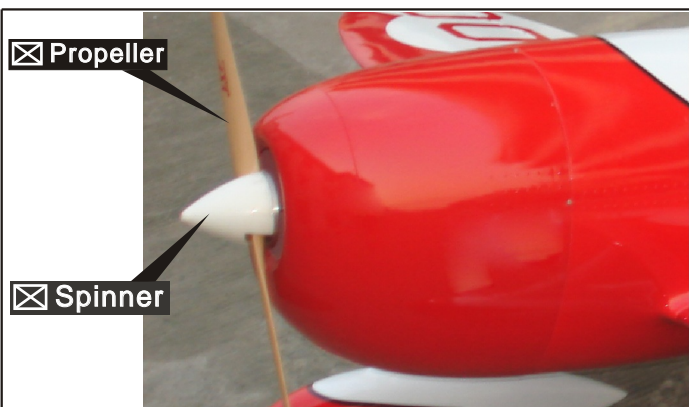

## 34

## 32 Install the cowling

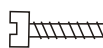

3X30mm Screw 3mm rubber band 3mm washer

 ----- 7  ----- 7  ----- 7

## 35

## 36 Adjustment.

Adjust the travel of each control surface to the values in the diagrams.  
These values fit general flight capabilities.  
Readjust according to your needs and flight level.

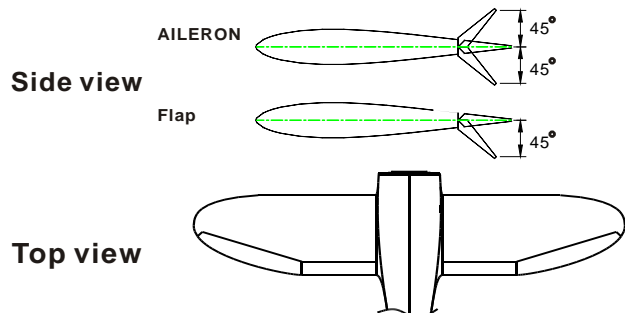

## 38 Adjustment

Adjust the travel of each control surface to the values in the diagrams.  
These values fit general flight capabilities.  
Readjust according to your needs and flight level.

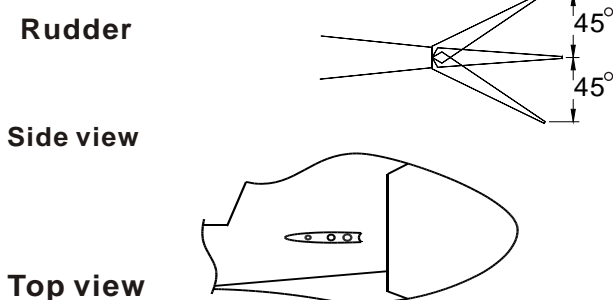

## 37 Adjustment.

Adjust the travel of each control surface to the values in the diagrams.  
These values fit general flight capabilities.  
Readjust according to your needs and flight level.

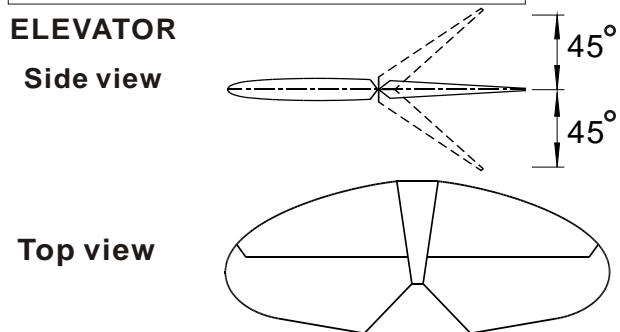

## 39 Adjustment.

Never fly before checking the Cg' s required position.  
In order to obtain the CG specified ,reposition the receiver and battery.

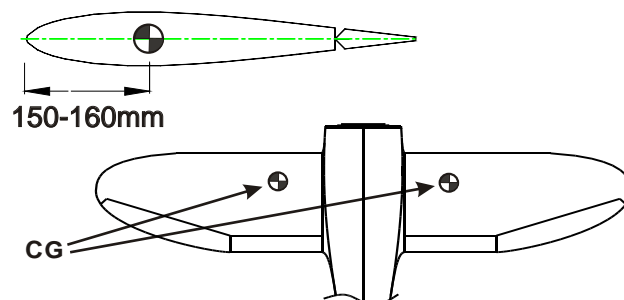

警告  
Warning!

**NEVER fly the model without well balancing.**